

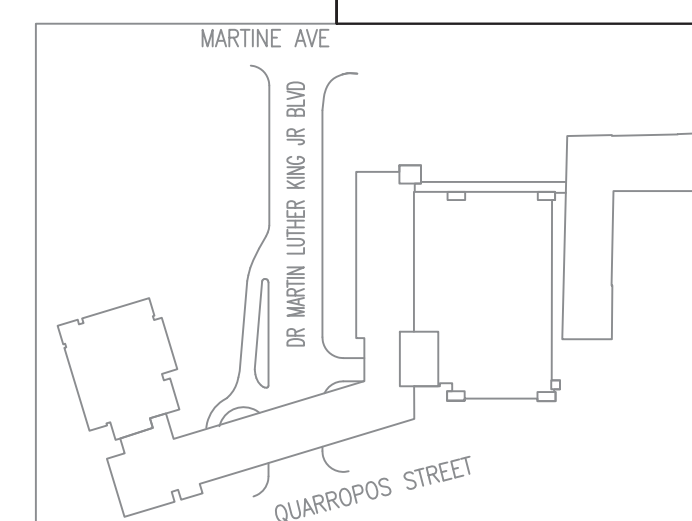

- ① FLOOR DRAINS PIPED BELOW. FOR EXACT LOCATION OF FLOOR DRAINS SEE STRUCTURAL DRAWINGS.
- ② FOR PIPING ON CEILING OF LEVEL B2, SEE DRAWING P-202
- ③ REMOVE AND REPLACE EXISTING TRENCH DRAIN, FOR PIPING SEE DRAWING P-202, TRENCH DRAIN TO BE INSTALLED IN (2) 15'-0" ASSEMBLIES
- ④ REMOVE AND REPLACE EXISTING FLOOR DRAIN, FOR PIPING SEE DRAWING P-202

		Lothrop Associates LLP Architects 333 Westchester Avenue White Plains, New York 10604 914-748-1115		ARCHITECTS
MICHAEL SCHULLER ATKINSON-ANDLAND AND ASSOCIATES 32 OLD SLIP, 0TH FLOOR NEW YORK, NEW YORK 10005 917-646-9950		FORENSIC INVESTIGATION		
JEFFRY R. CARLSON, P.E. S.E. 601 WEST GOLF ROAD, SECOND FLOOR MOUNT PROSPECT, ILLINOIS 60056 847-274-0985		STRUCTURAL ENGINEER		
MARK VELZY CBK ENGINEERING, PC 44-46 FOSTER ROAD HOPEWELL JUNCTION, NY 12533 914-509-8161 (O)		MEP ENGINEERS CBK REF NO. 18119		
	7/23/2020		RELEASE FOR BID	
	7/23/2020		FOR COMMISSIONER MEETING	
REVISION NUMBER	DATE	MADE BY	APP'D BY	REVISION
RECORD DRAWING CERTIFICATION				
<input type="checkbox"/> AS BUILT – CHANGES AS NOTED <input type="checkbox"/> AS BUILT – NO CHANGES				
CONTRACTOR NAME _____ SIGNATURE _____ TITLE _____ DATE _____			PROJECT COORDINATOR NAME _____ SIGNATURE _____ TITLE _____ DATE _____	
WESTCHESTER COUNTY, NEW YORK DEPARTMENT OF PUBLIC WORKS AND TRANSPORTATION DIVISION OF ENGINEERING				
PARKING GARAGE REHABILITATION – PHASE 1 MICHAELIAN OFFICE BUILDING 148 MARTE AVENUE, WHITE PLAINS, NEW YORK				
LOCATION PLAN LEVELS B1 AND I AND CONSTRUCTION PART PLAN				
		CONTRACT NUMBER 19--515	DATE 7-23-2020	SHEET NUMBER P-103(B1)
		SHEET NO. 78 OF 97		
		SCALE: AS NOTED 52-01-P-425-0		
		QPW FILE NO. 52-01-P-425-0		
				52-01-P-425-0



KEY PLAN