

N:\VADO\9999\SOE-9999A_SOE_2023.02.27_R4.DWG 02/27/23 04:49:37PM, Jimmede, LAYOUT SOE-3

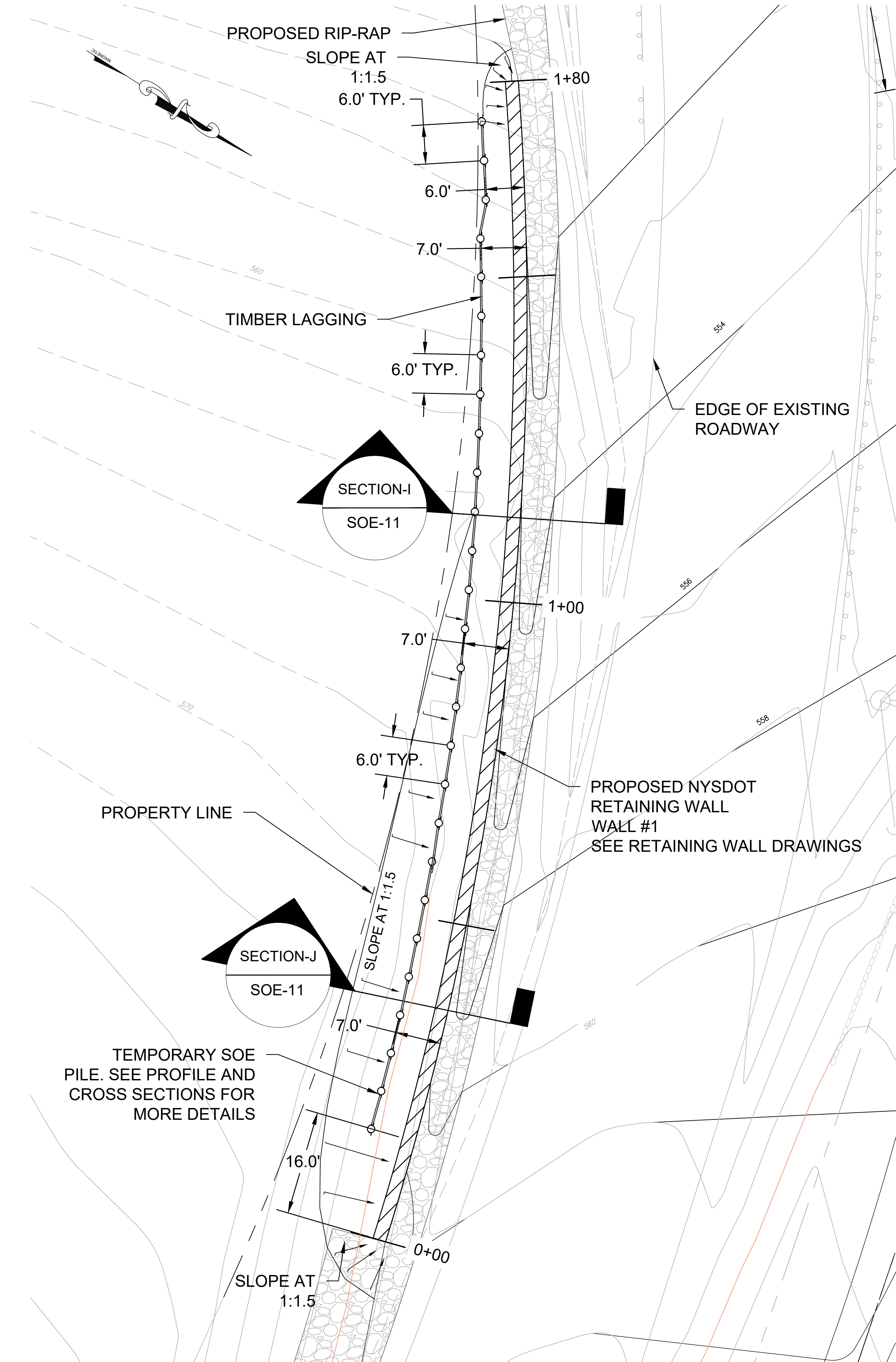

SOE WALL 1 - PLAN
SCALE: 1"=10'

© SESI CONSULTING ENGINEERS 2023
This drawing and all information contained here on is proprietary
information of SESI CONSULTING ENGINEERS and may not be copied or
reproduced, either in whole or in part, by any method, without written
permission of SESI CONSULTING ENGINEERS.

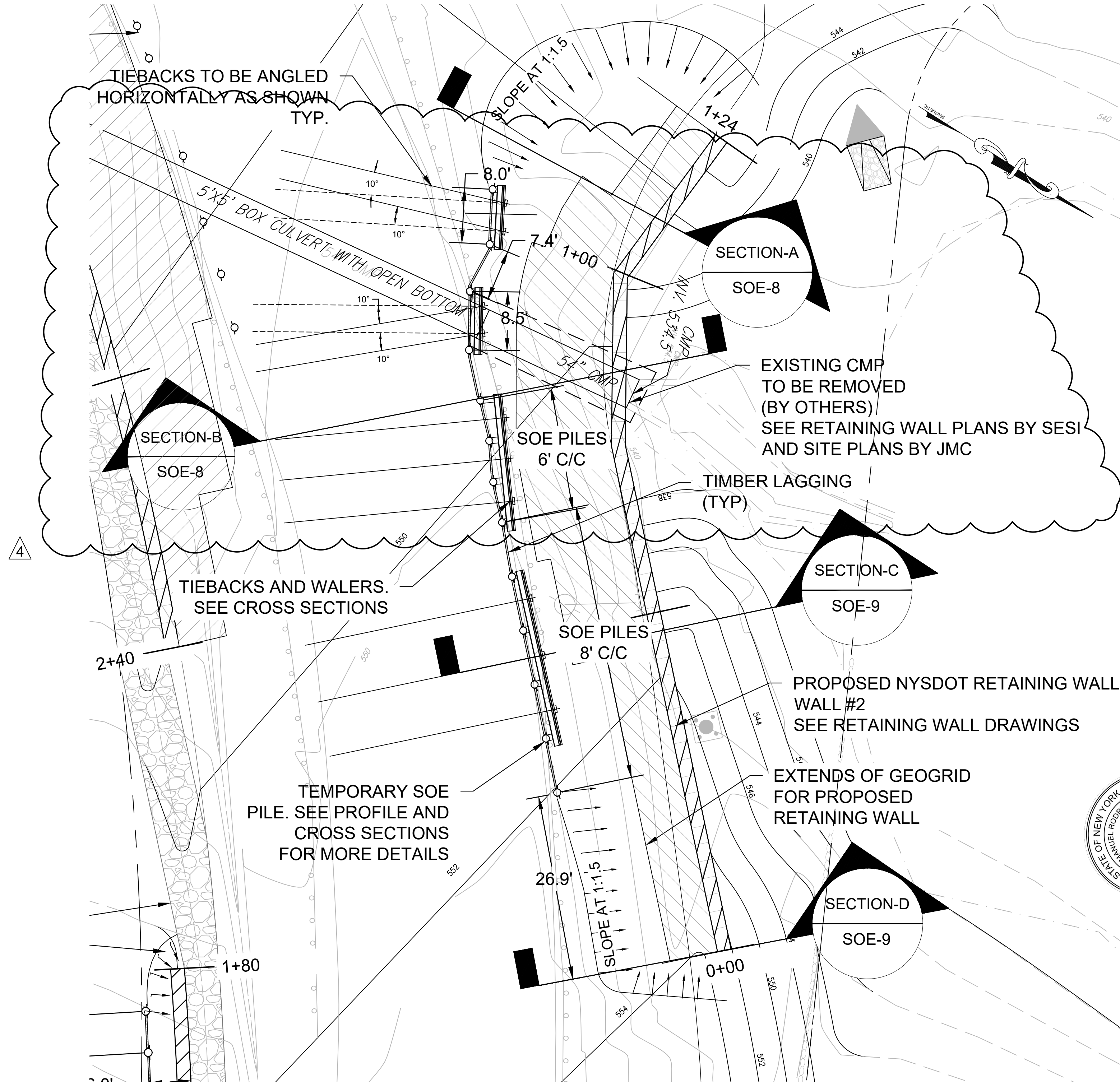

SOE WALL 2 - PLAN
SCALE: 1"=10'



PROPOSED NORTHEAST INTERSTATE
LOGISTICS CENTER
NY 312 & PUGSLEY ROAD
TOWN OF SOUTHEAST, NEW YORK

job no. 9999
drawing no.

SOE-3

WALL 1 & WALL 2 SOE - PLAN VIEW

JOSE M. RODRIGUEZ, P.E.
PROFESSIONAL ENGINEER
N.Y. LIC. NO. 095960

SESI CONSULTING
ENGINEERS

GEOTECHNICAL | ENVIRONMENTAL | SITE CIVIL

959 route 46e, 3rd floor, parsippany, nj 07054 ph: 973.808.9050

dwg by: aas
chk by: NG
scale: AS NOTED
date: 08/04/2021

rev	date	description	by
4	2/27/23	PER CHANGES TO CULVERT	NG
3	3/23/22	DOT COMMENTS	NG
2	1/17/21	DOT COMMENTS	NG
1	9/7/21	REVISED DOT SUBMISSION	NG
	8/4/21	DOT SUBMISSION	NG