

N:\VADO\9999\SOE-4.dwg 09/27/23 04:49:48PM, Jimmick, LAYOUT SOE-4

© SESI CONSULTING ENGINEERS 2023
This drawing and all information contained here on is proprietary
information of SESI CONSULTING ENGINEERS and may not be copied or
reproduced, either in whole or in part, by any method, without written
permission of SESI CONSULTING ENGINEERS.

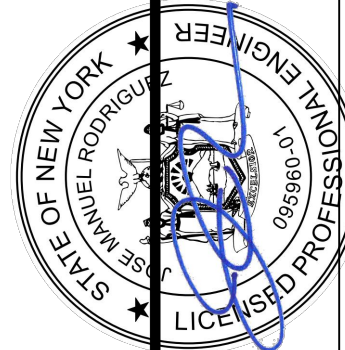
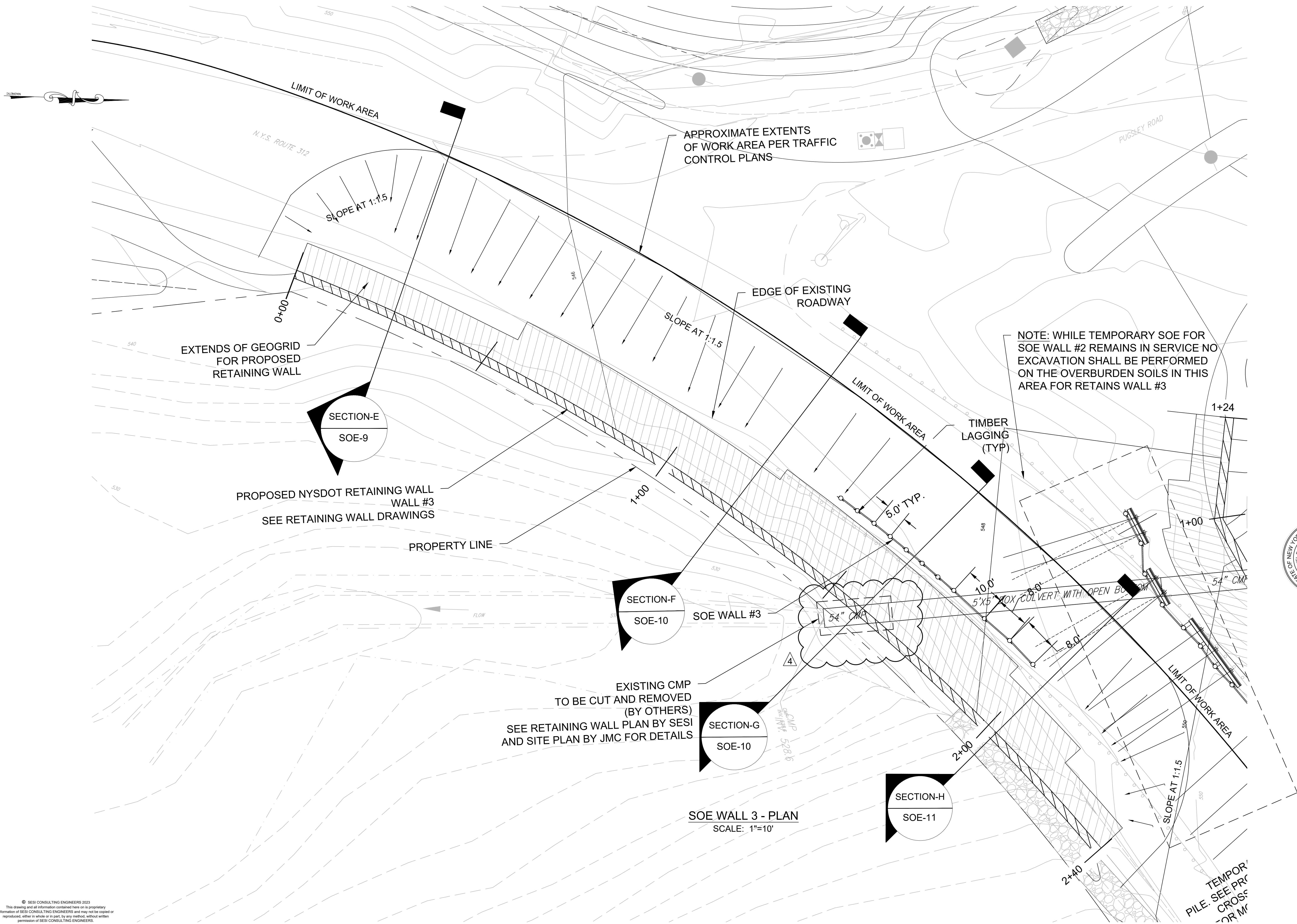

PROPOSED NORTHEAST INTERSTATE
LOGISTICS CENTER
NY 312 & PUGSLEY ROAD
TOWN OF SOUTHEAST, NEW YORK

job no. 9999
drawing no.

SOE-4

SESI CONSULTING ENGINEERS
GEOTECHNICAL | ENVIRONMENTAL | SITE CIVIL
959 route 46e, 3rd floor, Parsippany, nj 07054 ph: 973.808.9050

JOSE M. RODRIGUEZ, P.E.
PROFESSIONAL ENGINEER
N.Y. LIC. NO. 095960

SOE WALL 3 - PLAN VIEW

dwg by: aas
chk by: NG
scale: AS NOTED
date: 08/04/2021

rev	date	description	by
4	2/27/23	PER CHANGES TO CULVERT	NG
3	3/23/22	DOT COMMENTS	NG
2	11/17/21	DOT COMMENTS	NG
1	9/7/21	REVISED DOT SUBMISSION	NG
	8/4/21	DOT SUBMISSION	NG