

N:\VADO\9999\WALL\9999.DOTXW, 2023.05.04, RE.DWG, 05/09/23, 01:33:10PM, mcdona, LAYOUT.W-1

© SESI CONSULTING ENGINEERS 2023
This drawing and all information contained here on is proprietary
information of SESI CONSULTING ENGINEERS and may not be copied or
reproduced, either in whole or in part, by any method, without written
permission of SESI CONSULTING ENGINEERS.

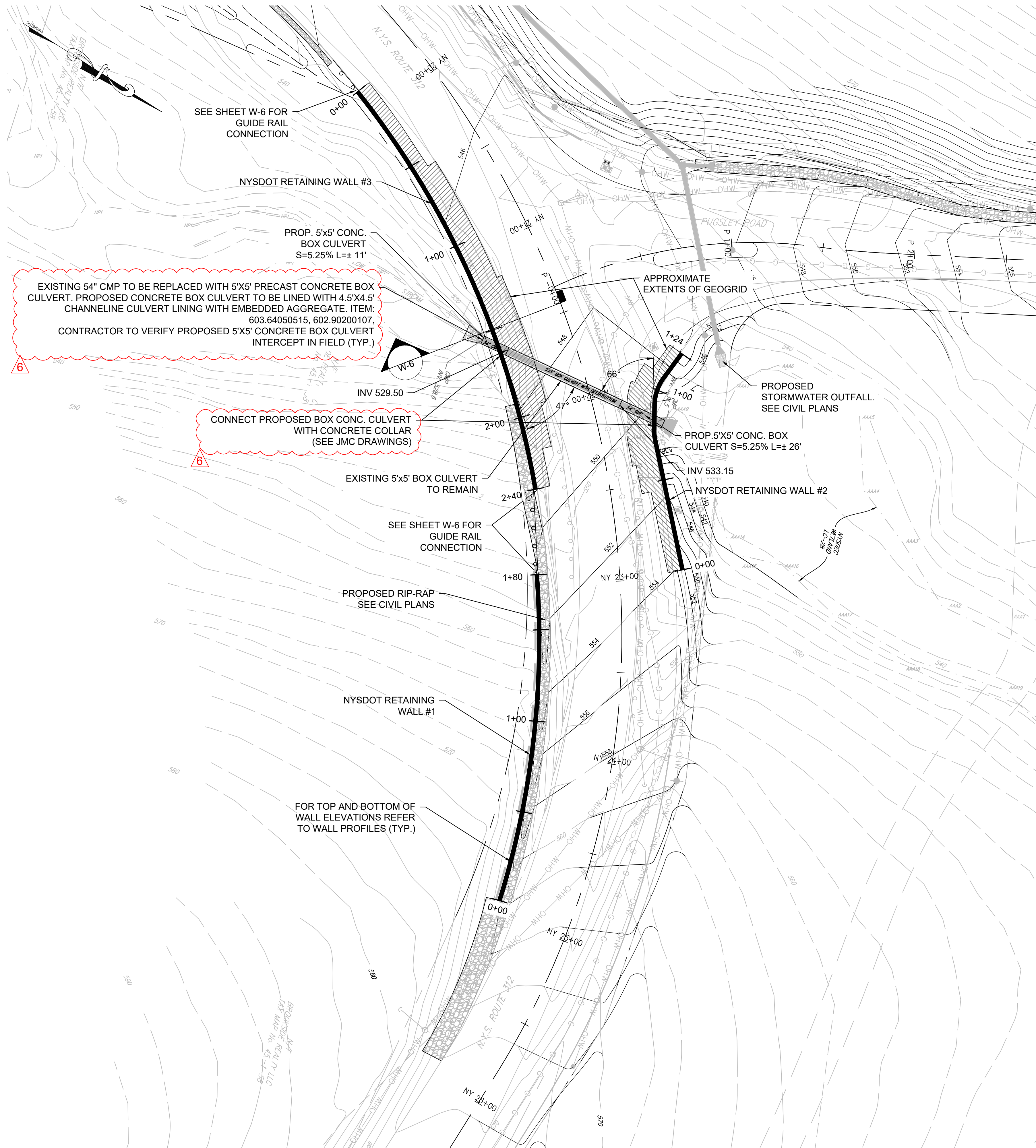

OVERALL RETAINING WALL PLAN

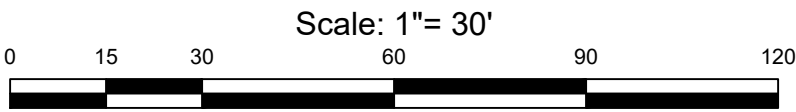

PROPOSED NORTHEAST INTERSTATE LOGISTICS CENTER NY 312 & PUGSLEY ROAD TOWN OF SOUTHEAST, NEW YORK		 MICHAEL W. ST. PIERRE, P.E. PROFESSIONAL ENGINEER N.Y. LIC. NO. 080271		SES I CONSULTING ENGINEERS GEOTECHNICAL ENVIRONMENTAL SITE CIVIL 959 route 46e, 3rd floor, parsippany, nj 07054 ph- 973.808.9050		dwg by: YY chk by: RR scale: AS NOTED date: 08/04/2021		rev date description	
drawing title: NYSDOT RETAINING WALL PLAN		job no. 9999		drawing no. W-1		1 of 7			