

PLUMBING FIXTURE CONNECTION SCHEDULE							REMARKS
TAG NO.	DESCRIPTION	COLD WATER	HOT WATER	WASTE	SANITARY	VENT	
WC-A	WATER CLOSET ADA	1"	-	-	3"	2"	FLOOR MOUNTED TWO PIECE TANK TYPE, MANUAL FLUSH VALVE, HEAVY DUTY SEAT - OPEN FRONT, LESS COVER
LV-A	LAVATORY ADA	1/2"	1/2"	1-1/2"	-	1-1/2"	WALL MOUNT CHINA LAV, MANUAL FAUCET, GRID STRAINER, MANUAL DECK MOUNTED FAUCET, ADA WRISTBLADES, ADA COVERS
SK-A	SINK	1/2"	1/2"	1-1/2"	-	1-1/2"	DROP IN, S/S DOUBLE BOWL, KITCHEN SINK SINGLE LEVER STYLE FAUCET, 2.0 AERATOR

PUMP SCHEDULE										
NO.	LOCATION	SERVICE	GPM	HEAD FT WATER	MOTOR				TYPE	DESIGN MAKE
					HP	VOLTAGE	PHASE	RPM		
PP-1	ROOM 29	SEWAGE	40	85	2	208-230	1	3250	SEWAGE	LIBERTY 1100/LE102A DUPLEX

PLUMBING SYMBOL LIST	
SYMBOL	DESCRIPTION
NTS	NOT TO SCALE
(E)	EXISTING
AFF	ABOVE FINISHED FLOOR
BFF	BELOW FINISHED FLOOR
VTR	VENT THRU ROOF
GC	GENERAL CONTRACTOR
MC	MECHANICAL CONTRACTOR
PC	PLUMBING CONTRACTOR
EC	ELECTRICAL CONTRACTOR
(E)	EXISTING PIPING
●	COLD WATER PIPING (CW)
●●	HOT WATER PIPING (HW)
SAN	SANITARY SEWER PIPING
IW	INDIRECT WASTE PIPING (IW)
---	VENT PIPING
---	ELBOW DOWN
---	45° OFFSET
---	ELBOW UP
---	BOTTOM/TEE CONNECTION
---	TOP TEE CONNECTION
---	"P" TRAP
---	PIPE CONTINUATION
---	CAP OR PLUG
---	DECK PLATE CLEANOUT (DPCO)
---	WALL PLATE CLEANOUT (WPCO)
---	CLEANOUT (CO)
●	SHUT OFF VALVE

PLUMBING GENERAL NOTES	
#	Note
A	THESE NOTES ARE APPLICABLE TO THE FULL SET OF CONTRACT DRAWINGS
B	EXISTING CONDITIONS ARE TAKEN FROM FIELD OBSERVATIONS AND PRIOR CONSTRUCTION DOCUMENTS WHEN AVAILABLE. THE LOCATIONS SHOWN MUST BE CONSIDERED APPROXIMATE. OTHER SUCH WORK MAY EXIST, HOWEVER LOCATION AND SIZE ARE NOT PRESENTLY KNOWN.
C	WHEN EXISTING CONSTRUCTION IS DAMAGED BY WORK BY THIS CONTRACTOR, REPAIR AND/OR REPLACE WITH SIMILAR MATERIALS AS MUCH AS POSSIBLE, SUBJECT TO ARCHITECT'S APPROVAL.
D	DISPOSE OF ALL DEMOLITION AND/OR OTHER WASTE MATERIALS CAUSE BY WORK OF THIS CONTRACTOR. LEGALLY DISPOSE ALL MATERIALS TO A LOCATION OFF SITE.
E	COORDINATE AND SCHEDULE WORK AND SHUTDOWNS WITH THE OWNER AND OTHER TRADES PRIOR TO DEMOLITION.
F	ALL EXISTING PIPING TO REMAIN SHALL BE RECONNECTED TO ACTIVE SERVICE PIPING.
G	ALL PIPING TO BE REMOVED SHALL BE REMOVED BACK TO ACTIVE SERVICE PIPING AND CAPPED. VALVE AND CAP ALL WATER PIPING. REMOVE ALL INACTIVE PIPING UNLESS OTHER WISE NOTED.
H	ALL PIPING TO BE REMOVED AND IN A WALL TO REMAIN MAY BE ABANDONED IN PLACE UNLESS NOTED.
I	PATCH HOLES IN EXISTING CONSTRUCTION LEFT BY THE REMOVAL OF PIPING OR EQUIPMENT WITH MATERIALS TO MATCH EXISTING CONSTRUCTION. MAINTAIN FIRE SMOKE RATING.
J	DEMOLITION SHALL INCLUDE, BUT NOT LIMITED TO: PIPING, VALVES, FIXTURES, EQUIPMENT, HANGERS, SUPPORTS AND INSULATION, EXCEPT ASBESTOS.
K	REMOVE EXISTING CONSTRUCTION IN THE WAY OF NEW WORK. PROTECT BUILDINGS AND FURNISHINGS FROM DAMAGE.
L	WHERE NEW WORK IS TO BE INSTALLED ABOVE AN EXISTING CEILING, PROVIDE FOR THE REMOVAL OF THE CEILING. UPON COMPLETION OF WORK, REPAIR ALL DAMAGED CEILING SURFACES, REPLACE ALL DAMAGED TILES.
M	SLEEVE AND SEAL ALL WALL AND FLOOR PENETRATIONS. PROVIDE FIRESTOPPING FOR ALL PENETRATIONS.
N	MAINTAIN SERVICE CLEARANCES OF ALL EQUIPMENT. ADVISE OTHER TRADES OF REQUIRED CLEARANCES.
O	PROVIDED FOR THE DRAINAGE AND REFILLING OF PIPING SYSTEMS, INCLUDING AIR REMOVAL, RESETTNG OF FLUSH VALVES, FLUSHING SYSTEMS OF DIRT AND SCALE CAUSED BY SHUTDOWNS AND STARTUPS.
P	REFER TO EQUIPMENT/FIXTURE SCHEDULE FOR FINAL CONNECTION SIZES.
Q	MINIMUM SIZE OF WASTE PIPING BELOW SLAB SHALL BE 3" EXCEPT PIPING SERVING FLOOR DRAINS SHALL BE 4". MINIMUM SIZE OF VENT PIPING BELOW SLAB SHALL BE 2" UNLESS NOTED OTHERWISE.

#### P101 DRAWING NOTES

- 2" PUMP DISCHARGE FROM BELOW. PROVIDE UNION, CHECK VALVE AND ISOLATION
- VALVE IN VERTICAL PIPING
- EXISTING 4" BUILDING SEWER EXIT FROM BUILDING
- EXISTING 4" SANITARY
- 2" VENT UP. CONNECT TO EXISTING VENT RISER IN CHASE ABOVE
- 2" VENT RISE FROM PUMP BASIN
- DUPLEX PUMP CONTROLLER AND VISUAL ALARM
- 1-1/2" SANITARY IN WALL; 1/2" HOT AND COLD WATER DROP DOWN TO FAUCET SUPPLIES
- 1-1/2" SANITARY IN WALL, 2" SANITARY DOWN, 2" VENT RISE; 1/2" HOT AND COLD WATER DROP DOWN TO FAUCET SUPPLIES
- 1-1/2" SANITARY IN WALL, 2" SANITARY DOWN, 1-1/2" VENT RISE; 1/2" HOT AND COLD WATER DROP DOWN TO FAUCET SUPPLIES
- 3" SANITARY FROM WC, 2" VENT RISE; 1" COLD WATER DROP
- 1" COLD WATER DROP DOWN TO WATER SUPPLIES FOR WATER CLOSET

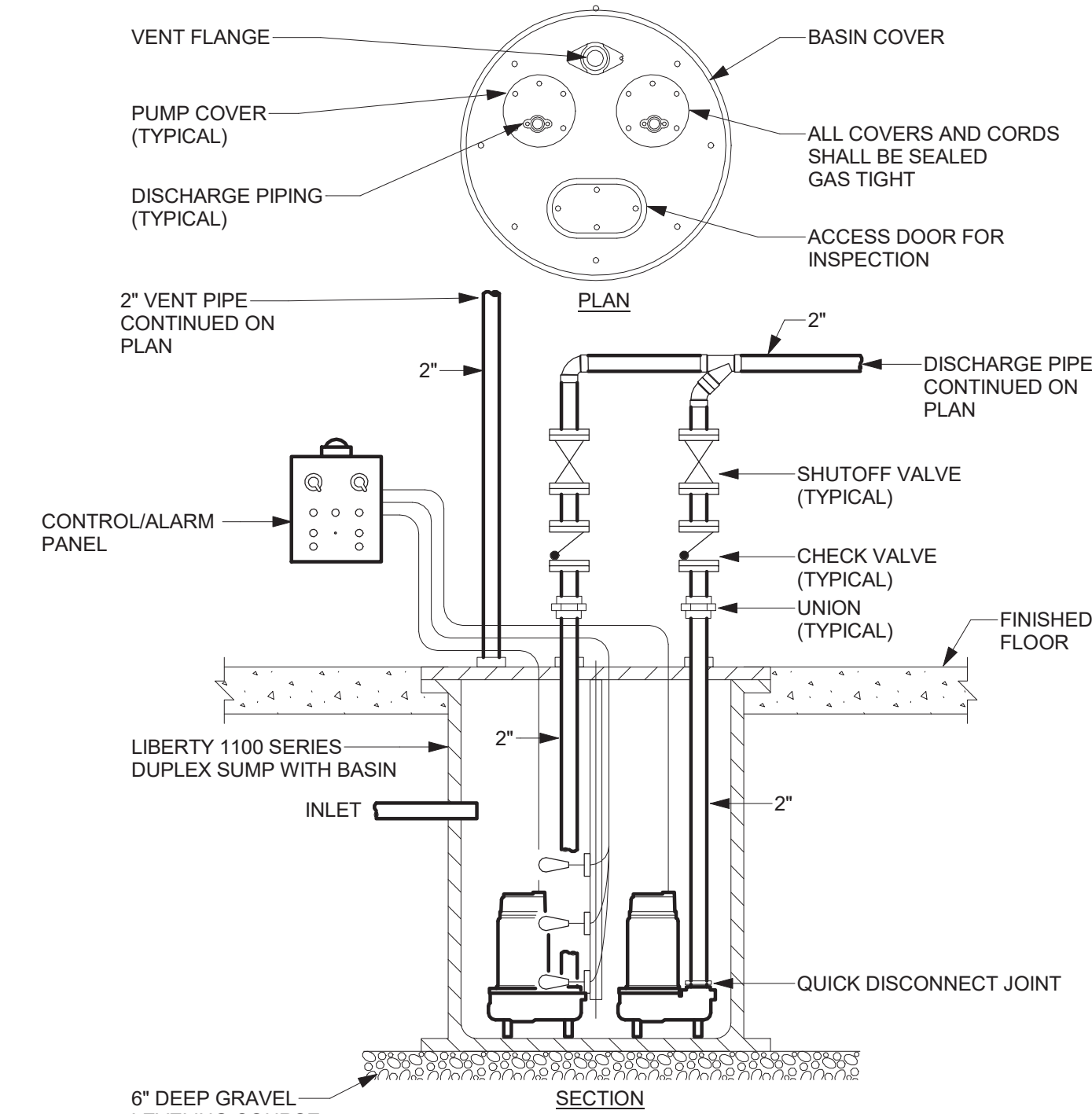

3 DUPLEX SEWAFE EJECTOR DETAIL - SUBMERSIBLE  
NOT TO SCALE

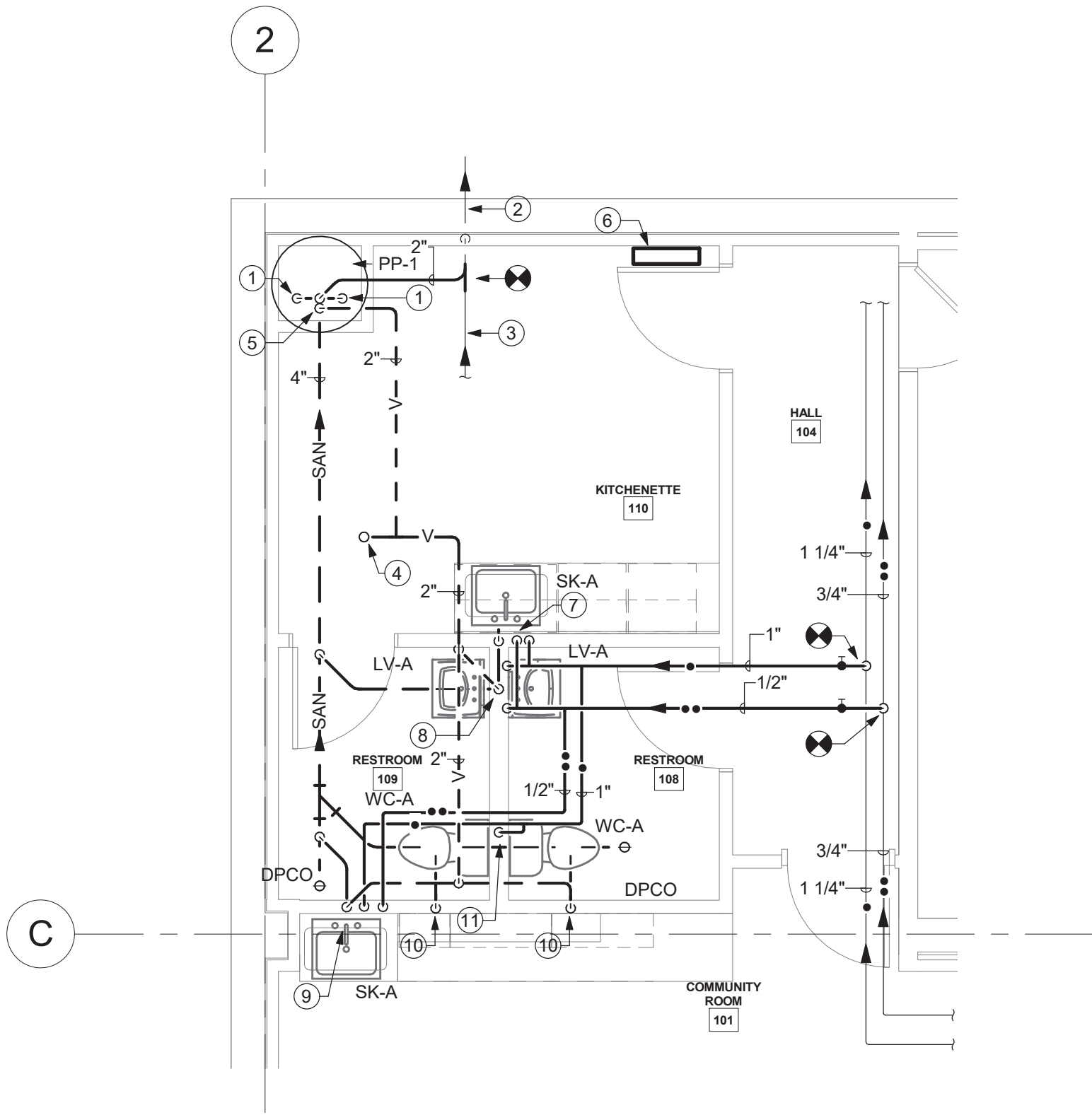

2 ENLARGED RESTROOMS PLUMBING PLAN  
1/4" = 1'-0"

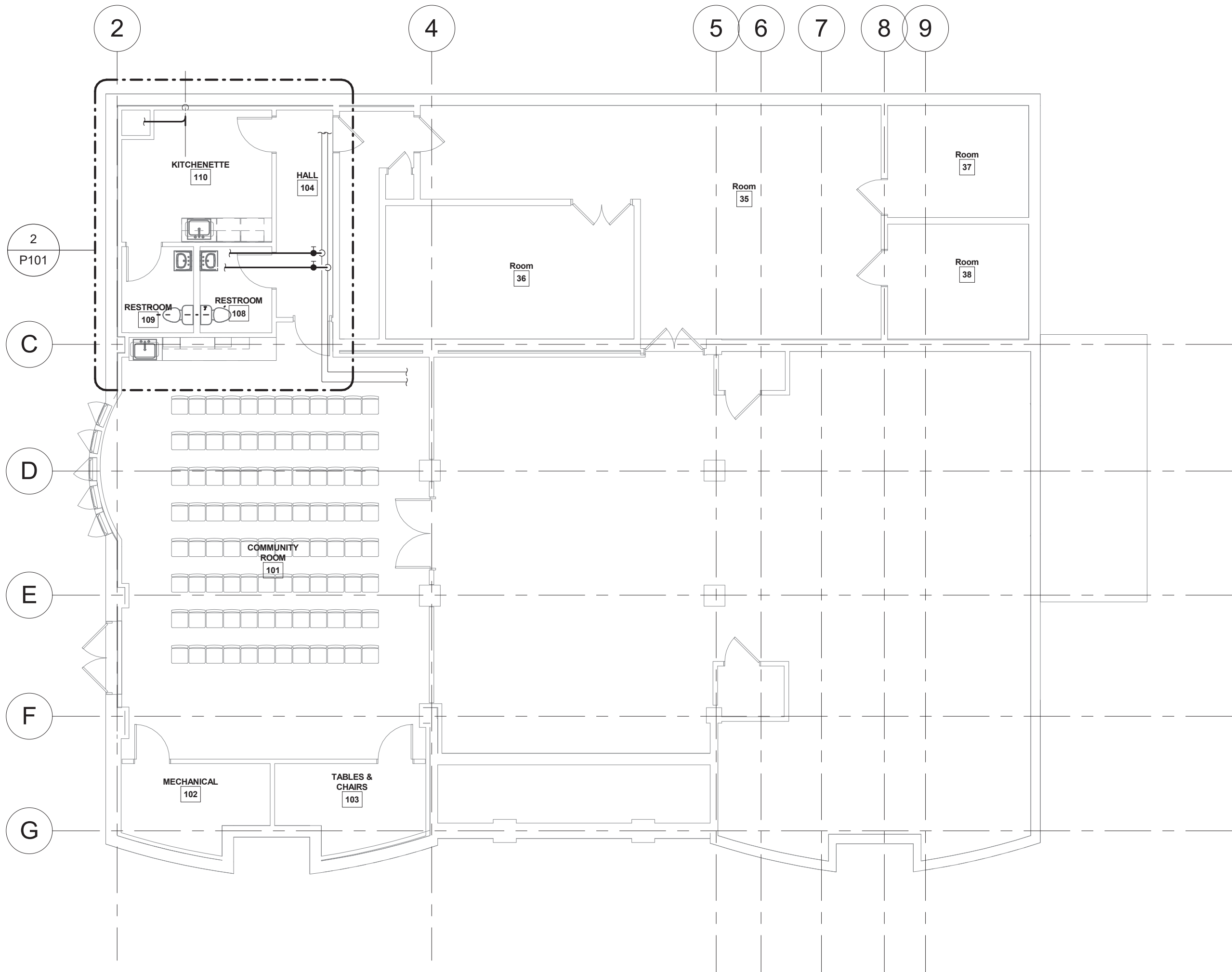

1 LOWER LEVEL PLUMBING PLAN  
1/8" = 1'-0"

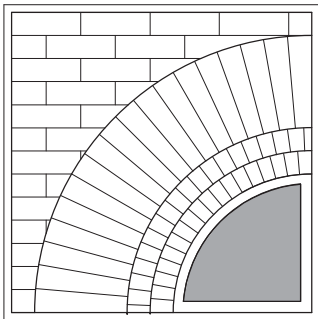

**BUTLER  
ROWLAND  
MAYS**  
ARCHITECTS, LLP

57 West High Street  
Ballston Spa  
New York 12020

P: 518-885-1255  
F: 518-885-1266  
www.brmachitects.com

**Phase 1 Interior  
Improvements to the  
Lower Level  
for the**

**The  
Beekman  
Library**

11 Town Center Boulevard  
Hopewell Junction, NY 12533

PROJECT

**ME ENGINEERING**  
Mechanical/Electrical Engineering Consultants  
Owner/Designer: Ballston Spa  
Schematic Design/Design

CONSULTANT



STAMP Reg. Exp: 05/31/2024  
Cert. of Auth: 0018443

CALLED NORTH

DWN. BY: MT  
SCALE: As indicated  
JOB NO.: 22-48-09  
DATE: 9/1/2023

**PLUMBING  
PLAN**

TITLE

**P101**  
DWG. NO.