

SITE LOCATION MAP
SCALE=NONE

MAP NOTES:

- Topographic information shown hereon was compiled from an actual field survey conducted during the month of February, 2022.
- North orientation is referenced to Grid North and is based on the New York State Plane Coordinate System, East Zone, NAD 83/2011 epoch 2010.00.
- Vertical datum shown hereon is NAVD 88 and was obtained from GPS observations using Newburgh CORS.
- The location of underground improvements or encroachments, if any exist, or as shown hereon, are not certified. There may be underground utilities, the existence of which are not known to the undersigned. Size and location of all underground utilities and structures must be verified by the appropriate authorities. Dig Safety New York must be notified prior to conducting test borings, excavation and construction.

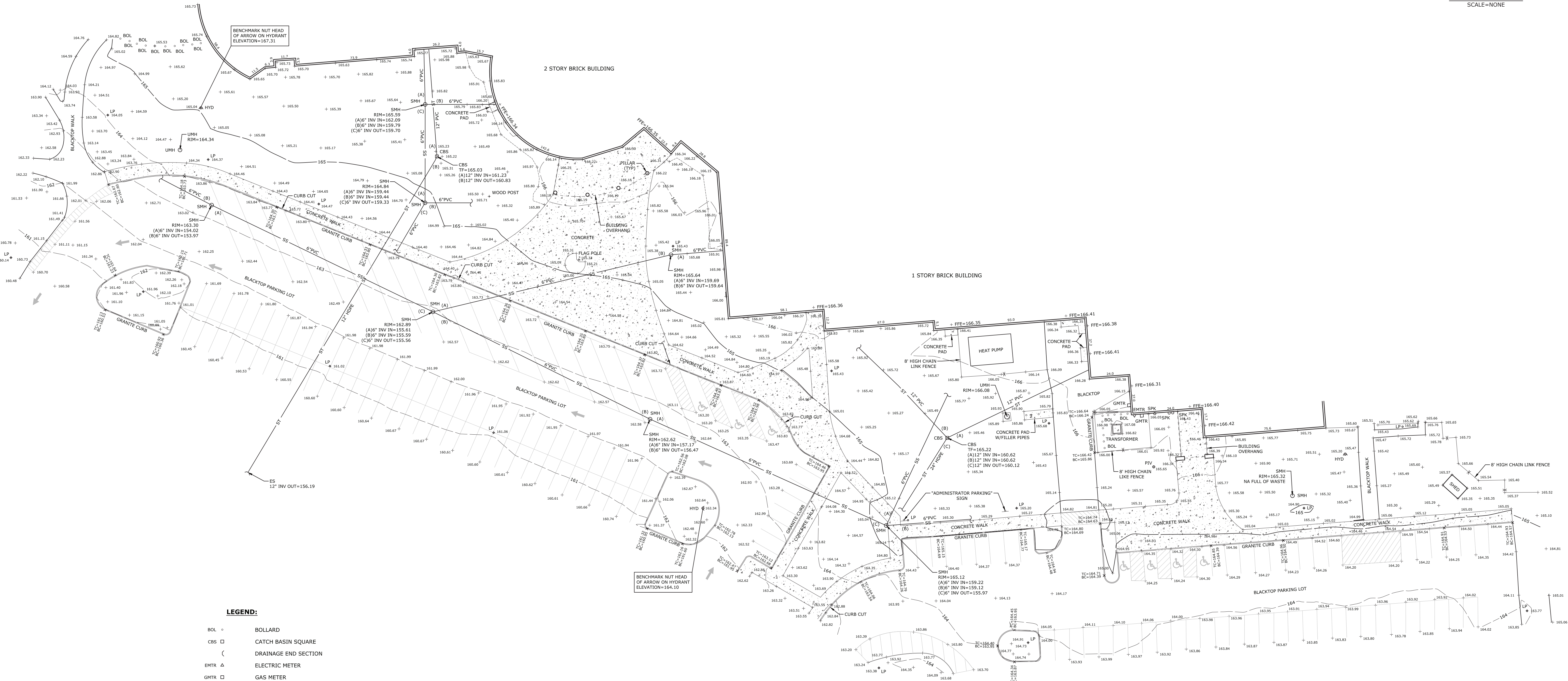

LEGEND:

- BOL ○ BOLLARD
- CBS □ CATCH BASIN SQUARE
- () DRAINAGE END SECTION
- ENTR ▲ ELECTRIC METER
- GMTR □ GAS METER
- HYD ◆ HYDRANT
- LP ● LIGHT POLE
- PV ○ POST INDICATOR VALVE
- SMH ○ SANITARY MANHOLE
- SPK ○ SPRINKLER HOOK UP
- TC × TOP & BOTTOM CURB ELEVATION
- UMH ○ UNKNOWN MANHOLE
- BUILDING OVERHANG
- SS UNDERGROUND SANITARY LINE
- ST UNDERGROUND STORM LINE

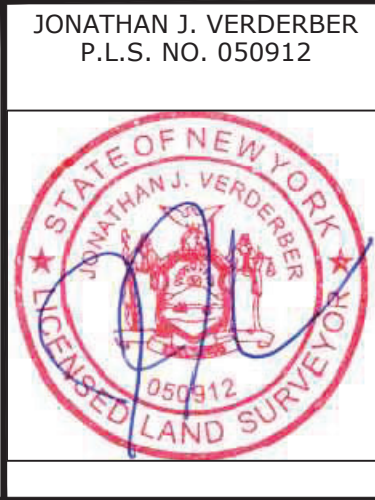
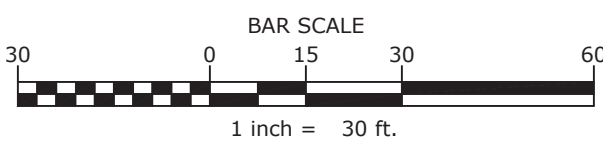

DATE	REVISIONS RECORD/DESCRIPTION	DRAFTER	CHECK	APPR.	UNAUTHORIZED ALTERATION OR ADDITION TO THIS DOCUMENT IS A VIOLATION OF THE NEW YORK STATE EDUCATION LAW.
					2022
					C.T. MALE ASSOCIATES
					APPROVED: WJN
					DRAFTED : SMW
					CHECKED : JJV
					PROJ. NO : 21.1761
					SCALE : 1"=30'
					DATE : MAR. 4, 2022

TOPOGRAPHIC SURVEY

PORTION OF
BEACON HIGH SCHOOL
110 MATTEAWAN ROAD

FV003

CITY OF BEACON

DUTCHESS COUNTY, NEW YORK

C.T. MALE ASSOCIATES
Engineering, Surveying, Architecture, Landscape Architecture & Geology, D.P.C.
50 CENTURY HILL DRIVE, LATHAM, NY 12110 PH 518.786.7400
COBLESKILL, NY • GLENS FALLS, NY • POUGHKEEPSIE, NY
JOHNSTOWN, NY • RED HOOK, NY • SYRACUSE, NY

SHEET 1 OF 1

DWG. NO: 22-0252