

**1** FIRST FLOOR DEMOLITION PLAN - AREA 'B'

## GENERAL NOTES

1. COORDINATE ALL REMOVALS WITH NEW CONSTRUCTION.
2. PATCH AND REPLACE EXISTING AND NEWLY CREATED HOLES IN WALLS (DUE TO REMOVAL) WITH MATERIALS TO MATCH EXISTING CONSTRUCTION.
3. SALVAGED ITEMS SHALL BE TURNED OVER TO OWNER.
4. ALL KEVED REMOVALS SHALL INCLUDE REMOVAL OF ANY AND ALL ANCHORING SYSTEMS INCLUDING OBJECTS EMBEDDED INTO EXISTING WALLS.
5. REFER TO ASBESTOS AND MEP DRAWINGS FOR ADDITIONAL REMOVAL INFORMATION.
6. PROVIDE TEMPORARY SHORING AS NECESSARY AT ALL AREAS OF WALL REMOVAL AND NEW WALL PENETRATIONS.
7. DRILL CORNERS OF ALL NEW SAWCUT OPENING PRIOR TO SAWCUTTING, TO PREVENT CUTTING INTO SCHEDULED CONSTRUCTION TO REMAIN.

## KEY NOTES - DEMOLITION

X	DESCRIPTION
D2	REMOVE EXISTING RESILIENT TILE FLOORING, WALL BASE, AND MASTIC IN ITS ENTIRETY. COORDINATE WITH HAZARDOUS MATERIAL DRAWINGS.
D7	REMOVE EXISTING MOVABLE DIVIDING PARTITION IN ITS ENTIRETY INCLUDING TRACKS, PANELS, AND HARDWARE.
D10	REMOVE EXISTING DOOR AND HARDWARE IN ITS ENTIRETY.
D17	REMOVE PORTION OF EXISTING MASONRY WALL TO ACCOMMODATE NEW ELECTRICAL WORK. COORDINATE WITH ELECTRICAL DRAWINGS.

## KEYPLAN

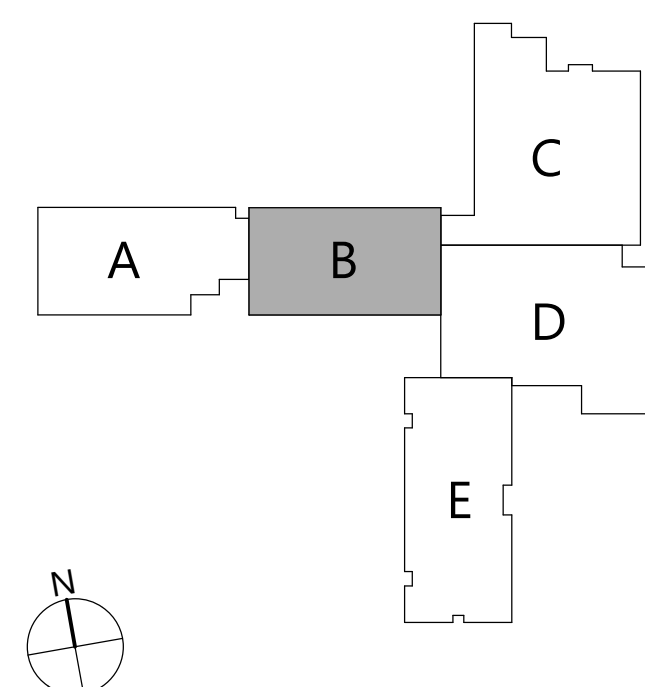

**COPYRIGHT © ALL RIGHTS RESERVED**

19 Front St. - Newburgh - New York 12550-7601  
845-561-3179 [www.csarchpc.com](http://www.csarchpc.com)

CSARCH

Consultant

HIGHLAND CENTRAL SCHOOL DISTRICT  
HIGHLAND ELEMENTARY SCHOOL  
2022 CAPITAL IMPROVEMENT PROJECT - PHASE 1

Project Title



**Expiration Date:** 02/28/2025

	DATE	DESCRIPTION

Drawn By:	CSA
Checked By:	CSA
Proj. #:	62-08-03-04-0-010-014
CSArch Proj. #:	197-2201.0
Issued for Bid:	08/18/23

Sheet Title

FIRST FLOOR  
DEMOLITION  
PLAN - AREA  
'B'

Sheet No. HES  
AD112

**CONSTRUCTION DOCUMENTS**