

1
A813 1/8" = 1'-0"
FIRST FLOOR NEW WORK RCP - AREA 'C'

CEILING NOTES

1. INSTALL CEILING GRIDS CENTERED IN THE ROOM. UNO. IN ROOMS OTHER THAN RECTANGULAR SHAPED, INSTALL GRIDS CENTERED ON WALLS OR OTHER BUILT FEATURES AS INDICATED.
2. INSTALLATION HEIGHTS OF THE CEILINGS MAY VARY SLIGHTLY FROM PLANS IN ROOMS WITH EXTERIOR WINDOWS. ACTUAL CEILING HEIGHT TO BE VERIFIED IN THE FIELD.
3. FINAL INSTALLED CEILINGS SHALL HAVE HEIGHTS COORDINATED WITH OTHER CONTRACTORS WITH ABOVE CEILING WORK AND VERIFIED WITH FIELD CONDITIONS. ALL CHANGES IN CONFIGURATION OR HEIGHTS ARE TO BE APPROVED BY THE ARCHITECT.

CEILING LEGEND

- QWB OR PLASTER CEILING, REFER TO DETAILS AND ROOM FINISH SCHEDULE
- SUSPENDED ACOUSTICAL PANEL CEILING SYSTEM
- CEILING HEIGHT ABOVE FINISHED FLOOR
- LIGHT FIXTURES
COORDINATE NEW WORK WITH ELECTRICAL DRAWINGS
- HVAC EQUIPMENT
COORDINATE NEW WORK WITH MECHANICAL DRAWINGS

KEY NOTES - NEW WORK

(X)	DESCRIPTION
8	PROVIDE NEW ACT. CEILING AS SPECIFIED, COORDINATE WITH MECHANICAL AND ELECTRICAL DRAWINGS.
E1	LIGHT FIXTURE, TYPICAL REFER TO ELECTRICAL DRAWINGS.

KEYPLAN

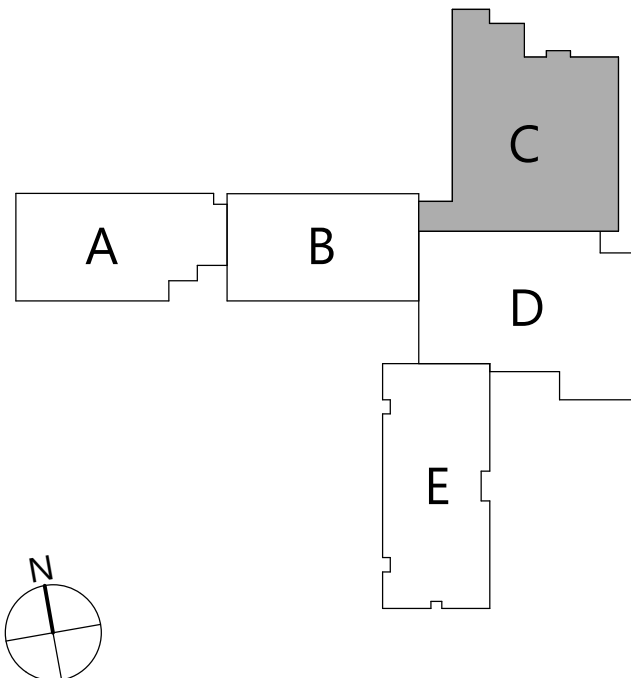

19 Front St., Newburgh, New York 12550-7601
845.561.1317 www.csarchitect.com

CSARCH

Consultant

HIGHLAND CENTRAL SCHOOL DISTRICT
HIGHLAND ELEMENTARY SCHOOL
2022 CAPITAL IMPROVEMENT PROJECT - PHASE 1

Project Title



Expiration Date: 02/28/2025

DATE	DESCRIPTION

Drawn By: CSA
Checked By: CSA
Proj. #: 62-08-03-84-0-010-014
CSArch Proj. #: 197-2201.01
Issued for Bid: 08/18/23

Sheet Title
FIRST FLOOR
NEW WORK
RCP - AREA 'C'

Sheet No.
HES
A813

CONSTRUCTION DOCUMENTS

COPYRIGHT © ALL RIGHTS RESERVED