

GENERAL NOTES:

- EXISTING CONDITIONS SHOWN ARE BASED ON THE BOUNDARY AND TOPOGRAPHIC SURVEY PREPARED BY BOUTON SURVEYING P.C. ON DEC. 31, 2014 AND REVISED JANUARY 11, 2015.
- CONTRACTOR SHALL FIELD VERIFY ACTUAL SITE CONDITIONS. CONTRACTOR SHALL IDENTIFY DISCREPANCIES THAT AFFECT THE WORK TO THE OWNER REPRESENTATIVE AND OBTAIN APPROVAL FOR DEVIATIONS PRIOR TO PROCEEDING WITH THE WORK.
- CONTRACTOR SHALL LOCATE ALL EXISTING UTILITIES VERTICALLY AND HORIZONTALLY AND NOTIFY OWNER REPRESENTATIVE OF DEVIATIONS THAT AFFECT THE WORK. AND OBTAIN WRITTEN APPROVAL FROM THE OWNER REPRESENTATIVE FOR ADJUSTMENTS TO THE WORK.
- CONTRACTOR SHALL PROTECT ALL EXISTING UTILITIES DURING THE WORK, AND VERIFY THEIR FUNCTIONALITY FOLLOWING INSTALLATION OF THE PROPOSED CONCRETE SIDEWALK.
- PROPOSED SIDEWALK SHALL GENERALLY FOLLOW THE SAME DIMENSIONS AND ALIGNMENT AS THE EXISTING SIDEWALK.
- UPON COMPLETION, ALL PAVEMENT AREAS SHALL BE SMOOTH. ALL CURBS SHALL HAVE A 6" INCH REVEAL (UNLESS OTHERWISE SPECIFIED), AND STORMWATER RUNOFF SHALL DRAIN TO EITHER EXISTING OR PROPOSED CATCH BASINS.
- ALL EXISTING SURFACE UTILITIES SHALL BE FLUSH WITH ADJACENT CONCRETE OR LAWN SURFACE.
- RESTORE LAWN DAMAGED DURING THE WORK WITH MATERIALS MATCHING THE EXISTING CONDITION.

PAVEMENT DEMOLITION NOTES:

- REMOVE FULL DEPTH OF ASPHALT AND/OR CONCRETE.
- EXISTING SUITABLE SUB-BASE ENCOUNTERED DURING EXCAVATION SHALL BE STOCKPILED FOR RE-USE. EXCESS OR UNSUITABLE MATERIALS SHALL BE HAULED OFF-SITE.
- PREPARE AND PLACE A SUB-BASE COURSE COMPOSED OF A BLEND OF THE EXISTING SUB-BASE (FROM STOCKPILE) AND ADDITIONAL STONE AGGREGATE (IF NEEDED) TO OBTAIN THE SPECIFIED DEPTH.

DEMOLITION NOTES:

- DIMENSIONS SHOWN ARE APPROXIMATE AND MAY VARY BASED ON FIELD CONDITIONS.
- SECURITY PROVIDE, INSTALL AND MAINTAIN TEMPORARY BARRIERS AND SECURITY DEVICES.
- DIG SAFE CONTRACTOR IS RESPONSIBLE TO CALL DIG-SAFE PRIOR TO BEGINNING DEMOLITION.
- APPLICABILITY: THE CONTRACTOR IS RESPONSIBLE FOR ALL DEMOLITION WORK SHOWN INCLUDING ALL REMOVALS AS NECESSARY FOR THE CONSTRUCTION OF THE WORK EVEN IF NOT SPECIFICALLY NOTED ON THE CONTRACT DOCUMENTS.
- COORDINATION: CONTRACTOR SHALL COORDINATE THE REMOVAL OF DEMOLISHED MATERIAL WITH THE OWNERS REPRESENTATIVE SITE FURNISHINGS AND MATERIAL DETERMINED TO BE REMOVED SHALL BE REMOVED AND EXPORTED OFF-SITE IN A LEGAL MANNER AND IN ACCORDANCE WITH ALL LOCAL, STATE AND FEDERAL REGULATIONS.
- PROTECT: ALL EXISTING FEATURES TO REMAIN, DAMAGE TO EXISTING ASPHALT, LAWN AND OTHER FEATURES TO REMAIN SHALL BE REPAIRED AT THE CONTRACTOR'S EXPENSE.
- EXISTING UTILITIES THAT ARE PROPOSED TO BE REMOVED, UNLESS OTHERWISE INDICATED, SHALL BE EXCAVATED, UTILITY MATERIAL REMOVED, AND DISPOSED OF IN ACCORDANCE WITH ALL APPLICABLE SPECIFICATIONS. ALL TRENCHES SHALL BE BACKFILLED WITH GRANULAR FILL, COMPACTED IN 12" LIFTS TO 95% MODIFIED PROCTOR TEST. ALL DISTURBED AREAS SHALL BE RESTORED IN KIND IN ACCORDANCE WITH THE DETAILS IN THESE PLANS AND AT A MINIMUM TO THEIR ORIGINAL STATE.
- SAWCUT: AREAS OF ASPHALT AND CONCRETE REMOVAL SHALL BE SAWCUT WITH A HEAT STRAIGHT LINE AT ALL REMOVAL LIMITS.
- PERMITS: CONTRACTOR IS RESPONSIBLE TO OBTAIN ALL PERMITS REQUIRED FOR DEMOLITION AND CONSTRUCTION, INCLUDING ALL FEES ASSOCIATED WITH THOSE PERMITS, IN THE BID.
- ENVIRONMENTAL CONDITIONS OR ISSUES, NOT PREVIOUSLY IDENTIFIED, ARE ENCOUNTERED DURING DEMOLITION. THE CONTRACTORS SHALL IMMEDIATELY NOTIFY THE OWNER AND ENGINEER BEFORE CONTINUING THE DEMOLITION PROCESS.

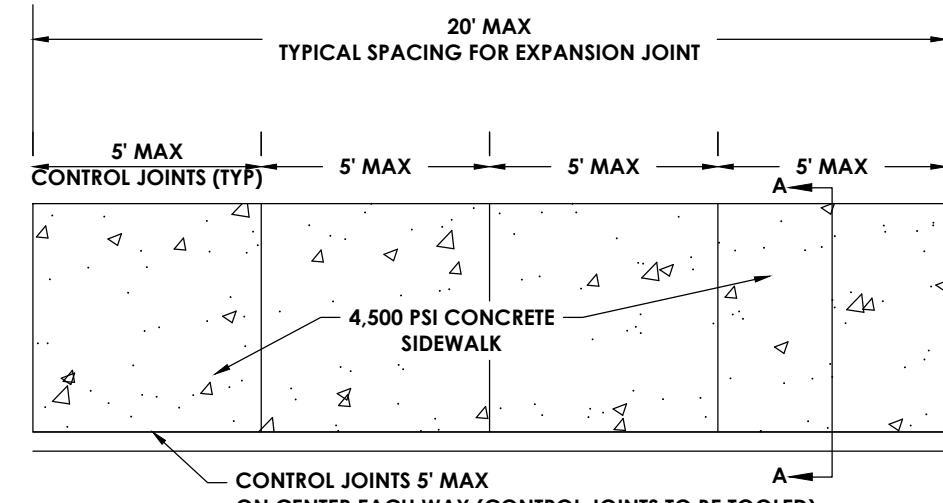
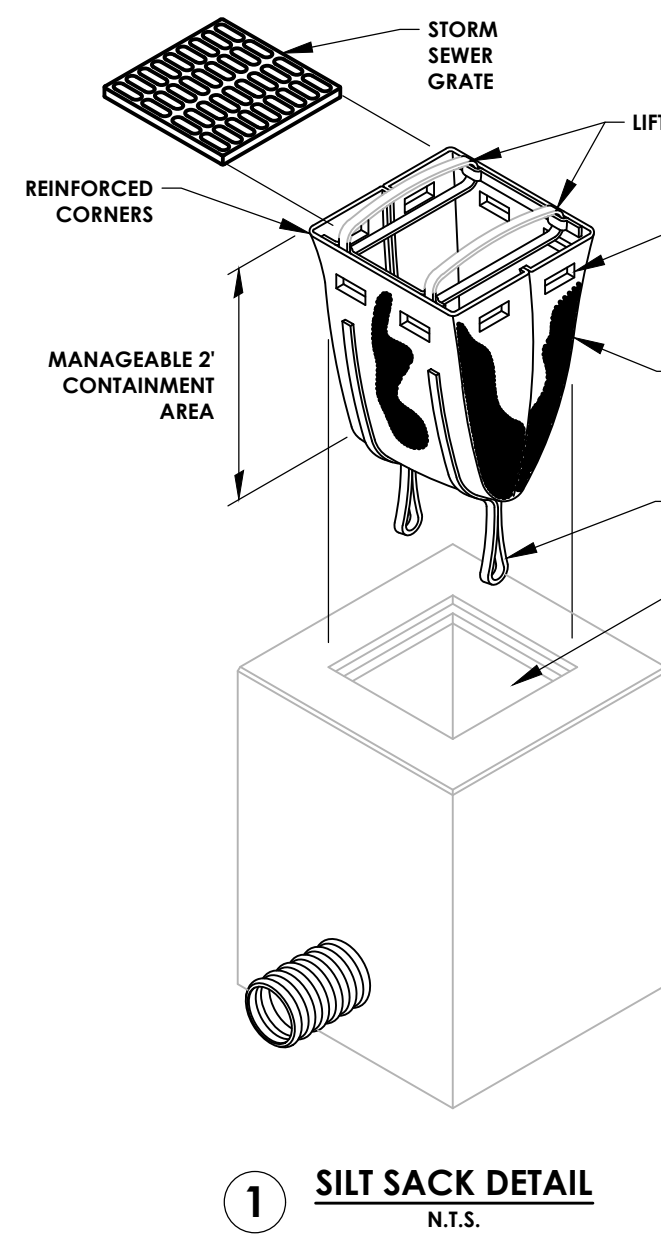

NOTES:

- SIDEWALK WIDTH SHALL BE MEASURED FROM THE BACK OF THE CURB TO SIDEWALK EDGE OR SIDEWALK EDGE TO SIDEWALK EDGE UNLESS OTHERWISE SPECIFIED.
- WHERE IT IS NECESSARY TO PLACE FILL FOR PURPOSE OF BRINGING THE SUBGRADE ELEVATION UP TO A SPECIFIED GRADE, THE FILL MATERIAL SHALL BE ON-SITE EXCAVATION SPOIL (IF SUITABLE) AND/OR IMPORTED GENERAL FILL FREE OF CONTAMINANTS AND DELETERIOUS MATERIALS.
- NYSDOT SUBBASE TYPE 2 SHALL CONFORM TO NYSDOT STANDARD SPECIFICATION SECTION 304, LATEST EDITION.
- CONCRETE SHALL NOT BE PLACED UNLESS THE AMBIENT AIR SURFACE TEMPERATURE IS BELOW 40 DEGREES UNLESS AUTHORIZED BY THE ENGINEER.
- SIDEWALKS SHALL HAVE A CROSS SLOPE OF 1.5% PER FOOT UNLESS OTHERWISE SPECIFIED ON THE PLANS.
- ALL EXPOSED CONCRETE SURFACES SHALL BE PROOF FINISHED AND THE EDGES SHALL BE FINISHED WITH A 1/2" RADIUS EDGING TOOL.
- THE FINISHED CONCRETE SURFACE SHALL BE TREATED WITH CONCRETE SEALER, HARDENER AND DUSTPROOFER. RATE AND METHOD OF APPLICATION SHALL BE IN ACCORDANCE WITH MANUFACTURER'S RECOMMENDATIONS.

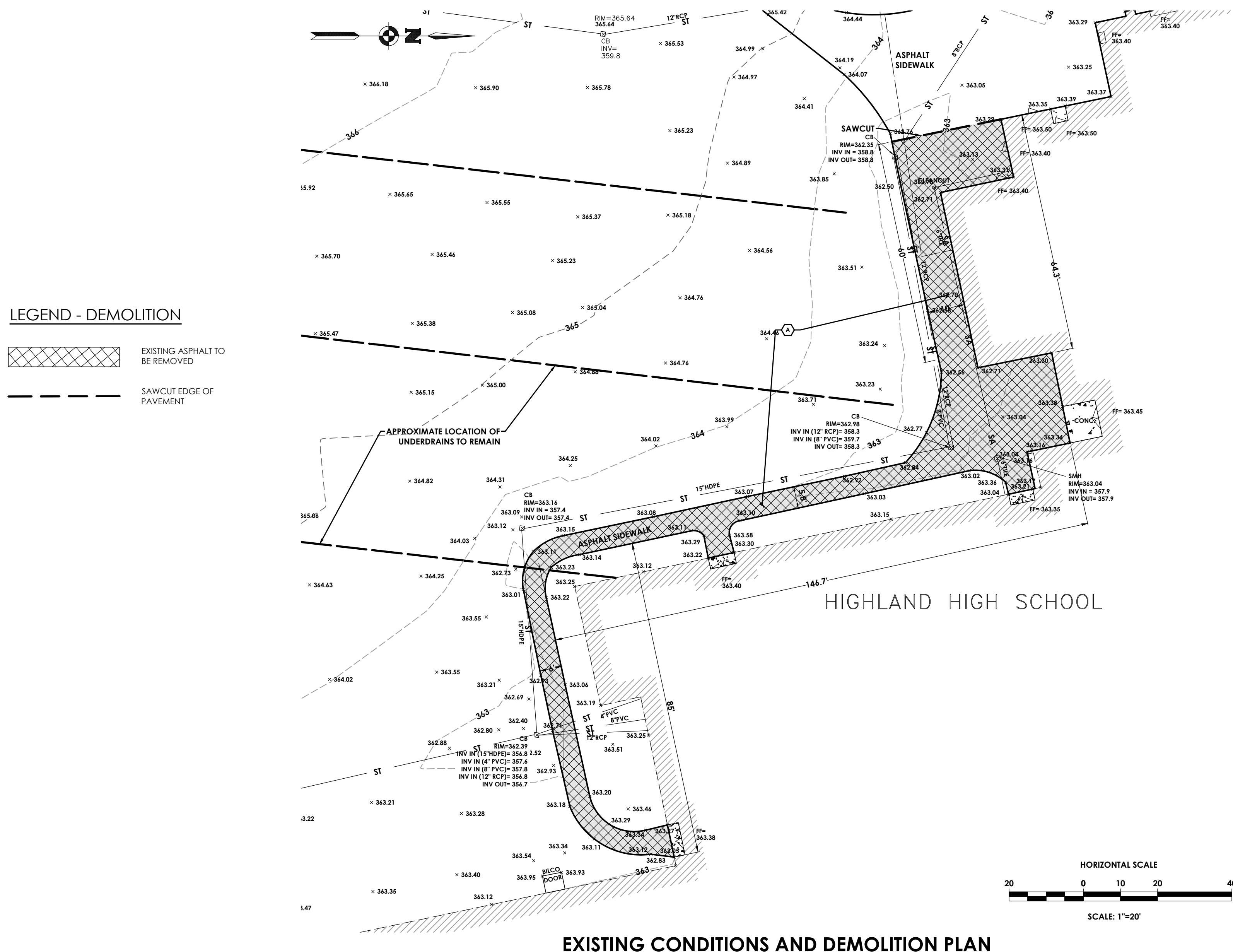
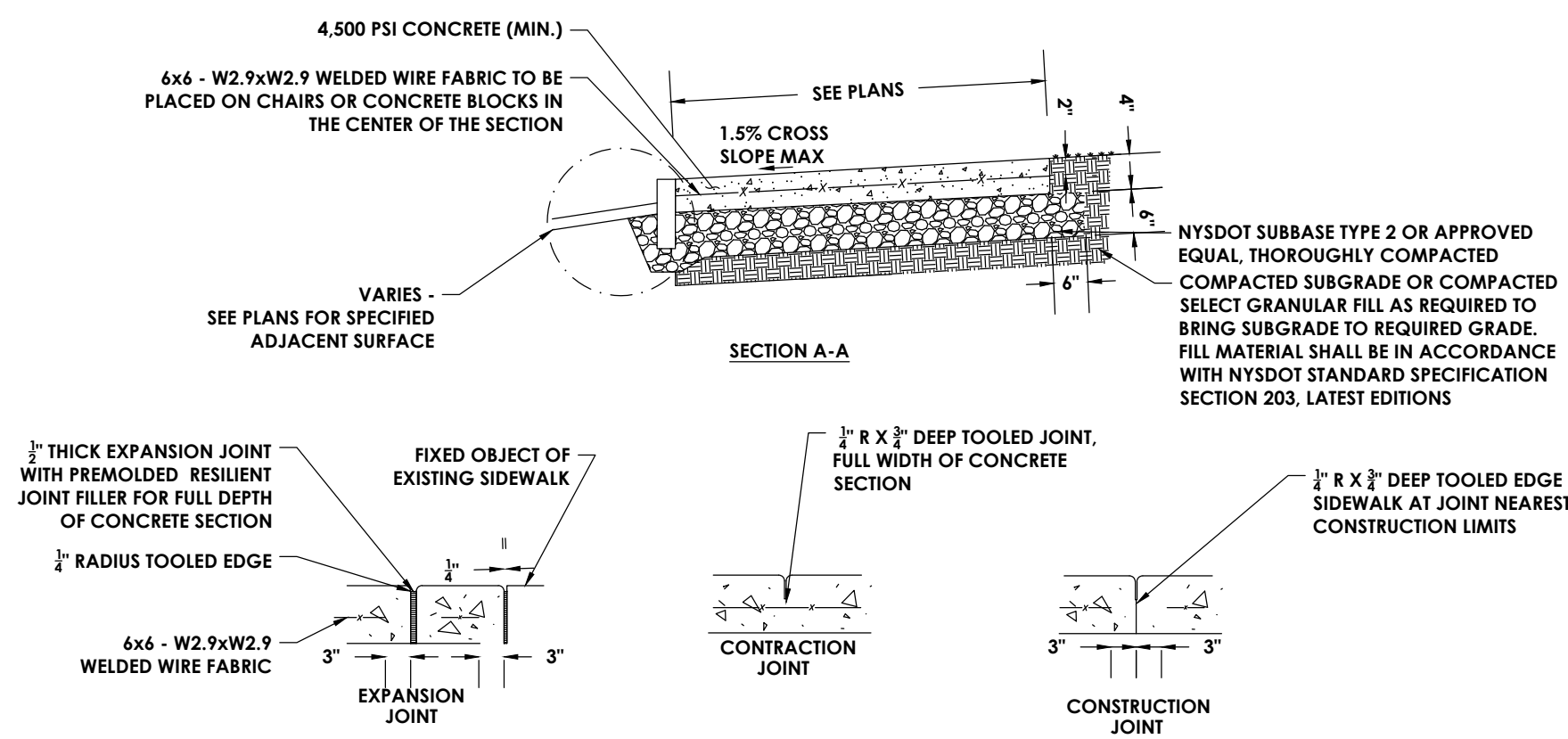

LEGEND - SITE:

- EXISTING BUILDING
- EXISTING STORM SEWER, MH, CATCH BASIN
- EXISTING WATER LINE
- EXISTING SANITARY SEWER
- PROPOSED CONCRETE PAVEMENT
- PROPOSED INLET PROTECTION

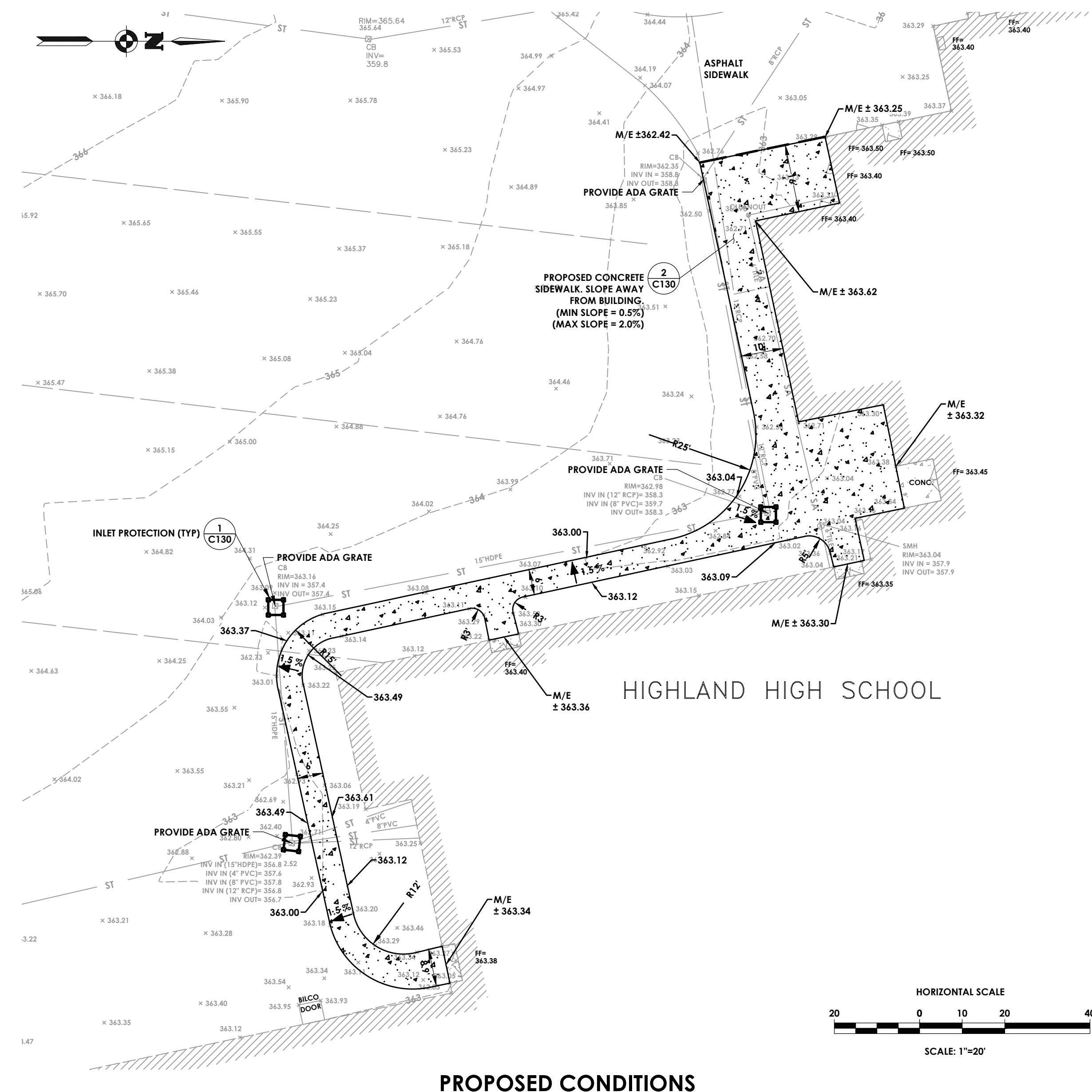

DEMOLITION KEY:

- REMOVE AND DISPOSE OF EXISTING ASPHALT PAVEMENT AND SUBBASE (~3,300 SF).