

C:\Users\dmiller\Documents\197-2201 - HHS Phase1_ARCH_dmliller303.rvt

1 FIRST FLOOR NEW WORK PLAN - AREA 'C'

A113 1/8" = 1'-0"

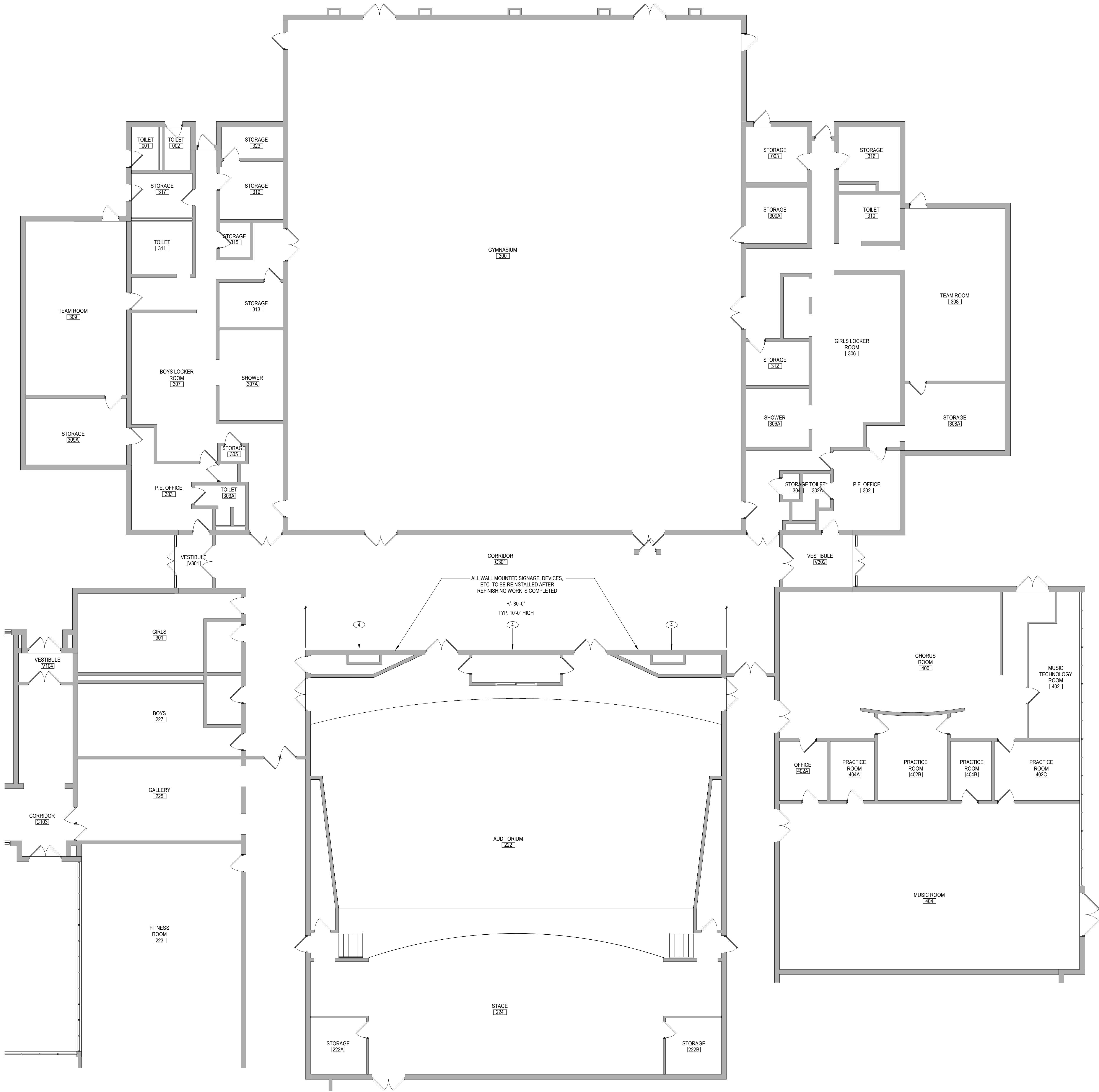

GENERAL NOTES	
1. REFER TO SHEET G001 FOR ADDITIONAL GENERAL NOTES.	
2. REFER TO A700 SERIES DRAWINGS PARTITION TYPES AND ADDITIONAL NOTES.	
3. REFER TO A800 SERIES DRAWINGS FOR DOOR, STOREFRONT, CURTAINWALL, WINDOW AND LOUVER SCHEDULES, DETAILS AND NOTES.	
4. ALL NEW LOCKERS ARE 15" WIDE x 10" DEEP & TWO TIER.	
KEY NOTES - NEW WORK	
NO.	DESCRIPTION
4	PROVIDE NEW STAIN AND CLEAR COAT PROTECTIVE SEALER FOR WOOD PANEL WALL AS SPECIFIED.

KEYPLAN

19 Front St. Newburgh - New York 12550-7601
845.561.5379 www.csarch.com

CSARCH

197-2201 - HHS Phase1_ARCH_dmliller303.rvt

HIGHLAND CENTRAL SCHOOL DISTRICT
HIGHLAND HIGH SCHOOL
2022 CAPITAL IMPROVEMENT PROJECT - PHASE 1

Consultant

Project Title

REGISTERED ARCHITECT
STATE OF NEW YORK
623344
Expiration Date: 02/28/2025

DATE DESCRIPTION

Drawn By: CSA
Checked By: CSA
Proj. #: 62-08-03-04-0-009-014
CSArch Proj. #: 197-2201.01
Issued for Bid: 08/18/23

Sheet Title

FIRST FLOOR
NEW WORK
PLAN - AREA
'C'

Sheet No.

HHS
A113

CONSTRUCTION DOCUMENTS

COPYRIGHT © ALL RIGHTS RESERVED