

TYPICAL ACCESSIBLE PARKING LAYOUT  
SCALE: N.T.S.

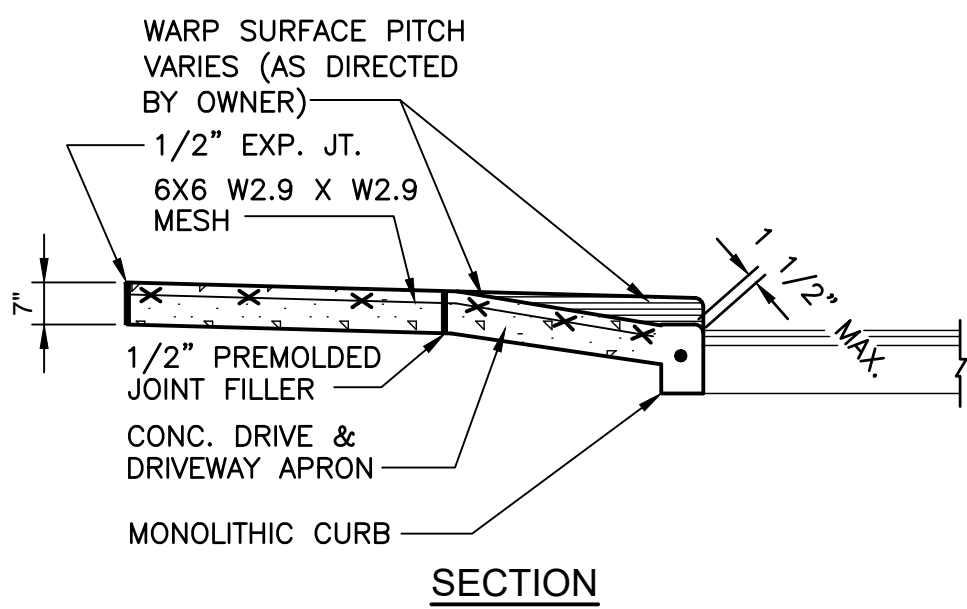

DROP CURB AND DRIVEWAY APRON DETAIL  
SCALE: N.T.S.

1'-6" x 1'-0" x 18GA. REFLECTIVE PORCELAIN ENAMEL STANDARD "HANDICAPPED PARKING" SIGNS WITH IDENTIFICATION SYMBOL. BOLT TO SIDE OF STEEL TUBE WITH 3/8" CADMIUM PLATED BOLTS, NUTS AND WASHERS. (TYP)

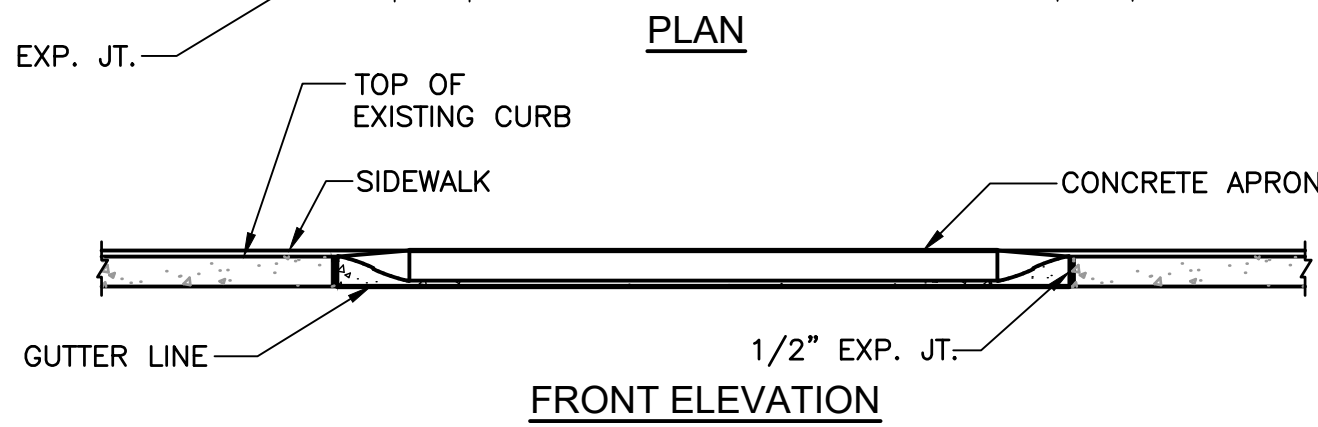
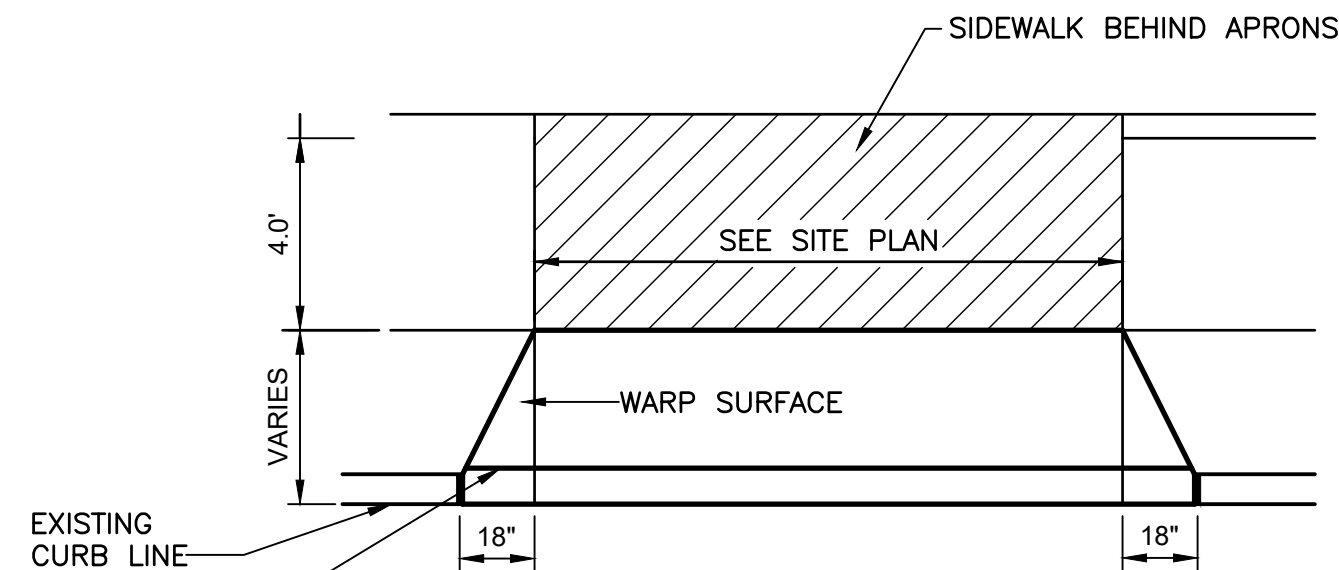
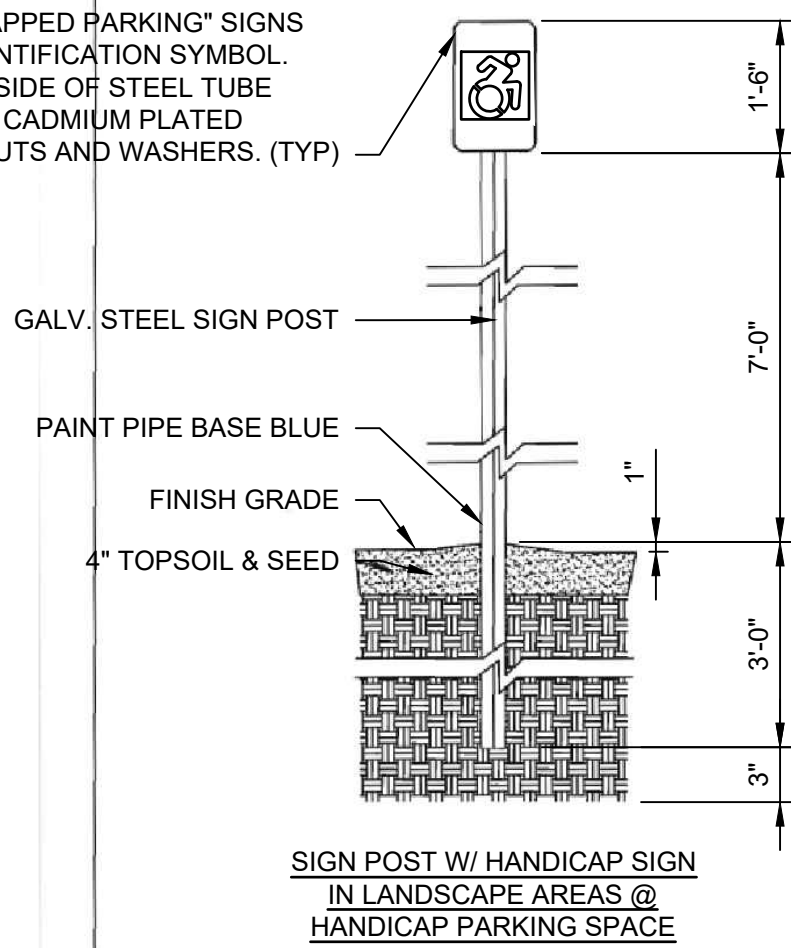

SIGN POST W/ HANDICAP SIGN  
IN LANDSCAPE AREAS @  
HANDICAP PARKING SPACE

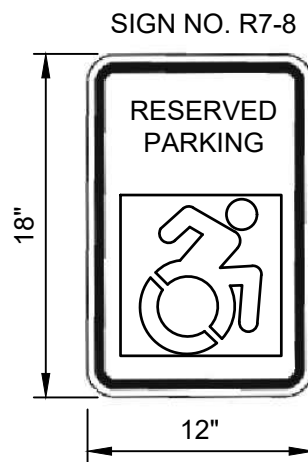

SIGN NO. R7-8

COLORS:  
LEGEND & BORDERS - BLUE  
WHITE SYMBOL ON BLUE BACKGROUND  
SIGN BACKGROUND - WHITE

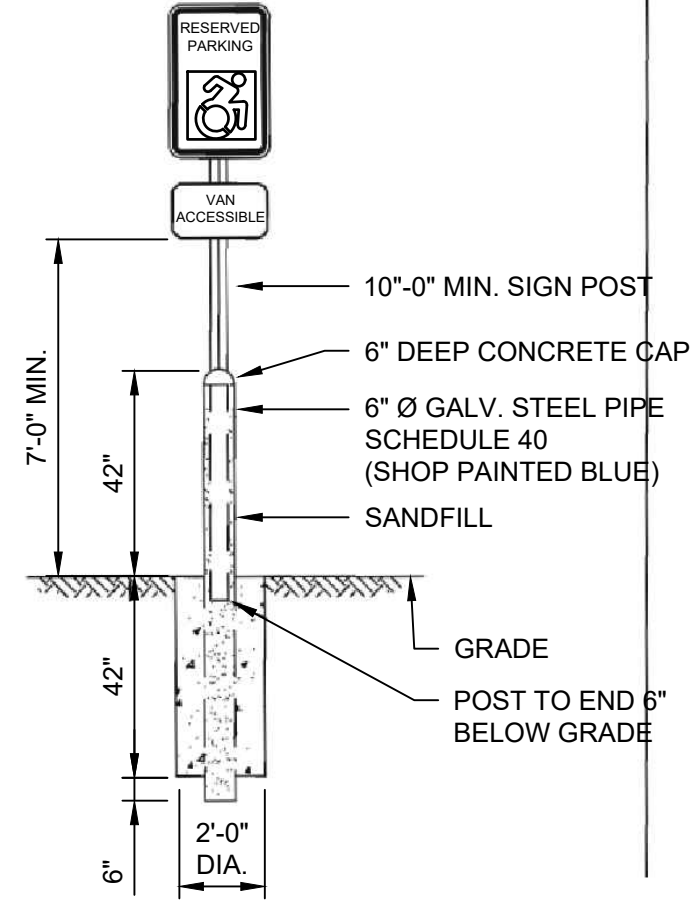

BOLLARD W/ HANDICAP SIGN  
IN PARKING AREAS

ACCESSIBLE PARKING SPACE AND ACCESS AISLE SIGN  
SCALE: N.T.S.

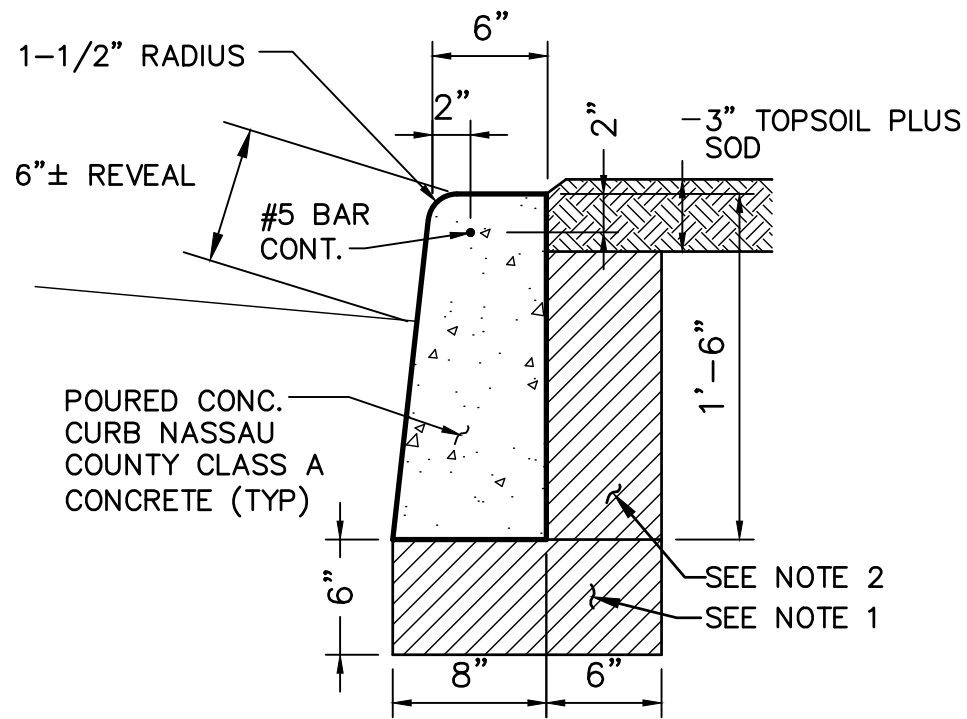

CONCRETE CURB DETAIL  
SCALE: N.T.S.

NOTE:

- CUT AND REMOVE ALL ROOTS AND OTHER UNSUITABLE SUBGRADE MATERIALS. REPLACE WITH COMPACTED MATERIAL.
- CUT AND REMOVE ALL ROOTS AND OTHER UNSUITABLE MATERIALS.

NO.	DATE	REVISION	INT.



UNAUTHORIZED ALTERATION OR ADDITION TO THIS DOCUMENT IS A VIOLATION OF SECTION 7209 OF THE NEW YORK STATE EDUCATION LAW.			
PROJECT ENGINEER:	AE	DRAWN BY:	GO
DESIGNED BY:	GO	CHECKED BY:	AC/WDM



TOWN OF BLOOMING GROVE	
ORANGE COUNTY	NEW YORK
LASSER PARK SENIOR CENTER	

CONTRACT 2
DETAIL II
CIVIL

PROJECT NO. 5708
DATE: AUGUST 2023
SCALE: AS SHOWN

DRAWING NO. <b>C4</b>
--------------------------