

P:\0708-BG-Senior Center\Contract 2\dwg\10708A1 - PLAN.dwg, A1, 8/28/2023 6:08:30 PM, zlsgham

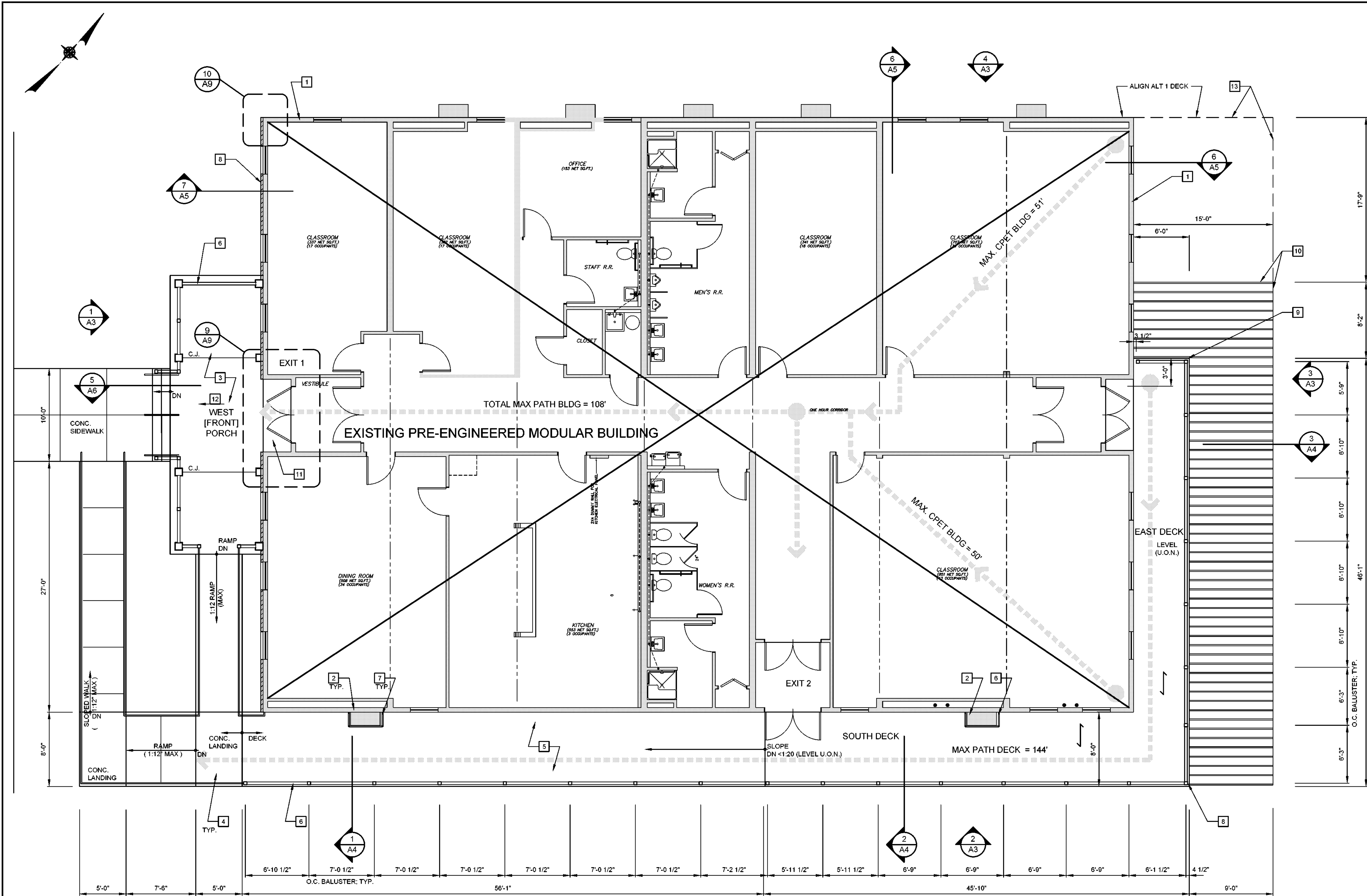

1
A1
CONSTRUCTION PLAN
SCALE: 3/16" = 1'-0"

- GENERAL NOTES:**
- ALL WORK SHALL COMPLY WITH FEDERAL, STATE, AND LOCAL CODES.
 - INSTALL DECK SYSTEM AND RAILINGS PER MANUFACTURER'S RECOMMENDATIONS AND DIRECTIVES.
 - EXISTING PRE-ENGINEERED BUILDING MANUFACTURED BY TITAN MODULAR SYSTEMS, INC.
 - SEE CIVIL DWGS FOR SIDEWALK, RAMP AND LANDING ELEVATIONS.

- KEY NOTES:** #
- EXISTING PRE-ENGINEERED MODULAR BUILDING w/ EXTERIOR STANDING SEAM METAL PANEL FINISH BY OTHERS (EXCEPT FOR WEST ELEVATION FINISHES).
 - EXISTING WALL-MOUNTED AIR CONDITIONING UNITS.
 - CONCRETE PORCH FLOORING AND STEPS WITH A 'BROOM' FINISH.
ADD ALTERNATE BID ITEM # 3
STAMPED CONCRETE FLOORING FINISH. MANUFACTURER: GRUTTADAURO MASONRY LLC. PATTERN: 18"x36" BLUESTONE, OR EQUAL.
 - CONC. SLOPED WALKWAYS ACCESSIBLE RAMPS AND LANDINGS WITH METAL HANDRAILS. SEE CIVIL DWGS. FOR ELEVATIONS.
 - COMPOSITE DECK: TREX (TRANSCEND) COMPOSITE DECKING. BOARD PROFILE TO BE 1" SQUARE-EDGE BOARDS INSTALLED W/ HIDDEN FASTENERS. COLOR: GRAVEL PATH. BOARDS TO BE CUT CLEAN ON BOTH ENDS A MIN. 3/16". NO SPECIAL PATTERN. BOARDS TO RUN PARALLEL TO REAR OF BUILDING.
 - TREX (TRANSCEND) COMPOSITE RAILINGS. COMPOSITE POSTS TO INCLUDE FLAT CAP AND SLEEVE SKIRT. COLOR TO BE DETERMINED. - BALUSTERS TO BE ROUND ALUMINUM IN BLACK. LOWER RAILS TO BE VINTAGE [CLASSIC WHITE] AND UPPER RAIL TO BE [CLASSIC WHITE].
 - 1 1/2" DIA. PIPE RAILINGS BELOW AIR CONDITIONERS; SEE DETAIL 1/A4.
 - THINSTONE RAINSCREEN SYSTEM FIELD APPLIED TO MODULAR BUILDING SHEATHING; SEE ELEVATIONS FOR ADDITIONAL INFORMATION.
 - EXTENT OF BASE BID DECK PLANKING AND RAILINGS UNDER CONTRACT 02 AND DEDUCT ALTERNATE 2
 - EXTENT OF BASE BID DECK SUPPORT FRAMING (FOR FUTURE DECK EXPANSION). BID ITEM 3
 - AT WEST ELEVATION / PORCH ALCOVE INSTALL 2"x2" CERAMIC TILE OVER EXIST PLYWD DECK & FLASHING; PROVIDE BULLNOSE TILE CUT IN 2" SECTIONS TO ALIGN WITH FIELD TILE. LEADING EDGE OF BULLNOSE TO BE INSTALLED AT CONCRETE SLAB EDGE. START FIELD LAYOUT WITH FULL TILES BEHIND BULLNOSE; REFER TO CERAMIC TILE SPEC FOR ADDITIONAL INFORMATION.
 - PITCH PORCH CONCRETE SLAB 1/8" : 12" TO DRAIN.
 - ADD ALTERNATE BID ITEM # 1**
EXTEND DECK TO FULL 15' DEPTH OF FRAMING, DECK AND RAILING TO ALIGN WITH NORTH WALL; SEE NOTE 20 ON DWG A3.

- EGRESS LEGEND:** SEE CODE ANALYSIS DWG A01
- REMOTE POINT
 - PATH OF TRAVEL / TRAVEL DISTANCE
 - DIRECTION OF TRAVEL

- PLAN LEGEND:**
- MODULAR BUILDING WALLS (BY OTHERS)
 - E.I.F.S. FINISH
 - THINSTONE RAINSCREEN FINISH
 - DECK PLANK DIRECTION

| NO. | DATE | REVISION | INT. |
|-----|------|----------|------|
| | | | |
| | | | |
| | | | |
| | | | |
| | | | |

| | |
|--|-----------------------|
| UNAUTHORIZED ALTERATION OR ADDITION TO THIS DOCUMENT IS A VIOLATION OF SECTION 7209 OF THE NEW YORK STATE EDUCATION LAW. | |
| PROJECT ENGINEER: AE | DRAWN BY: DB |
| DESIGNED BY: BA | CHECKED BY: BA/WDM |



| | |
|---------------------------|----------|
| TOWN OF BLOOMING GROVE | |
| ORANGE COUNTY | NEW YORK |
| LASSER PARK SENIOR CENTER | |

| |
|-------------------|
| CONTRACT 2 |
| CONSTRUCTION PLAN |
| ARCHITECTURAL |

| | |
|----------------------|--------------------------|
| PROJECT NO. 5708 | DRAWING NO. A1 |
| DATE: AUGUST 2023 | |
| SCALE: AS NOTED | |