

OWNERSHIP AND USE OF DOCUMENTS:  
DRAWINGS AND SPECIFICATIONS AS INSTRUMENTS OF PROFESSIONAL SERVICE ARE AND SHALL REMAIN THE PROPERTY OF THE ARCHITECT. THESE DOCUMENTS ARE NOT TO BE USED IN WHOLE OR IN PART, FOR ANY OTHER PROJECTS OR PURPOSES, OR BY ANY OTHER PARTIES, THAN THOSE PROPERLY AUTHORIZED BY CONTRACT, WITHOUT THE SPECIFIC WRITTEN AUTHORIZATION OF EASTON ARCHITECTS, LLP.

ROOF MEMBRANE

CONDITION:	GRAPHIC		
STANDING WATER		11	SF
BIOLOGICAL GROWTH		121	SF
DISPLACED INSULATION		317	SF
DISPLACED /REMOVED BALLAST		440	SF
PREVIOUS PATCH REPAIRS/ REPLACEMENT MATERIAL		3	SF

CAST STONE (COPING)

PREVIOUS PATCH REPAIRS/ REPLACEMENT MATERIAL		3	SF
OPEN JOINTS		370	SF

METAL

PEELING PAINT		10	SF
SOILING / STAINING		204	SF

ROOF KEY

	SKYLIGHT
	ACCESS HATCH
	SONIC ALARM
	CHIMNEY
	MECHANICAL UNIT

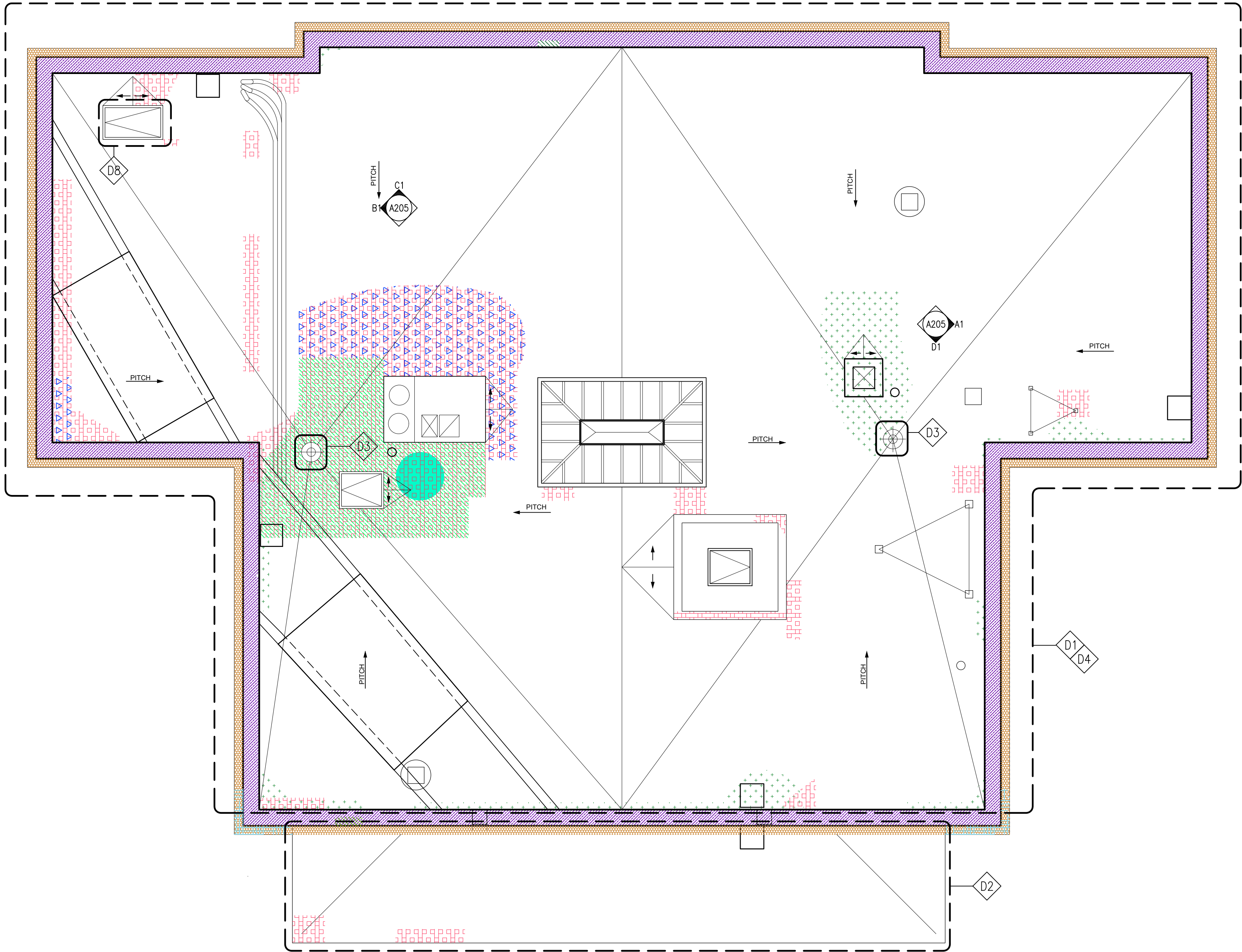

A1

EXISTING CONDITIONS ROOF PLAN

3/16"=1'-0"



PROJECT

HASTINGS-ON-HUDSON  
VILLAGE HALL

PHASE 3: ROOF REPLACEMENT  
AND REPAIRS

7 MAPLE AVE, HASTINGS ON HUDSON, NY 10706

EXISTING CONDITIONS  
ROOF PLAN

SEAL & SIGNATURE  
DATE: 10/31/22  
PROJECT No: 2118  
DRAWING BY: AD  
CHK BY: LE  
DWG No:

A-101.00