

2024 WLHS PPS PROJECT

WESTLAKE MIDDLE / HIGH
SCHOOL

ARCHITECT

MEMASI
2 LYON PLACE
WHITE PLAINS, NY 10601
914.915.9519
MEMASIDESIGN.COM

MEP CONSULTANT
BARILE GALLAGHER & ASSOCIATES
39 MARBLE AVE.
PLEASANTVILLE, NY 10570

STRUCTURAL CONSULTANT
REILLY TARANTINO ENGINEERING
1000 PARK BLVD., SUITE 209
MASSAPEQUA PARK, NY 11762

HAZARDOUS MATERIALS CONSULTANT
QUALITY ENVIRONMENTAL
SOLUTIONS & TECHNOLOGIES, INC.
1376 ROUTE 9
WAPPINGERS FALLS, NY 12590

LIGHTING CONSULTANT
GOLDSTICK LIGHTING DESIGN
629 FIFTH AVE. #204
PELHAM, NY 10803

SITE-CIVIL CONSULTANT
THE LA GROUP
40 LONG ALLEY
SARATOGA SPRINGS, NY 12866

SECURITY CONSULTANT
BUILDING TECHNOLOGY CONSULTING
992 BEDFORD STREET
BRIDGEWATER, MA 02324

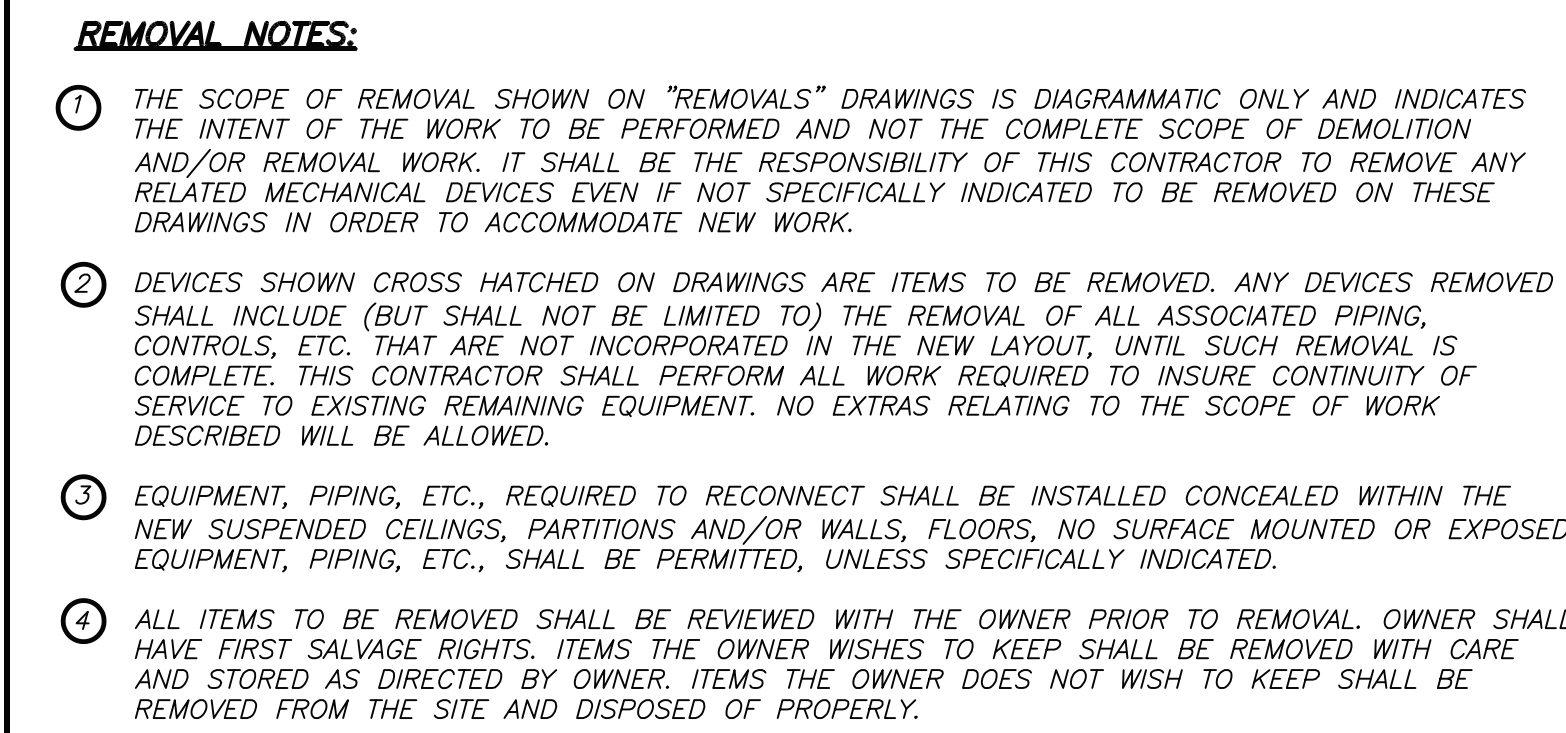

HVAC LEGEND

| | |
|--|---|
| | POINT OF CHANGE IN DUCT SIZE |
| | NEW DUCTWORK |
| | THERMAL/ACOUSTIC LINING-DUCT SIZES ON PLANS ARE CLEAR INSIDE DIMENSIONS |
| | FLEXIBLE CONNECTION |
| | NEW DUCTWORK |
| | POINT OF CHANGE IN DUCT SIZE |
| | SQUARE DUCT TURN WITH TURNING VANES |
| | NEW 4-WAY CEILING DIFFUSER |
| | NEW 4-WAY CEILING DIFFUSER |
| | NEW 2-WAY CEILING DIFFUSER |
| | NEW 2-WAY CEILING DIFFUSER |
| | CEILING EXHAUST/RETURN REGISTER |
| | FIRE-USE SEPARABLE REGISTER/DIFFUSER IDENTIFICATION |
| | DUCT DROP; DUCT RISE |
| | DUCT MTD, MANUAL AIR VOLUME DAMPER (W/LOCKING DEVICE) |
| | MOTORIZED AIR VOLUME DAMPER (W/ACCESS DOOR) |
| | FIRE DAMPER (U.L. APPROVED) & ACCESS DOOR |
| | EXISTING HOT WATER HEATING SUPPLY PIPING |
| | EXISTING HOT WATER RETURN / HOT WATER REVERSE RETURN PIPING |
| | HOT WATER HEATING SUPPLY PIPING |
| | HOT WATER RETURN / HOT WATER REVERSE RETURN PIPING |
| | LIQUID REFRIGERANT PIPING |
| | SUCTION REFRIGERANT PIPING |
| | CONDENSATE DRAIN PIPING |
| | FLOW DIRECTION WITHIN PIPE CONNECTION TO EQUIPMENT ABOVE |
| | GATE VALVE (HORIZONTAL/VERTICAL) |
| | COMBINATION BALANCING & SHUT-OFF VALVE (CIRCUIT SETTER) |
| | 2 - WAY CONTROL VALVE |
| | CHECK VALVES |
| | PIPE CONNS. (BOTTOM; TOP 45 OR 90; PIPE UP) |
| | EXPANSION JOINT, ANCHOR AND GUIDES |
| | CABINET HEATER IDENTIFICATION |
| | ENERGY RECOVERY UNIT IDENTIFICATION |
| | HEAT PUMP UNIT IDENTIFICATION |
| | INDOOR FANCOIL UNIT IDENTIFICATION |
| | FLOW SELECTOR UNIT IDENTIFICATION |
| | CABINET UNIT HEATER IDENTIFICATION |
| | HOT WATER CONVECTOR IDENTIFICATION |
| | HOT WATER COIL IDENTIFICATION |
| | DX COIL IDENTIFICATION |
| | EXHAUST FAN IDENTIFICATION |
| | EXISTING HOT WATER CONVECTOR IDENTIFICATION |
| | EXISTING CEILING RADIATOR IDENTIFICATION |
| | EXISTING SUPPLY AIR FAN IDENTIFICATION |
| | EXISTING FIN TUBE RADIATION IDENTIFICATION |
| | TO CONTINGENT FEM WALL MTD (5'-2"± A.F.F.-U.O.N.) TEMPERATURE SENSOR |
| | DOOR UNDERCUT |
| | CEILING DIFFUSER |
| | CEILING REGISTER |
| | TOP WALL REGISTER |
| | CUBIC FEET PER MINUTE |
| | MOTORIZED CONTROL VALVE |
| | ABOVE FINISHED FLOOR |
| | OUTSIDE (FRESH) AIR INTAKE |
| | HEATING, VENTILATING, AIR CONDITIONING CONTRACTOR |
| | FLEXIBLE CONNECTION |
| | FULL SIZE CONNECTION |
| | ACCESS DOOR |
| | FIRE DAMPER |
| | POINT OF DISCONNECTION |
| | POINT OF CONNECTION, NEW TO EXISTING |
| | SECTION/DETAIL/ELEVATION/PART PLAN NUMBER |
| | DRAWING NUMBER |
| | SECTION/ELEVATION IDENTIFICATION |

[illegible]

KEY PLAN

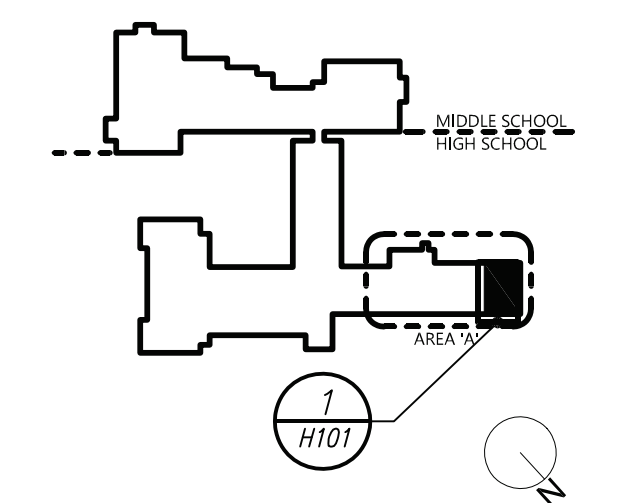

| | |
|--------------------|-----------------------|
| SED PROJECT NO. | 66-08-01-06-0-005-025 |
| MEMASI PROJECT NO. | 107-2201 |

LEGEND, NOTES
& PARTIAL FLOOR
PLAN
PPS

H101

© 2022 MEMASI. ALL RIGHTS RESERVED.

BEFORE FABRICATION THIS CONTRACTOR SHALL
VERIFY ALL MEASUREMENTS AND CONDITIONS ON
JOB AND COORDINATE HIS WORK WITH THE WORK
OF ALL OTHER CONTRACTORS

VRF SYSTEM:
THE CONTRACTOR SHALL RETAIN THE SERVICES OF THE
MANUFACTURER'S REPRESENTATIVE FOR PURPOSES OF PROVIDING
REFRIGERANT PIPING SIZING.

THE CONTRACTOR SHALL PROVIDE ALL CONDENSATE DRAINAGE PIPING FROM ALL CASSETTE UNITS AND ENERGY RECOVERY UNIT, AND DISCHARGE TO EXTERIOR SPLASHBLOCKS.



MEMASI
2 LYON PLACE
WHITE PLAINS, NY 10601
914.915.9519
MEMASIDESIGN.COM

SECURITY CONSULTANT
BUILDING TECHNOLOGY CONSULTING
992 BEDFORD STREET
BRIDGEWATER, MA 02324



© 2022 MEMASI. ALL RIGHTS RESERVED.

BEFORE FABRICATION THIS CONTRACTOR SHALL VERIFY ALL MEASUREMENTS AND CONDITIONS ON JOB AND COORDINATE HIS WORK WITH THE WORK OF ALL OTHER CONTRACTORS

MOUNT PLEASANT
CENTRAL SCHOOL
DISTRICT

2024 WLHS PPS PROJECT

WESTLAKE MIDDLE / HIGH
SCHOOL

ARCHITECT

MEMASI
2 LYON PLACE
WHITE PLAINS, NY 10601
914.915.9519
MEMASIDESIGN.COM

MEP CONSULTANT
BARILE GALLAGHER & ASSOCIATES
39 MARBLE AVE.
PLEASANTVILLE, NY 10570

STRUCTURAL CONSULTANT
REILLY TARANTINO ENGINEERING
1000 PARK BLVD., SUITE 209
MASSAQUEUA PARK, NY 11762

HAZARDOUS MATERIALS CONSULTANT
QUALITY ENVIRONMENTAL
SOLUTIONS & TECHNOLOGIES, INC.
1376 ROUTE 9
WAPPINGERS FALLS, NY 12590

LIGHTING CONSULTANT
GOLDSTICK LIGHTING DESIGN
629 FIFTH AVE. #204
PELHAM, NY 10803

SITE-CIVIL CONSULTANT
THE LA GROUP
40 LONG ALLEY
SARATOGA SPRINGS, NY 12866

SECURITY CONSULTANT
BUILDING TECHNOLOGY CONSULTING
982 BEDFORD STREET
BRIDGEWATER, MA 02324

| SCHEDULE OF MINIMUM VENTILATION ROOM FLOW RATES - MT. PLEASANT HS/MS | | | | | | | | | | | | |
|--|--|--------------------|---------------------------------|---|---|------------------------------------|--------------------------------|---|---|--|---------------------------------------|---|
| | | A | B | C | D | E | F | G | H | I | | |
| ROOM NAME/NUMBER | OCCUPANCY CATEGORY | ROOM AREA (SQ.FT.) | PEOPLE DENSITY (RP/1000 SQ.FT.) | PEOPLE OUTDOOR AIR FLOW RATE (CFM/PERSON) | AREA OUTDOOR AIR FLOW RATE IN BREATHING ZONE (CFM/SQ.FT.) | EXHAUST AIR FLOW RATE (CFM/SQ.FT.) | NUMBER OF PEOPLE (A+B+1000÷#P) | OUTDOOR AIR FLOW RATE WITHOUT ZONE EFFECTIVENESS FACTOR (F×C) (H+A×D)=CFM | ZONE AIR DISTRIBUTION EFFECTIVE SS FACTOR | MINIMUM ROOM VENTILATION AIR FLOW RATE G+H=CFM | MINIMUM EXHAUST AIR FLOW RATE A+E=CFM | |
| Crawl Space | OCCUPIABLE STORAGE ROOMS FOR DRY MATERIALS | 3100 | NOT USED | 2 | 5 | 0.06 | 0 | 7 | 221 | 0.8 | 276 | 0 |
| 007 Makerspace | WOOD/METAL SHOP | 1100 | 20 | 10 | 0.18 | 0.5 | 22 | 418 | 0.8 | 523 | 550 | |
| 007A Woodshop | WOOD/METAL SHOP | 1155 | 20 | 10 | 0.18 | 0.5 | 24 | 448 | 0.8 | 560 | 578 | |
| 007B Storage | OCCUPIABLE STORAGE ROOMS FOR DRY MATERIALS | 50 | 2 | 5 | 0.06 | 0 | 1 | 8 | 0.8 | 10 | 0 | |
| 023 Collaboration Space | OFFICE SPACE | 310 | 5 | 5 | 0.06 | 0 | 4 | 39 | 0.8 | 48 | 0 | |
| 014 Admin | OFFICE SPACE | 170 | 5 | 5 | 0.06 | 0 | 1 | 15 | 0.8 | 19 | 0 | |
| 015 Admin | OFFICE SPACE | 125 | 5 | 5 | 0.06 | 0 | 1 | 13 | 0.8 | 16 | 0 | |
| 020 Conference | CONFERENCE/MEETING | 180 | 50 | 5 | 0.06 | 0 | 9 | 56 | 0.8 | 70 | 0 | |
| 016 Office | OFFICE SPACE | 80 | 5 | 5 | 0.06 | 0 | 2 | 15 | 0.8 | 19 | 0 | |
| 017 ST/Copy | COPY, PRINTING ROOMS | 100 | 0 | 0 | 0 | 0.5 | 0 | 0 | 0.8 | 0 | 50 | |
| 019 Toilet | TOILETS - PUBLIC | 60 | 1 FIXTURES | - | - | 50 CFM/ FIXTURE | - | - | - | - | 50 | |
| 013 Office | OFFICE SPACE | 170 | 5 | 5 | 0.06 | 0 | 1 | 15 | 0.8 | 19 | 0 | |
| 012 Office | OFFICE SPACE | 170 | 5 | 5 | 0.06 | 0 | 1 | 15 | 0.8 | 19 | 0 | |
| 011 Office | OFFICE SPACE | 170 | 5 | 5 | 0.06 | 0 | 1 | 15 | 0.8 | 19 | 0 | |

| SCHEDULE OF EXHAUST FANS | | | | | | | | | | | | |
|--|------------|-----------------|-------------|---------|-----|-------------------------------|-----|------------|------------------|-------------|---------------|-------------|
| MARK | SERVICE | LOCATION | MODEL No. ① | TYPE | CFM | EXT. S.P. IN H ₂ O | RPM | HP (WATTS) | ELECTRIC V/PH/HZ | SIZE (IN) | WEIGHT (LBS.) | REMARKS |
| ② | PPS TOILET | MECHANICAL ROOM | CSP-A200 | IN-LINE | 150 | 0.5 | 825 | (56.8) | 120/1/60 | 14Lx12Wx12H | 23 | REFER TO ②③ |
| | | | | | | | | | | | | |
| NOTES ① AS MANUFACTURED BY "GREENHECK". ② INSTALL PER MANUFACTURER'S RECOMMENDATIONS. ③ PROVIDE VIBRATION ISOLATORS, BACKDRAFT DAMPER, SPEED CONTROL, DISCONNECT SWITCH, AND NAMEPLATE IDENTIFYING FAN MARK, MODEL NO., CFM, RPM, HP, AND ELECTRICAL SERVICE. | | | | | | | | | | | | |

| SCHEDULE OF DUCT MOUNTED D/X COILS | | | | | | | | | | |
|--|----------------|----------------------|----------------------|-------------|-------------|-----|-----------------------|------------------------|------|----------------|
| MARK | SERVICE | D.G. CAPACITY BTU/Hr | M.R. CAPACITY BTU/Hr | E.A.T. (°F) | L.A.T. (°F) | CFM | COIL FACE AREA SQ.FT. | COIL FACE VELOCITY FPM | ROWS | REMARKS |
| ② | PPS RENOVATION | 22,600 | 27,000 | 90 | 58 | 640 | - | 400 | - | REFER TO ①②③④⑤ |
| | | | | | | | | | | |
| NOTES ① AS MANUFACTURED BY "NATIONWIDE COILS INC." ② INSTALL PER MANUFACTURER'S RECOMMENDATIONS. ③ BASED ON A.R.I. CERTIFIED COIL SELECTIONS, REFRIGERANT R-410A. ④ PROVIDE DUCT MOUNTED CASED DX COOLING/HEATING COIL SECTION SUPPORTED FROM STRUCTURE ABOVE, MOUNTING HARDWARE, ACCESS DOORS ON BOTH SIDES OF COIL, ASSOCIATED PIPING, CONTROLS AND APPURTENANCES. ⑤ PROVIDE EEV KIT AND COMMUNICATION KIT FOR D/X COIL OPERATION WITH LG VRF SYSTEM. KITS SHALL BE FIELD INSTALLED. AHU KIT REQUIRES 208/1/60 POWER. | | | | | | | | | | |

| SCHEDULE OF VRF DUCTLESS HEAT RECOVERY INDOOR UNITS | | | | | | | | | | | | |
|---|--|-------------|-----------------|--------------|------------------|---------------------|---------------------|-------------------|------------------|-------------------|---------------|---------|
| INDOOR AIR HANDLER INFORMATION | | | | | | | | | | | | |
| GENERAL DATA | | | SUPPLY FAN DATA | | | COOLING COIL DATA ① | | | HEATING | | | REMARKS |
| MARK | LOCATION | MODEL No. ① | HIGH CFM | MOTOR (AMPS) | ELECTRIC SERVICE | TOTAL CAP BTU/HR | SENSIBLE CAP BTU/HR | ENT. AIR TEMP. °F | TOTAL CAP BTU/HR | ENT. AIR TEMP. °F | | |
| ② | CEILING | ARNU093TRD4 | 283 | 0.20 | 208/1/60 | 9,600 | 9,000 | 77 / 57 | 10,900 | 59 | | |
| | | | | | | | | | | | REFER TO ③④⑤⑥ | |
| NOTES | ① AS MANUFACTURED BY "L.G." (KLIMA NEW YORK 914 255-4390) | | | | | | | | | | | |
| | ② INSTALL PER MANUFACTURER'S RECOMMENDATIONS. | | | | | | | | | | | |
| | ③ BASED ON A.R.I. CERTIFIED COIL SELECTIONS; REFRIGERANT R-410A. | | | | | | | | | | | |
| | ④ PROVIDE FACTORY MOUNTED INTEGRAL CONDENSATE PUMP, CHECK VALVE, ANTI SWEAT SLEEVE AND AUTO SHUTDOWN OVERFLOW SWITCH. | | | | | | | | | | | |
| | ⑤ PROVIDE MOUNTING HARDWARE, VIBRATION ISOLATORS, DISCONNECT, AND HARDWIRED REMOTE WALL MOUNTED THIRD PARTY CONTROLLER/THERMOSTAT. | | | | | | | | | | | |
| ⑥ THE VRF SYSTEM SHALL BE ABLE TO INTEGRATE WITH THE BUILDING MANAGEMENT SYSTEM VIA BACNET IP GATEWAY; THIS GATEWAY CONVERTS BETWEEN BACNET IP OR MODBUS TCP PROTOCOL, AND RS-485 LGAP (LG AIRCON PROTOCOL) ALLOWING THIRD PARTY CONTROL AND MONITORING OF THE LG A/C SYSTEM, OR LOWWORKS GATEWAYS. | | | | | | | | | | | | |

| SCHEDULE OF CABINET HEATERS | | | | | | | | | | | | | |
|--|------|--------|-------------|---------------|-----|-----|--------------|-------------|-----------|------------------|----------------|--|--|
| MARK | TYPE | UNIT | MODEL No. ① | CAPACITY DATA | | | MOTOR PD.FT. | MOTOR WATTS | MOTOR RPM | ELECTRIC SERVICE | REMARKS | | |
| | | | | MBH | CFM | GPM | | | | | | | |
| ② | WALL | W 1070 | 0.3 | 22.7 | 335 | 2.0 | 0.26 | 1/15 | 1050 | 120/1/60 | REFER TO ②③④⑤⑥ | | |
| | | | | | | | | | | | | | |
| NOTES ① AS MANUFACTURED BY "STERLING". ② INSTALL PER MANUFACTURER'S RECOMMENDATIONS. ③ CAPACITIES BASED ON LOW SPEED FAN SETTING, AND 170 A.W.T. ④ PROVIDE 2 ROW COIL, THROWAWAY FILTERS, INTEGRAL SPEED CONTROL, DISCONNECT SWITCH, REMOTE WALL SENSOR CONNECTED TO BMS, GASKET AND PERMA LAP FRAME. COORDINATE FINISH AND COLOR WITH ARCHITECT. ⑤ UNIT DIMENSIONS 36"x25"x9.5", WEIGHT 150 LBS. ⑥ PROVIDE WITH HOT WATER RETURN AQUASTAT. AQUASTAT SHALL NOT ALLOW FAN TO OPERATE AT WATER TEMPERATURE BELOW 98 DEGREES F. | | | | | | | | | | | | | |

| SCHEDULE OF ENERGY RECOVERY UNITS | | | | | | | | | | | | | | | | | | | | | | | | | |
|-----------------------------------|----------------|-------------|-----|-------------|-----------------|----------|--------------|----------------------|----------|--------------|-----------------|-----|--------------------|----------------|------------------------|-------------------------------|--------------------|-----------|-----------|-----|------------|------------------------|----------------|--|--|
| GENERAL DATA | | | | | SUPPLY FAN DATA | | | RETURN-EXH. FAN DATA | | | ELECTRICAL DATA | | | HEAT EXCHANGER | | HOT WATER HEATING COIL DATA ① | | | | | FILTER | PHYSICAL DATA | REMARKS | | |
| MARK | SERVICE | LOCATION | OA | MODEL No. ① | CFM | MOTOR HP | E.S.P. IN WG | CFM | MOTOR HP | E.S.P. IN WG | MCA | MOP | ELECTRICAL SERVICE | MODEL | THERMAL EFFICIENCY (%) | MARK | CAPACITY TOTAL MBH | E.A.T. °F | L.A.T. °F | GPM | TYPE | LxHxW(in.)/WEIGHT(lbs) | | | |
| ERV1 | PPS RENOVATION | PPS CEILING | 640 | U-ERV-600 | 640 | - | 1.0 | 550 | - | 0.75 | 8.3 | 15 | 208/1/60 | HEAT WHEEL | 75 | HW1 | - | - | - | - | 2" MERV 13 | 57x12x69/96 | REFER TO ②③④⑤⑥ | | |
| | | | | | | | | | | | | | | | | | | | | | | | | | |

NOTES

①

AS MANUFACTURED BY "ENERGYWALL" (KLIMA NEW YORK 914 255-4390)

②

INSTALL PER MANUFACTURER'S RECOMMENDATIONS.

③

DUCT MOUNTED COIL BASED ON ENTERING/LEAVING WATER TEMPERATURES HW 180/160°

④

PROVIDE UNIT WITH MERV 13 FILTERS, DX VRF COOLING/HEATING COIL WITH DRAIN PAN, ECM MOTORS, 100% ECONOMIZER, DRY CONTACTS FOR DIRTY FILTER INDICATOR, FROST CONTROL, PHASE PROTECTION, DISCONNECT SWITCH, AND MOTORIZED DAMPERS FOR OA, EA.

⑤

PROVIDE EEV KIT AND COMMUNICATION KIT FOR D/X COIL OPERATION WITH LG VRF SYSTEM.

⑥

INDICATED EQUIPMENT DESIGNATIONS ARE FOR USE IN CONSTRUCTION ONLY. CONTRACTOR SHALL COORDINATE WITH OWNER ON DESIRED FINAL TAG IDENTIFICATION/NUMBERING/LETTERING. OWNER APPROVED DESIGNATIONS SHALL BE USED IN BMS PROGRAMMING AND ON PERMANENT EQUIPMENT IDENTIFICATION TAGS. AS-BUILT DRAWINGS SHALL BE UPDATED WITH FINAL IDENTIFICATION TAG DESIGNATIONS.

| SCHEDULE OF DUCT MOUNTED HOT WATER HEATING COILS | | | | | | | | | | | | |
|--|----------------|----------------------|-------------|-------------|----------|----------|-----|-----|-----------------------|------------------------|------|------------------|
| MARK | SERVICE | M.R. CAPACITY BTU/Hr | E.A.T. (°F) | L.A.T. (°F) | DMT (°F) | LMT (°F) | GPM | CFM | COIL FACE AREA SQ.FT. | COIL FACE VELOCITY FPM | ROWS | REMARKS |
| ② | PPS RENOVATION | 55,300 | 10 | 90 | 180 | 160 | 4.8 | 640 | - | 500 | - | REFER TO ①②③④⑤⑥⑦ |
| | | | | | | | | | | | | |
| NOTES ① AS MANUFACTURED BY "NATIONWIDE COILS INC." ② AIR PRESSURE DROP ACROSS COIL SHALL NOT EXCEED 0.30" S.P. ③ INSTALL PER MANUFACTURER'S RECOMMENDATIONS. ④ COIL SHALL BE MINIMUM 2 ROWS WITH MINIMUM OF 8 FINS PER INCH. ⑤ 5/8" TUBE AND ALUMINUM FINS. ⑥ GALVANIZED PITCHED CASING. ⑦ THE WATER COIL IS SIZED TO HANDLE OUTDOOR AIR QUANTITIES AT 100 PERCENT (WITH ENERGY RECOVERY UNIT IN OPERATION) OF OCCUPANCY WITHOUT HAVING TO RESORT TO CLOSING OUTDOOR AIR INTAKE DAMPERS ON A "DESIGN HEATING DAY" TO PREVENT FREEZE-UP. | | | | | | | | | | | | |

| SCHEDULE OF VRF FLOW SELECTOR UNITS | | | | | | | | | | |
|---|-------------|------------------------|------------|--------|------|------------------|---------------|--------------|--------------|--|
| MARK | MODEL No. ① | CAPACITY DATA (BTU/HR) | | | MCA | ELECTRIC SERVICE | PHYSICAL DATA | | REMARKS | |
| | | UNIT | PORTS EACH | PORT | | | LxWxH (IN) | WEIGHT (LBS) | | |
| ② | PRHR023A | 120,000 | 2 | 60,000 | 0.17 | 208/1/60 | 19X19X9 | 35 | REFER TO ②③④ | |
| ② | PRHR033A | 180,000 | 3 | 60,000 | 0.17 | 208/1/60 | 19X19X9 | 38 | REFER TO ②③④ | |
| ② | PRHR043A | 230,000 | 4 | 60,000 | 0.17 | 208/1/60 | 19X19X9 | 40 | REFER TO ②③④ | |
| | | | | | | | | | | |
| NOTES ① AS MANUFACTURED BY "L.G." (KLIMA NEW YORK 914 255-4390) ② INSTALL PER MANUFACTURER'S RECOMMENDATIONS. ③ REFRIGERANT R-410A. ④ PROVIDE MOUNTING HARDWARE. MOUNT UNIT HORIZONTALLY. | | | | | | | | | | |

BEFORE FABRICATION THIS CONTRACTOR SHALL VERIFY ALL MEASUREMENTS AND CONDITIONS ON JOB AND COORDINATE HIS WORK WITH THE WORK OF ALL OTHER CONTRACTORS

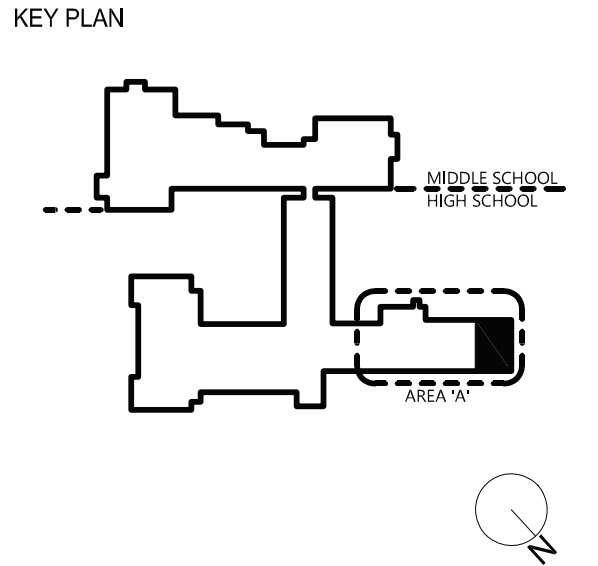

SED PROJECT NO.
MEMASI PROJECT NO.

SCHEDULES

H301

© 2022 MEMASI. ALL RIGHTS RESERVED.

MOUNT PLEASANT
CENTRAL SCHOOL
DISTRICT

2024 WLHS PPS PROJECT

WESTLAKE MIDDLE / HIGH
SCHOOL

ARCHITECT

MEMASI

2 LYON PLACE
WHITE PLAINS, NY 10601
914.915.9519
MEMASIDESIGN.COM

MEP CONSULTANT
BARILE GALLAGHER & ASSOCIATES
39 MARBLE AVE.
PLEASANTVILLE, NY 10570

STRUCTURAL CONSULTANT
REILLY TARANTINO ENGINEERING
1000 PARK BLVD., SUITE 209
MASSAPEQUA PARK, NY 11762

HAZARDOUS MATERIALS CONSULTANT
QUALITY ENVIORNMENTAL
SOLUTIONS & TECHNOLOGIES, INC.
1376 ROUTE 9
WAPPINGERS FALLS, NY 12590

LIGHTING CONSULTANT
GOLDSTICK LIGHTING DESIGN
629 FIFTH AVE. #204
PELHAM, NY 10803

SITE-CIVIL CONSULTANT
THE LA GROUP
40 LONG ALLEY
SARATOGA SPRINGS, NY 12866

SECURITY CONSULTANT
BUILDING TECHNOLOGY CONSULTING
982 BEDFORD STREET
BRIDGEWATER, MA 02324

LEGEND

| | |
|--|---|
| | EXISTING PIPING, FIXTURES, ETC. TO REMAIN |
| | NEW PIPING, FIXTURES, ETC. |
| | COLD WATER PIPING |
| | HOT WATER PIPING |
| | HOT RETURN WATER PIPING |
| | PD PUMP DISCHARGE |
| | PLUMBING VENT PIPING |
| | ESAN EXISTING SANITARY PIPING (UNDERGROUND) |
| | EST EXISTING STORM PIPING |
| | EST EXISTING STORM PIPING (UNDERGROUND) |
| | SAN SANITARY PIPING |
| | SAN SANITARY PIPING (UNDERGROUND) |
| | ST STORM PIPING |
| | EG EXISTING GAS PIPING |
| | ESP EXISTING SPRINKLER PIPING |
| | FLOW DIRECTION WITHIN PIPE |
| | CLEANOUT |
| | CLEANOUT DECK PLATE |
| | GATE VALVE |
| | COMBINATION BALANCING & SHUT-OFF VALVE |
| | OS & Y VALVE |
| | CHECK VALVE |
| | GAS SHUT OFF COCK |
| | PIPE CONNS. (BOTTOM, TOP 45 OR 90; PIPE UP) |
| | PLUMBING FIXTURE IDENTIFICATION |
| | SEWAGE EJECTOR IDENTIFICATION |
| | PLUMBING CONTRACTOR |
| | GENERAL CONTRACTOR |
| | HVAC CONTRACTOR |
| | VENT THRU ROOF |
| | FRESH AIR INTAKE |
| | FLOOR DRAIN |
| | PRESSURE REDUCING VALVE |
| | POINT OF DISCONNECTION |
| | POINT OF CONNECTION, NEW TO EXISTING |
| | PART PLAN, DETAIL, SECTION NUMBER |
| | DRAWING NUMBER |
| | SECTION IDENTIFICATION |

PLUMBING FIXTURE SCHEDULE

| MARK | DESCRIPTION | BRANCH SIZE | | | |
|------|---|-------------|--------|------|------|
| | | W | V | 1" | 2" |
| A | WALL MOUNTED WATER CLOSET (FLUSH VALVE) (HANDICAPPED) | 4" | 2" | — | 1" |
| B | FLOOR MOUNTED LAVATORY (HANDICAPPED) | 2" | 1-1/2" | 3/4" | 3/4" |
| C | RECESSED BOTTLE FILLER (HANDICAPPED) | 2" | 1-1/2" | — | 3/4" |
| X | EXISTING FIXTURE TO BE REMOVED | — | — | — | — |
| R | EXISTING FIXTURE TO REMAIN | — | — | — | — |

REMOVAL NOTES

- REMOVE ALL PLUMBING FIXTURES, EQUIPMENT, SPECIALTIES, DRAINS, CONTROLS, HANGERS, BASES, SUPPORTS, PIPING, VALVES, TUBING AND PLUMBING ACCESSORIES THAT ARE NOT INCORPORATED IN THE NEW LAYOUT.
- WHERE REMOVAL IS INDICATED OR IMPLIED OR NOT INCORPORATED IN INCLUDES ALL GAS, SANITARY, VENT, WATER, ACID WASTE AND PUMP DISCHARGE PIPING. REFER TO DIVISION 1 OF SPECIFICATION THE NEW LAYOUT, THE ITEM ITSELF IS TO BE REMOVED COMPLETELY TOGETHER WITH ALL CONNECTING PIPING, SPECIALTIES, SUPPORTS, FOR CUTTING AND PATCHING REQUIREMENTS. CONTROLS, ETC, CONNECTING PIPING IS TO BE REMOVED BACK TO MAINS WHERE THE ARE TO BE CAPPED OR DISCONNECTED. THIS
- WHERE EXISTING PIPING ENTERS INACCESSIBLE TRENCHES, TUNNELS, SHAFTS, WALLS AND CEILINGS INSIDE THE EXISTING BUILDING, IT SHALL BE CUT BACK AT LEAST 2" INTO SUCH INACCESSIBLE SPACES AND SHALL BE SUITABLY CAPPED AND SEALED BY THE CONTRACTOR.
- THE CONTRACTOR SHALL EXERCISE NORMAL CAUTION TO PREVENT UNNECESSARY CUTTING AND DAMAGE TO THE EXISTING BUILDING. ANY EXCESSIVE DAMAGE AS DETERMINED BY THE OWNER SHALL BE REPAIRED AND PAID FOR BY THE CONTRACTOR CAUSING THE DAMAGE.
- ALL DEMOLISHED EQUIPMENT ETC, EXCEPT THOSE ITEMS SPECIFICALLY REQUESTED BY THE OWNER SHALL BECOME THE CONTRACTOR'S PROPERTY, SHALL BE REMOVED FROM THE PREMISES, AND DISPOSED OF LEGALLY.

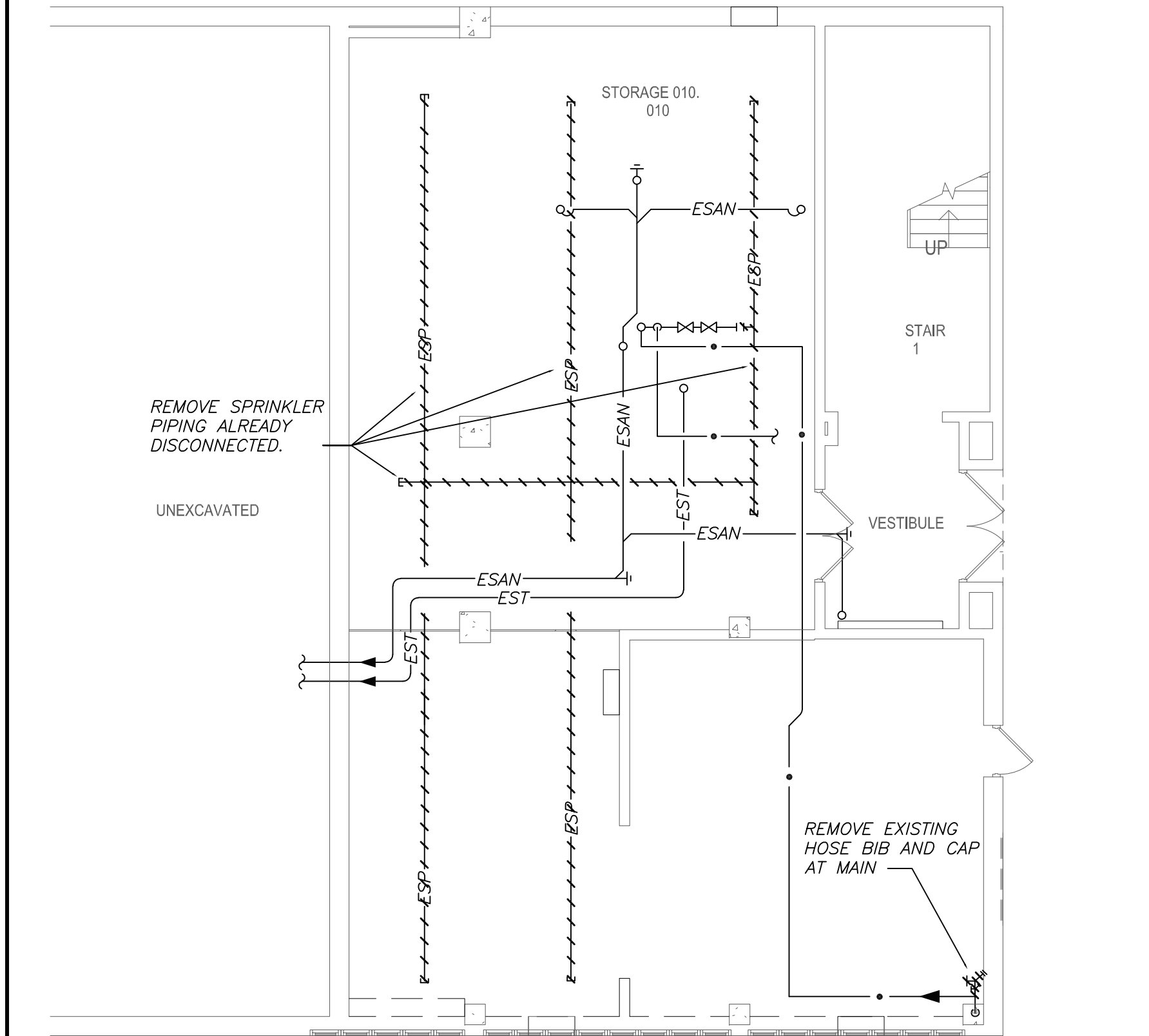

HS PPS PART FLOOR PLAN
(REMOVALS)

1
P101

BEFORE FABRICATION THIS CONTRACTOR SHALL
VERIFY ALL MEASUREMENTS AND CONDITIONS ON
JOB AND COORDINATE HIS WORK WITH THE WORK
OF ALL OTHER CONTRACTORS

SEAL

ISSUED FOR BID 08/21/2024
ISSUE DATE

KEY PLAN

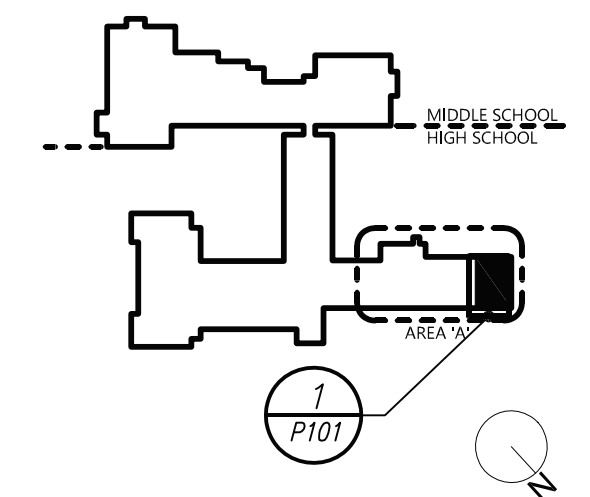

SED PROJECT NO.
MEMASI PROJECT NO.

LEGEND, NOTES
& PARTIAL FLOOR
PLAN
PPS

P101

© 2022 MEMASI. ALL RIGHTS RESERVED.