

SCHEDULE OF ENERGY RECOVERY UNITS																																	
GENERAL DATA				SUPPLY FAN DATA		EXH. FAN DATA		ELECTRICAL DATA		HEAT EXCHANGER		HW PREHEATER DATA ③				HW POSTHEATER DATA ③				FILTER	PHYSICAL DATA	REMARKS											
MARK	SERVICE	LOCATION	MODEL No. ①	CFM	E.S.P. IN WG	CFM	E.S.P. IN WG	MCA	MOP	ELECTRICAL SERVICE	MODEL	THERMAL EFFICIENCY (%)	CAPACITY TOTAL MBH	E.A.T. °F	L.A.T. °F	GPM	CAPACITY TOTAL MBH	E.A.T. °F	L.A.T. °F	GPM	TYPE		LxWxH(in.)/WEIGHT(lbs)										
ERU 1	ADDITION	MECH 102M	TR4000HW 208-3-CAV	4000	1.25	4000	1.25	20.3	25	208/3/60	HEAT WHEEL	75	92.8	26	47	9.3	101.3	47	70	10.1	2" MERV 13	76x58x82/1650	REFER TO ②④⑤										
NOTES	①	AS MANUFACTURED BY "SYSTEMAIR".										④	PROVIDE 100% OA ERU WITH MERV 13 FILTERS, INTEGRAL HOT WATER COILS, VIBRATION ISOLATORS, ECM MOTORS, 100% ECONOMIZER, DRY CONTACTS FOR DIRTY FILTER INDICATOR, FROST CONTROL, PHASE PROTECTION, AND MOTORIZED DAMPERS FOR OA, EA & ECONOMIZER FUNCTION.										⑤	INDICATED EQUIPMENT DESIGNATIONS ARE FOR USE IN CONSTRUCTION ONLY. CONTRACTOR SHALL COORDINATE WITH OWNER ON DESIRED FINAL TAG IDENTIFICATION/NUMBERING/LETTERING. OWNER APPROVED DESIGNATIONS SHALL BE USED IN BMS PROGRAMMING AND ON PERMANENT EQUIPMENT IDENTIFICATION TAGS. AS-BUILT DRAWINGS SHALL BE UPDATED WITH FINAL IDENTIFICATION TAG DESIGNATIONS.									
	②	INSTALL PER MANUFACTURER'S RECOMMENDATIONS.																															
	③	BASED ON ENTERING/LEAVING WATER TEMPERATURES HW 180/160°.																															

SCHEDULE OF CABINET HEATERS											
MARK	TYPE UNIT	MODEL No. ①	CAPACITY DATA				MOTOR HP	MOTOR RPM	ELECTRIC SERVICE	REMARKS	
			MBH	CFM	GPM	P.D.F.T.				REFER TO	
CH 4	CEILING MTD.	RC 1200 03	22.7	335	2.0	0.25	1/15	1050	120/1/60	2③④⑤⑥	
NOTES ① AS MANUFACTURED BY "STERLING". ② INSTALL PER MANUFACTURER'S RECOMMENDATIONS. ③ CAPACITIES BASED ON HIGH SPEED FAN SETTING, AND 200 °F E.W.T. ④ PROVIDE 2 ROW COIL, THROWAWAY FILTERS, INTEGRAL SPEED CONTROL, DISCONNECT SWITCH, REMOTE WALL SENSOR, GASKET AND PERMA LAP FRAME. COORDINATE FINISH AND COLOR PER ARCHITECT. ⑤ UNIT DIMENSIONS 36"x25"x9.5", WEIGHT 150 LBS. ⑥ PROVIDE WITH HOT WATER RETURN AQUASTAT. AQUASTAT SHALL NOT ALLOW FAN TO OPERATE AT WATER TEMPERATURE BELOW 98 DEGREES F.											

SCHEDULE OF HOT WATER UNIT HEATERS											
MARK	MODEL No. ①	CAPACITY DATA		MOTOR HP	MCA	ELECTRIC SERVICE	PHYSICAL DATA		MTG.	REMARKS	
		BTU/HR	AMP				LxWxH (IN)	WEIGHT (LBS)		REFER TO	
UH 4	HS-024B	17,400	0.8	16W	1.0	115/1/60	15X10X18	30	CEILING	2③④	
UH 5	HS-048B	34,800	1.4	1/20	1.8	115/1/60	18X12X21	45	CEILING	REFER TO 2③④	
UH 6	HS-096B	69,700	2.2	1/12	2.8	115/1/60	20X14X24	50	CEILING	REFER TO 2③④	
NOTES ① AS MANUFACTURED BY "STERLING". ② INSTALL PER MANUFACTURER'S RECOMMENDATIONS. ③ PROVIDE UNIT MOUNTED VARIABLE SPEED CONTROLLER AND MOUNTING HARDWARE. ④ PROVIDE ALL REQUIRED POWER RELAYS.											

SCHEDULE OF DEDICATED DUCTLESS SPLIT SYSTEMS																						
GENERAL DATA			OUTDOOR UNIT										INDOOR UNIT									
MARK	SERVICE	MODEL No. ①	COOLING (MBH)	HEATING (MBH)	LOCATION	L	D	H	UNIT WEIGHT (POUNDS)	SERVICE	MCA	MOCP	MARK	MAX CFM	MOUNTING LOCATION	LOCATION	L	D	H	UNIT WEIGHT (POUNDS)	REMARKS	
DS1 1	ELEC ROOM	LS363HLV3	33.0	35.2	GRADE	38	13	33	165	208/1/60	23	30	DS1 1	1,166	HIGH WALL	ELEC ROOM	48	11	15	50	REFER TO 2③④⑤	
DS2 2	DATA ROOM	LS363HLV3	33.0	35.2	GRADE	38	13	33	165	208/1/60	23	30	DS2 2	1,166	HIGH WALL	DATA ROOM	48	11	15	50	REFER TO 2③④⑤	
NOTES ① AS MANUFACTURED BY "LG". (KLIMA NEW YORK 914 255-4390) ② INSTALL PER MANUFACTURER'S RECOMMENDATIONS. ③ PROVIDE PROGRAMMABLE THERMOSTAT, LOW AMBIENT CONTROL, MOUNTING HARDWARE AND VIBRATION ISOLATORS. ④ REFRIGERANT R410-A. ⑤ INDOOR UNIT POWERED BY OUTDOOR UNIT.																						

NOT IN SCOPE,  
BY OWNER

SCHEDULE OF MINIMUM VENTILATION ROOM FLOW RATES											
ROOM NAME/NUMBER	OCCUPANCY CATEGORY	ROOM AREA (SQ.FT.)	PEOPLE DENSITY (#P/1000 SQ.FT.)	PEOPLE OUTDOOR AIR FLOW RATE (CFM/PERSON)	AREA OUTDOOR AIR FLOW RATE IN BREATHING ZONE (CFM/SQ.FT.)	EXHAUST AIR FLOW RATE (CFM/SQ.FT.)	NUMBER OF PEOPLE (A*B)*1000=#P	OUTDOOR AIR FLOW RATE WITHOUT ZONE EFFECTIVENESS FACTOR (F*C)*(A*D)=CFM	ZONE AIR DISTRIBUTION EFFECTIVENESS FACTOR	MINIMUM ROOM VENTILATION AIR FLOW RATE G+H=CFM	MINIMUM EXHAUST AIR FLOW RATE A+E=CFM
Office 1 / 108	OFFICE SPACE	175	5	5	0.06	0	1	16	0.8	19	0
Office 2 / 109	OFFICE SPACE	175	5	5	0.06	0	1	16	0.8	19	0
Office 3 / 110	OFFICE SPACE	175	5	5	0.06	0	1	16	0.8	19	0
Kitchen / 014	KITCHEN (COOKING)	300	20	7.5	0.12	0.7	6	81	0.8	101	210
Apparatus Bays / 002	PARKING GARAGES	2005	0	0	0	0.9	0	0	0.8	0	1805
Storage / 003	OCCUPIABLE STORAGE ROOMS FOR LIQUID OR GELS	370	2	5	0.12	0	1	49	0.8	62	0
Apparatus Bays / 103	PARKING GARAGES	2130	0	0	0	0.9	0	0	0.8	0	1917
Storage / 103A	OCCUPIABLE STORAGE ROOMS FOR LIQUID OR GELS	675	2	5	0.12	0	2	91	0.8	114	0

SCHEDULE OF OUTDOOR AIR SOURCE HEAT PUMPS													
GENERAL DATA				CAPACITY		PHYSICAL DATA		ELECTRICAL INFORMATION			EER	SEER	REMARKS
MARK	SERVICE	LOCATION	MODEL No. ①	COOLING CAPACITY BTU/HR	HEATING CAPACITY BTU/HR	DxWxH (IN)	WEIGHT (LBS)	V/PH/HZ	MCA	MOCp			
HP 1	OFFICES	GRADE	MULTI V S ARUN048GSS4	48,000	54,000	38x13x55	225	208/1/60	30	50	13.2	20	REFER TO ②③④⑤⑥⑦

NOTES

①

AS MANUFACTURED BY "LG.".

②

BASED ON A.R.I. CERTIFIED COIL SELECTIONS; REFRIGERANT R-410A.

③

INSTALL ACCORDING TO MANUFACTURER'S RECOMMENDATIONS.

④

PROVIDE DC INVERTER COMPRESSOR SPEED CONTROL BASED ON SYSTEM LOAD.

⑤

PROVIDE PROGRAMMABLE THERMOSTAT, LOW AMBIENT CONTROL, HARD START, AND CRANKCASE HEATER.

⑥

INSTALL ON CONCRETE PAD FURNISHED BY OTHERS.

⑦

INDICATED EQUIPMENT DESIGNATIONS ARE FOR USE IN CONSTRUCTION ONLY. CONTRACTOR SHALL COORDINATE WITH OWNER ON DESIRED FINAL TAG IDENTIFICATION/NUMBERING/LETTERING. OWNER APPROVED DESIGNATIONS SHALL BE USED IN BMS PROGRAMMING AND ON PERMANENT EQUIPMENT IDENTIFICATION TAGS. AS-BUILT DRAWINGS SHALL BE UPDATED WITH FINAL IDENTIFICATION TAG DESIGNATIONS.

NOT IN SCOPE,  
BY OWNER

SCHEDULE OF VRF HEAT RECOVERY INDOOR UNITS											
GENERAL DATA			INDOOR AIR HANDLER INFORMATION								REMARKS
MARK	LOCATION	MODEL No. ①	SUPPLY FAN DATA		COOLING COIL DATA ②		HEATING				
			HIGH CFM	MOTOR (AMPS)	TOTAL CAP SENSIBLE CAP BTU/HR	ENT. AIR TEMP DB/WH	TOTAL CAP. ENT. AIR BTU/HR	ENT. AIR TEMP			
EC 4	CEILING	ARNU153TQD4	530	2.09	208/1/60	15,400	11,400	80/67	17,100	70	REFER TO 2③④⑤
NOTES ① AS MANUFACTURED BY "LG.". ② PROVIDE FACTORY MOUNTED INTEGRAL CONDENSATE PUMP, CHECK VALVE, ANTI SWEAT SLEEVE, AND AUTO SHUTDOWN OVERFLOW SWITCH.											

FIREHOUSE  
ADDITIONS & ALTERATIONS



Pound Ridge Fire Department  
Pound Ridge, New York

**KG+D** listen imagine build  
KG+D . ARCHITECTS PC  
285 MAIN STREET MOUNT KISCO . NEW YORK . 10549  
P:914.666.5900 KGDARCHITECTS.COM

**bgo**  
BARILE GALLAGHER & ASSOCIATES  
CONSULTING ENGINEERS  
39 MARBLE AVE. PLEASANTVILLE, NY 10570  
PHONE: 914.338.0900 FAX: 914.338.0901 Gemail:BG@bgo.com

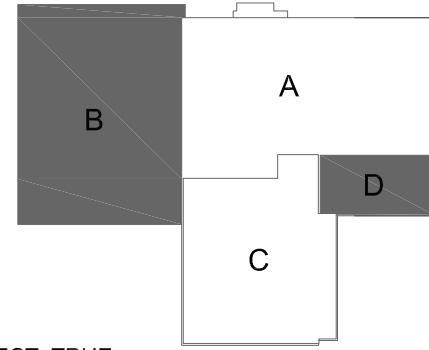

PROJECT TRUE  
NORTH NORTH  
KEY PLAN

NOTE: ALL IDEAS, DESIGNS, ARRANGEMENTS AND PLANS INDICATED OR REPRESENTED BY THIS DRAWING ARE OWNED BY AND ARE THE PROPERTY OF KAPTEK, GARNETT & DAVISON ARCHITECTS, PC (KGAD), AND WERE CREATED FOR USE ON THIS PROJECT. NONE OF SUCH IDEAS, DESIGNS, ARRANGEMENTS OR PLANS SHALL BE USED BY OR DISCLOSED TO ANY PURPOSE WHATSOEVER WITHOUT THE WRITTEN PERMISSION OF (KGAD).

WRITTEN DIMENSIONS ON THIS DRAWING SHALL HAVE PRECEDENCE OVER SCALED DIMENSIONS. CONTRACTOR SHALL VERIFY ALL ACTUAL DIMENSIONS AND CONDITIONS ON THE JOB AND THE ARCHITECT MUST BE NOTIFIED OF ANY VARIATIONS FROM DIMENSIONS AND CONDITIONS SHOWN. SHOP DETAILS MUST BE SUBMITTED TO THIS OFFICE FOR APPROVAL BEFORE PROCEEDING WITH FABRICATION.

ALTERATIONS BY ANY PERSON, IN ANY WAY, OF ANY ITEM CONTAINED ON THIS DOCUMENT, UNLESS ACTING UNDER THE DIRECTION OF THE LICENSED ARCHITECT WHOSE PROFESSIONAL SEAL IS AFFIXED HERETO, IS A VIOLATION OF TITLE VII, SECT. 60.0 (b) OF NEW YORK STATE LAW. COPYRIGHT KAPTEK, GARNETT & DAVISON ARCHITECTS & ENGINEERS, PC. ALL RIGHTS RESERVED.

Professional Seal



No.	Date	Issue
6	06-11-2024	CONSTRUCTION DOCUMENTS
5	04-26-2024	ICC REVISION 2
4	03-18-2024	ICC REVISION 1
3	02-02-2024	ISSUED TO ICC
2	11-03-2023	DESIGN DEVELOPMENT
1	07-29-2023	SCHEMATIC DESIGN

Sheet Title

SCHEDULES

Job No.	2330.00	Date	03/19/24
Scale	AS NOTED	Drawn / Checked	BGA / BGA
Sheet Number	H301		