

- Keyed Notes:**
- 1 REMOVE THE CEILING DEVICES, PRESERVE CIRCUITRY AND STORE FOR REINSTALLATION, EXCEPT DEMOLISHED LUMINAIRES, EXITS AND OCCUPANCY SENSORS. COORDINATE ALL WORK WITH GENERAL CONTRACTOR.
 - 2 PROVIDE LUMINAIRES AND CONNECT THEM TO THE PREVIOUSLY PRESERVED CIRCUITRY AND KEYED SWITCHES. EXTEND/MODIFY AS NECESSARY.

- General Notes:**
- REFER TO DRAWING AE050 FOR GENERAL NOTES
 - REFER TO AE600 PANEL BOARD SCHEDULES FOR ADDITIONAL INFORMATION
 - LIGHTING CONTROL SEQUENCES:
CORRIDORS:
PERSON ENTERS THE AREA, LUMINAIRES TURN ON TO 100% OUTPUT AUTOMATICALLY BY OCCUPANCY SENSOR. PERSON EXITS THE AREA, LUMINAIRES DIM TO 50% OUTPUT (MAINTAINING EGRESS LEVEL ILLUMINATION). MANUAL CONTROL BY EXISTING LINE VOLTAGE KEYED SWITCH.

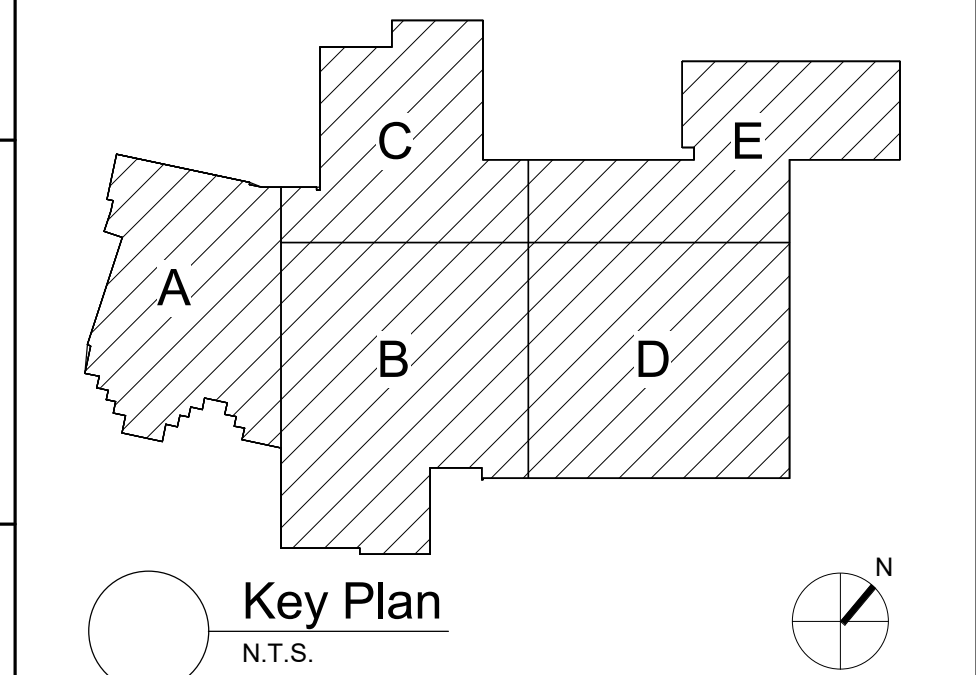

S.E.D. Control No. 62-18-01-06-0-007-019

Rev. No.: Date: Description:



complex world | CLEAR SOLUTIONS

Tetra Tech Engineers, Architects & Landscape Architects, P.C.

BID SET



Wallkill Central School District
Wallkill, New York

Reconstruction to:
Wallkill Senior High School

Work By Alternate

Drawn By: Author Date: 06/30/2023 Drawing Number:
Project No.: 17597-22002
AE137

1 First Floor - Key Plan - Work By Alermate
1/16" = 1'-0"