

File: H:\DRAWINGS\RHINEBECK (V)\22-2496 WPT\D-101 - 102 - DETAILS.DWG Sheet: 7/2/2024, 12:57:33 PM Plotted: 10/2/2024, 10:16:03 AM User: Ihs Broiles LmSvcedBy: broiles

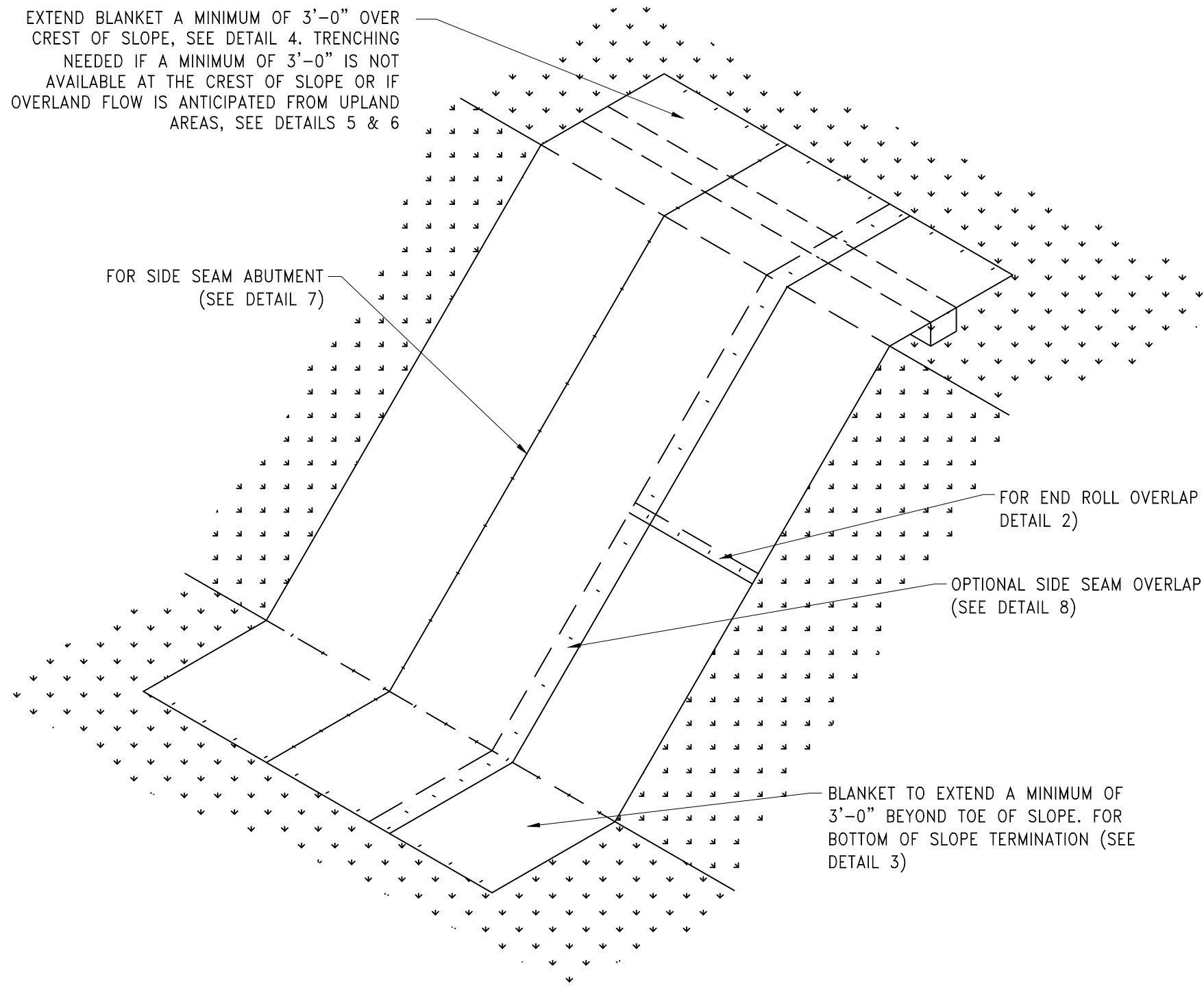

SLOPE DETAIL 1
NOT TO SCALE

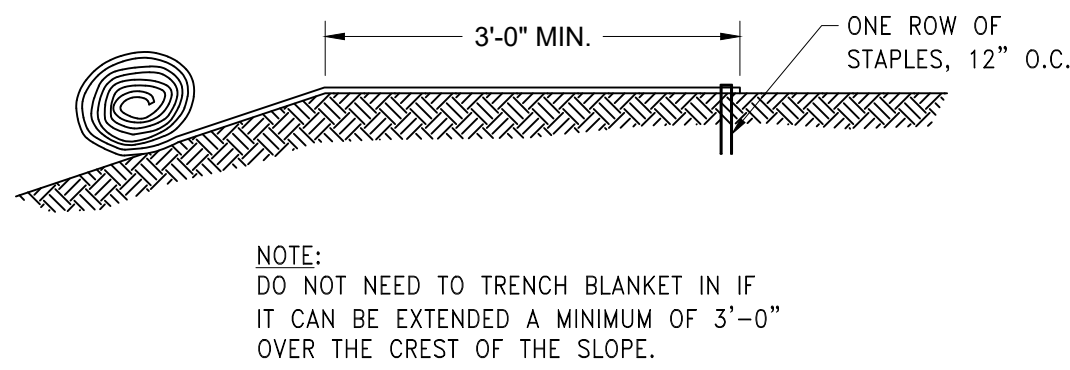

SLOPE CREST ANCHOR METHOD "A" (NO TRENCH) DETAIL 4
NOT TO SCALE

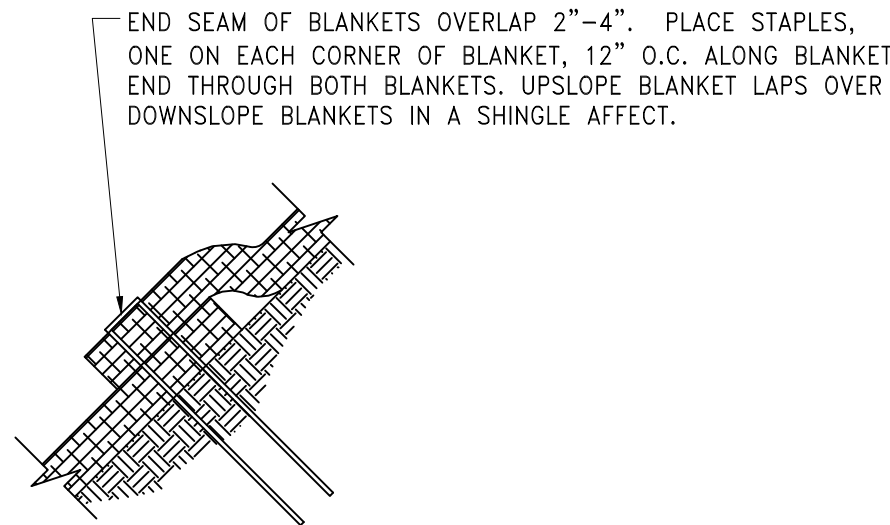

END ROLL OVERLAP DETAIL 2
NOT TO SCALE

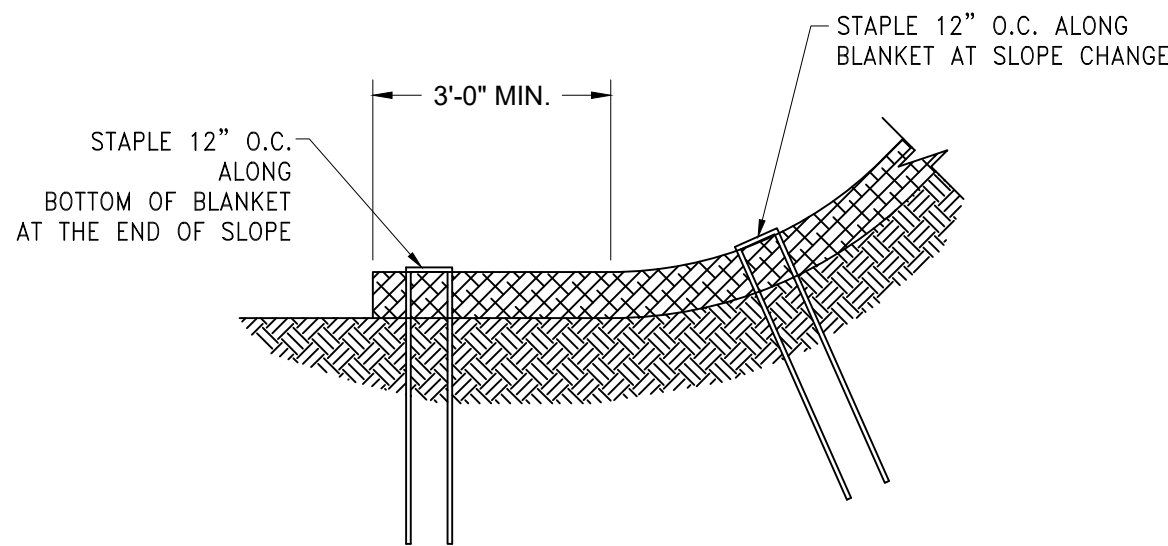

BOTTOM OF SLOPE TERMINATION DETAIL 3
NOT TO SCALE

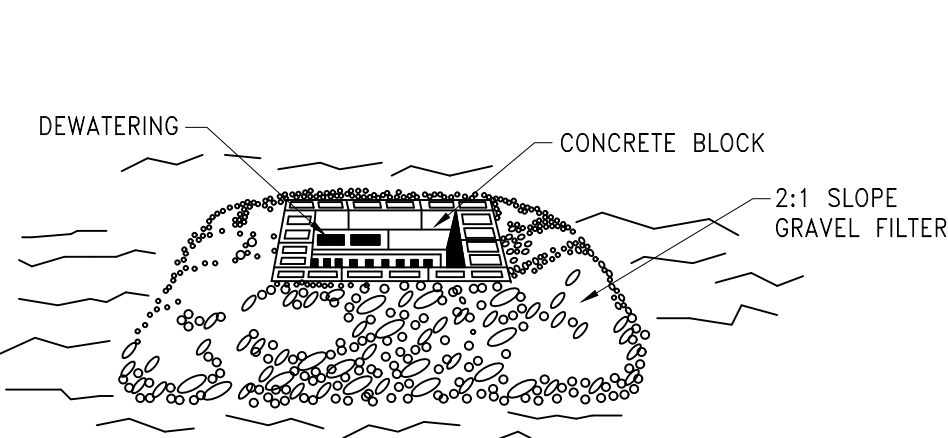

STONE & BLOCK PLAN VIEW
NOT TO SCALE

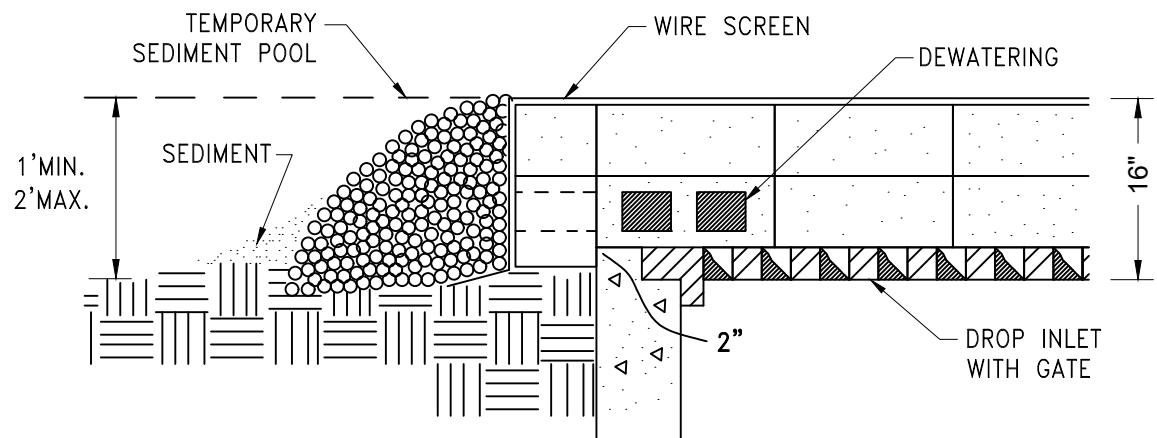

STONE & BLOCK DETAIL
NOT TO SCALE

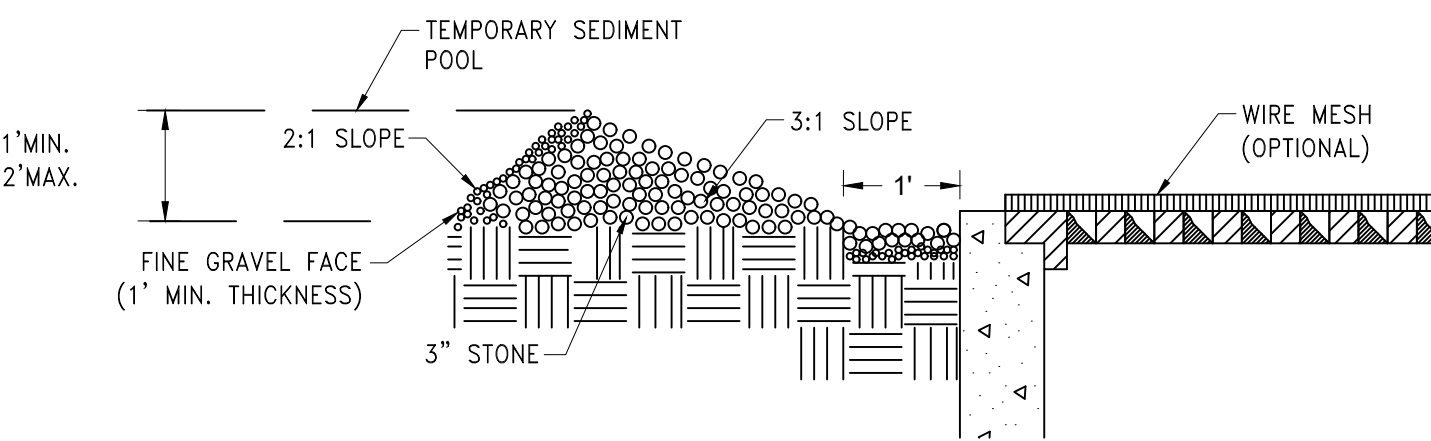

DONUT DETAIL
NOT TO SCALE

DROP INLET PROTECTION DETAIL
NOT TO SCALE

- NOTES:
1. LAY ONE BLOCK ON EACH SIDE OF THE STRUCTURE ON ITS SIDE FOR DEWATERING. FOUNDATION SHALL BE 2 INCHES MINIMUM BELOW REST OF INLET AND BLOCKS SHALL BE PLACED AGAINST INLET FOR SUPPORT.
 2. HARDWARE CLOTH OR 1/2" WIRE MESH SHALL BE PLACED OVER BLOCK OPENINGS TO SUPPORT STONE.
 3. USE CLEAN STONE OR GRAVEL 1/2-3/4 INCH IN DIAMETER PLACED 2 INCHES BELOW TOP OF THE BLOCK ON A 2:1 SLOPE OR FLATTER.
 4. FOR STONE STRUCTURES ONLY, A 1 FOOT THICK LAYER OF THE FILTER STONE WILL BE PLACED AGAINST THE 3 INCH STONE AS SHOWN ON THE DRAWINGS.
- MAXIMUM DRAINAGE AREA 1 ACRE

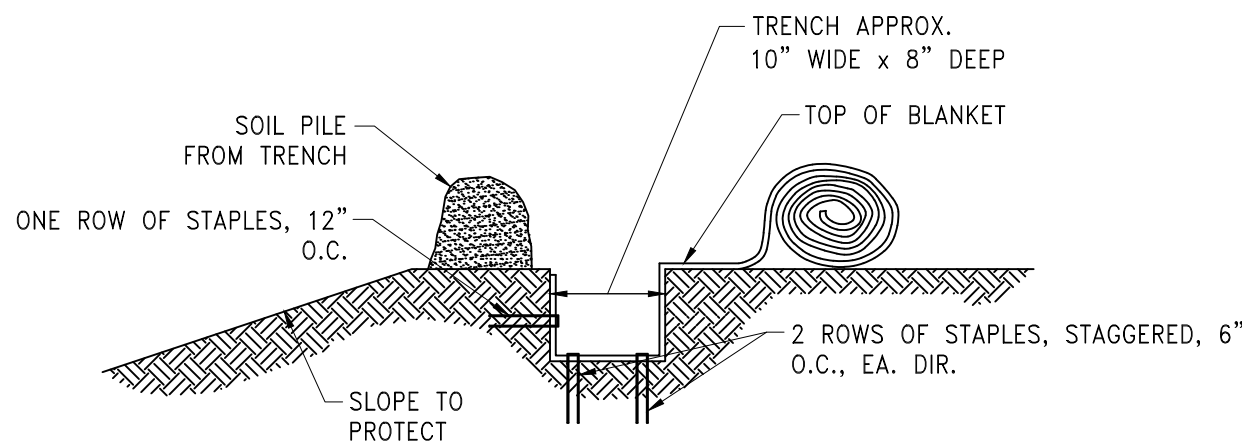

STEP 1

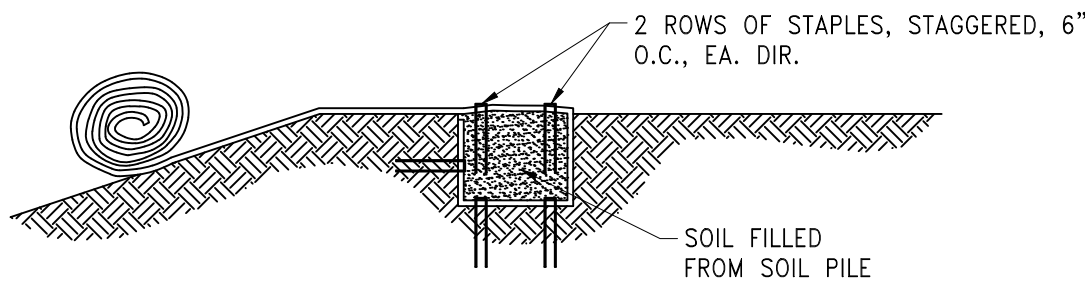

STEP 2

SLOPE TRENCHING METHOD "B" DETAIL 5
NOT TO SCALE

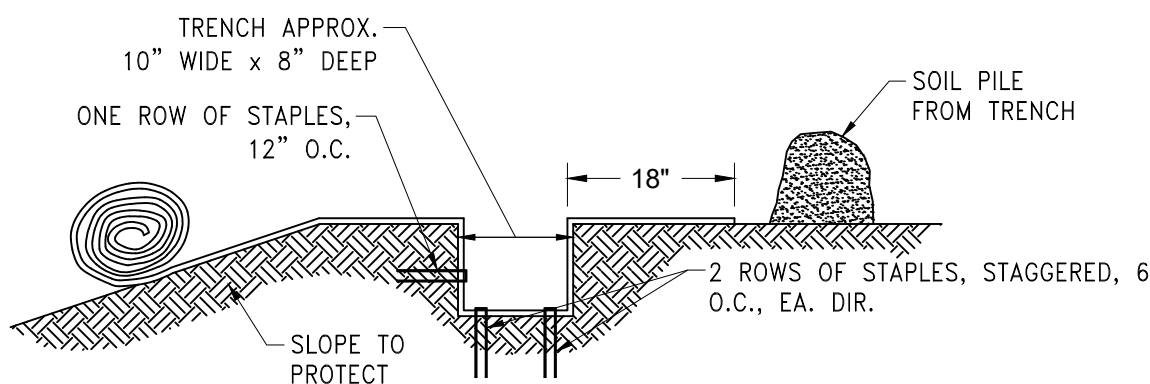

STEP 1

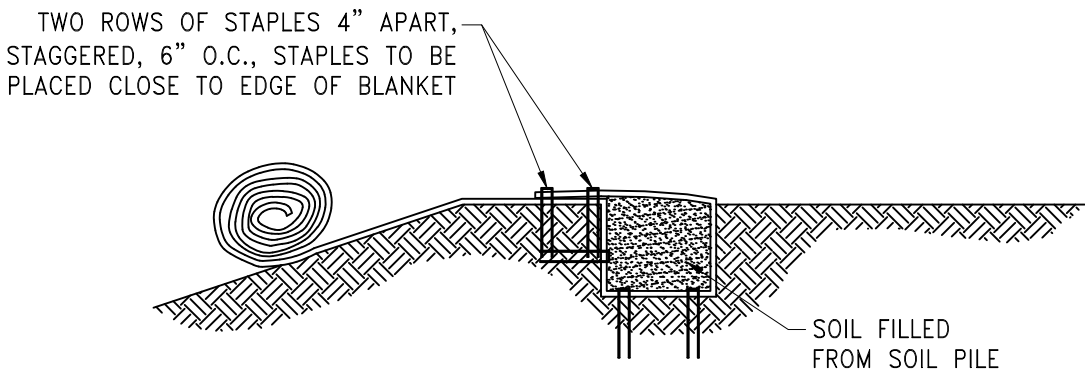

STEP 2

SLOPE TRENCHING METHOD "C" DETAIL 6
NOT TO SCALE

4 MECHANICAL JOINT DETAIL
0-20' SCALE: NOT TO SCALE

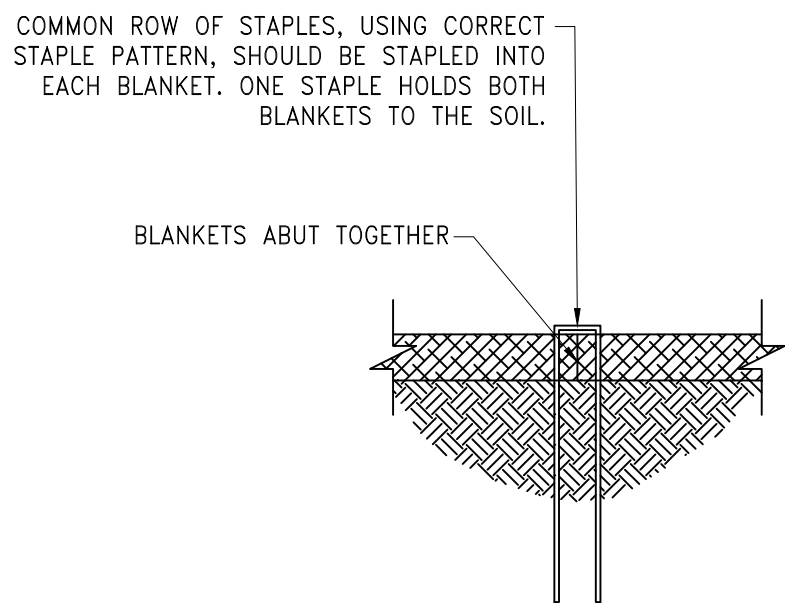

SIDE SEAM ABUT STAPLE DETAIL 7
NOT TO SCALE

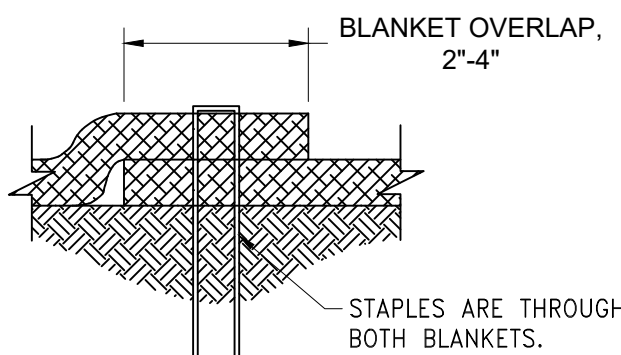

SIDE SEAM OVERLAP STAPLE DETAIL 8
NOT TO SCALE

DATE: 7/2/2024
DRAWN BY:
SCALE:
REVIEWED BY: RF
PROJECT NO.:
FILE:

DELAWARE ENGINEERING, P.C.
CIVIL AND ENVIRONMENTAL ENGINEERING
28 MADISON AVENUE EXTENSION, ALBANY, NY 12203 - 518.452.1290
55 SOUTH MAIN ST. ONEONTA, NY 13820 - 607.432.8073
31 NORTH MAIN STREET, LIBERTY, NY 12544 - 518.747.0962
16 EAST MARKET STREET, RED HOOK, NY 12571 - 518.452.1290
548 BROADWAY, MONTICELLO, NY 12571 - 845.791.7777

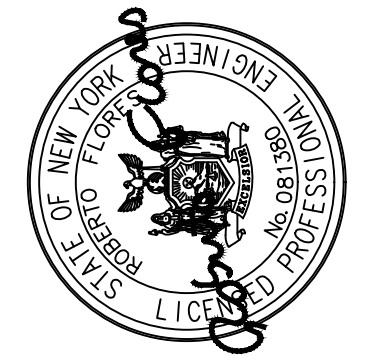

REVISIONS		DESCRIPTION
NO.	DATE	

RHINEBECK WTP
PLANT IMPROVEMENTS
VILLAGE OF RHINEBECK
DUTCHESS COUNTY, NEW YORK

SEDIMENT CONTROL
NOTES & DETAILS

SHEET:

D-203

WARNING - IT IS A VIOLATION OF NEW YORK EDUCATION LAW SECTION 7209.2, FOR ANY PERSON, UNLESS HE IS ACTING UNDER THE DIRECTION OF A LICENSED PROFESSIONAL ENGINEER OR LAND SURVEYOR, TO ALTER THIS DOCUMENT IN ANY WAY. IF ALTERED THE ALTERING PERSON SHALL COMPLY WITH THE REQUIREMENTS OF NEW YORK EDUCATION LAW, SECTION 7209.2.