

SUBMITTAL COVERSHEET **Nanuet UFSD –Phase 3 Projects**

Architect:
KSQ Architects
215 W 40th Street, 15th Floor
New York, NY 10018

Owner:
Nanuet Union Free School District
101 Church Street
Nanuet, NY 10954

Construction Manager:
Jacobs
One Penn Plaza, 54th floor
New York, NY 10019

Contractor: Joe Lombardo Plumbing & Heating of Rockland Inc

Contract: Ron Lombardo

Address: 321 Spook Rock Road Suite 109A

845-357-6537

Suffern, New York 10901

Telephone:

Fax: 845-357-8529

School Name: Nanuet Union Free School District Phase 3 Bond Projects @ Barr Middle School & Nanuet High School

Type of Submittal:

Re-submittal: ☐ No ☐ Yes

☐ Shop Drawings

☐ Product Data

☐ Schedule

☐ Sample

☐

☐ Test Report

☐ Certificate

☐ Color Sample

☐ Warranty

☐

Submittal Description:

Product Name: meters and guages

Manufacturer: trerice

**Subcontractor/
Supplier:**

References:

Spec. Section No.: 230519

Drawing No(s):

Paragraph:

Rm. or Detail No(s):

Architect's/ Engineer's Review Stamp

Contractor Review Statement:

These documents have been checked for accuracy and coordinated with job conditions and Contract requirements by this office and have been found to comply with the provisions of the Contract Documents.

Ronald J. Lombardo

10.9.23

Name:

Date:

Company Name:

Joe Lombardo Plumbing & Heating of Rockland Inc.

Remarks:

500X Series

Dial Sizes thru 12" • Cast Aluminum Case

INDUSTRIAL GAUGES



500XB shown

- ▶ 4 1/2", 6", 8 1/2", 12" Dial Sizes
- ▶ ±0.5% Accuracy
- ▶ Cast Aluminum Case

The Trerice **500X Series** Industrial Gauge is designed to withstand the most demanding applications of a variety of industries. This pressure gauge has a back flanged, cast aluminum case and stainless steel ring. Wetted parts are either bronze tube with Lead-Free (PBF) brass socket or stainless steel tube and socket.

- Optional features and case style variations available: Please consult the Options & Accessories Section for details.
- For correct use and application of all pressure gauges, please refer to: Pressure Gauge Standard ASME B40.100.

Note: "NEW" Range Codes

HOW TO ORDER

Sample Order Number: **500XB 45 02 L A 300**

Model	Dial Size	Connection Size	Connection Location	Units of Measure	Range Code
500XB	45 4 1/2"	02 1/4 NPT	L Lower	A psi	See Standard Ranges
500XSS	60 6"	04 1/2 NPT	B Back	B kPa	
	85 8 1/2"			C kg/cm ²	
	12 12"			D psi/kPa	
				E psi & kg/cm ²	Note: "NEW" Range Codes

Specifications

Models	Wetted Parts
500XB	Bronze tube, brass socket Lead-Free (PBF) Meets NSF/ANSI Standards 372 and 61
500XSS	316L stainless steel tube and socket *
Dial Sizes	4 1/2", 6", 8 1/2", 12"
Movement	Stainless Steel
Connection	Lower male or lower back male, 1/4 or 1/2 NPT
Case	Cast aluminum, black finished, surface mounted back flanged
Ring	4 1/2", 6" Dial Size: Flange type, 304 stainless steel 8 1/2", 12" Dial Size: Slotted Stainless Steel
Window	Clear glass
Pointer	4 1/2", 6", 8 1/2" Dial Size: Micro adjustable, black finished 12" Dial Size: Micro-adjustable, Black finished, knife-edged
Dial Face	Aluminum, white background with black graduations and markings
Accuracy	±0.5% Full Scale, ASME B40.100 Grade 2A
Maximum Temperature	250°F (121°C)
Approximate Shipping Weight	4 1/2" Dial Size: 2.0 lbs [0.91 kg] 6" Dial Size: 2.8 lbs [1.27 kg] 8 1/2" Dial Size: 5.8 lbs [2.63 kg] 12" Dial Size: 14.6 lbs [6.62 kg]

* Ranges over 10,000 psi have a Ni-Span-C bourdon tube.

500X Series

Dial Sizes thru 12" • Cast Aluminum Case

All dimensions are nominal. Dimensions in [] are in millimeters.

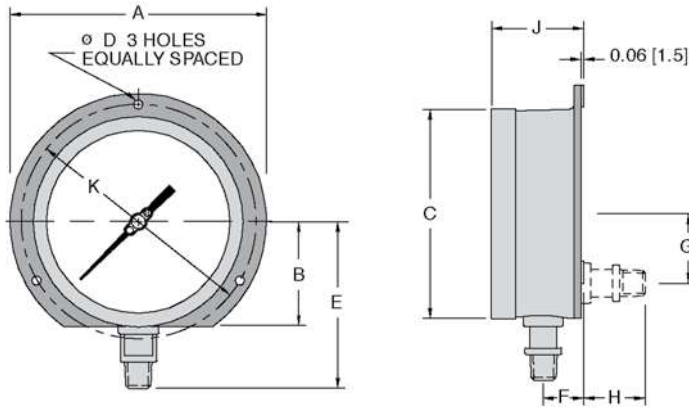

Dial Size	A	B	C	D	E	F	G	H	J	K
4 1/2"	5.88 [149.7]	2.39 [60.7]	4.79 [121.7]	0.22 [5.6]	3.83 [97.2]	0.94 [23.8]	1.63 [41.3]	1.41 [35.7]	2.06 [52.4]	5.38 [136.5]
6"	7.62 [193.6]	3.14 [79.8]	6.29 [159.8]	0.28 [7.1]	4.70 [119.5]	0.93 [23.8]	1.63 [41.3]	1.41 [35.7]	2.09 [53]	7.00 [177.8]
8 1/2"	10.25 [260.4]	4.38 [111.1]	8.80 [223.4]	0.28 [7.1]	5.81 [147.5]	0.97 [24.6]	1.63 [41.3]	1.41 [35.7]	2.24 [56.8]	9.63 [244.5]
12"	14.25 [362]	N/A	12.66 [321.5]	0.28 [7.1]	7.90 [200.7]	1.02 [25.9]	1.63 [41.3]	1.19 [30.2]	2.53 [64.3]	13.50 [343]

Standard Ranges

Note: "NEW" Range Codes

NEW Range Code	OLD Range Code	psi Ranges (A)			Corresponding kPa Ranges (B)			Corresponding kg/cm ² Ranges (C)		
		Specific Range	Figure Intervals	Minor Divisions	Specific Range	Figure Intervals	Minor Divisions	Specific Range	Figure Intervals	Minor Divisions
30/0	010	30" Hg to 0	5	0.2	-100 to 0 kPa	10	1	76 cm Hg to 0	10	0.5
30/15	020	30" Hg to 15 psi	5/5	0.5/0.2	-100 to 100 kPa	20/20	2/2	76 cm Hg to 1 kg/cm ²	20/0.2	1/0.2
30/30	030	30" Hg to 30 psi	10/5	1/0.5	-100 to 200 kPa	50/50	2/2	76 cm Hg to 2 kg/cm ²	20/0.5	2/0.2
30/60	040	30" Hg to 60 psi	10/10	1/1	-100 to 400 kPa	50/50	5/5	76 cm Hg to 4 kg/cm ²	25/0.5	5/0.5
30/100	050	30" Hg to 100 psi	30/10	2/1	-100 to 700 kPa	100/100	10/10	76 cm Hg to 7 kg/cm ²	76/1	5/0.1
30/150	060	30" Hg to 150 psi	30/20	5/2	-100 to 1000 kPa	100/100	10/10	76 cm Hg to 10 kg/cm ²	76/1	15/0.1
30/300	070	30" Hg to 300 psi	30/50	5/2	-100 to 2000 kPa	200/100	20/20	76 cm Hg to 21 kg/cm ²	76/3	19/0.2
15	080	0 to 15 psi	3	0.1	0 to 100 kPa	10	1	0 to 1 kg/cm ²	0.1	0.01
30	090	0 to 30 psi	5	0.2	0 to 200 kPa	20	2	0 to 2 kg/cm ²	0.2	0.02
60	100	0 to 60 psi	10	0.5	0 to 400 kPa	50	5	0 to 4.2 kg/cm ²	0.5	0.05
100	110	0 to 100 psi	10	1	0 to 700 kPa	100	5	0 to 7 kg/cm ²	1	0.05
160	120	0 to 160 psi	20	1	0 to 1100 kPa	200	10	0 to 11 kg/cm ²	1	0.1
200	130	0 to 200 psi	20	2	0 to 1400 kPa	200	10	0 to 14 kg/cm ²	2	0.1
300	140	0 to 300 psi	50	2	0 to 2000 kPa	200	20	0 to 21 kg/cm ²	3	0.2
400	150	0 to 400 psi	50	5	0 to 2800 kPa	400	20	0 to 28 kg/cm ²	4	0.2
600	160	0 to 600 psi	50	5	0 to 4000 kPa	500	50	0 to 42 kg/cm ²	6	0.5
1000	180	0 to 1000 psi	100	10	0 to 7000 kPa	1000	50	0 to 70 kg/cm ²	10	0.5
Ranges over 1000 psi are not available on 500XB.										
1500	190	0 to 1500 psi	300	10	0 to 10,000 kPa	1000	100	0 to 100 kg/cm ²	10	1
2000	200	0 to 2000 psi	200	20	0 to 14,000 kPa	2000	100	0 to 140 kg/cm ²	20	1
3000	210	0 to 3000 psi	500	20	0 to 20,000 kPa	2000	200	0 to 210 kg/cm ²	30	2
5000	220	0 to 5000 psi	500	50	0 to 35,000 kPa	5000	250	0 to 350 kg/cm ²	50	2
10000	230	0 to 10,000 psi	1000	100	0 to 70,000 kPa	10,000	500	0 to 700 kg/cm ²	100	10
Ranges over 10,000 psi are only available on 500XSS, and have Ni-Span-C tubes.										
15000	240	0 to 15,000 psi	3000	100	0 to 100,000 kPa	10,000	1000	0 to 1000 kg/cm ²	100	10
20000	250	0 to 20,000 psi	2000	200	0 to 140,000 kPa	20,000	1000	0 to 1400 kg/cm ²	200	10

For dual scale ranges, specify the appropriate **Units of Measure: D (psi/kPa) or E (psi & kg/cm²)** followed by the equivalent **A (psi) Range Code**. Other pressure ranges are also available including: Altitude, Ammonia, Refrigerant and Receiver. Consult Special Application Ranges section or factory for availability.



865/880 Series

Gauge Cocks

2.2 pressure gauge cocks

865/880 Series Quarter Turn Gauge Cocks provide an economical way to shut off the flow of air to the pressure instrument, thereby allowing the instrument to be isolated from the pressure media or removed from service. Trerice Gauge Cocks are constructed from brass and are intended for use on air lines where leakage is not of concern. **It is recommended to place a needle valve, ball valve or gauge cock in line before every pressure gauge installation.**

In applications where process media leakage may result in possible personal injury or property damage, gauge cocks should not be specified as they contain no packing gland and leakage may result. For tight shut-off and prevention of leakage, use of a Trerice Ball Valve or Needle Valve is required.



865



865MFG



865-1



880

865/880 Series Gauge Cocks

Item No.	Type	Connection Size	Body	Plug	Maximum Pressure (psig)	Maximum Temperature	Approximate Shipping Weight
865	FXF	1/4 NPT	Brass*	Brass	200	500°F	0.1 lbs [0.05 kg]
865MFG	MXF	1/4 NPT	Brass*	Brass	200	500°F	0.1 lbs [0.05 kg]
865-1	FXF	1/4 NPT	Brass	Brass	300	500°F	0.3 lbs [0.14 kg]
880	MXF	1/4 Union	Brass	Brass	150	500°F	0.5 lbs [0.23 kg]

* Add (PBF) to the end of part number to specify Lead-Free brass.

All dimensions are nominal. Dimensions in [] are in millimeters.

Part No.	A	B	C	NPT
865	1.09 [28]	1.73 [44]	1.62 [41]	1/4 - 18
865-1	1.04 [26]	1.78 [45]	2.26 [41]	1/4 - 18
865MFG	1.09 [28]	1.73 [44]	1.86 [47]	1/4 - 18
880	1.12 [28]	1.82 [46]	3.31 [84]	1/4 - 18

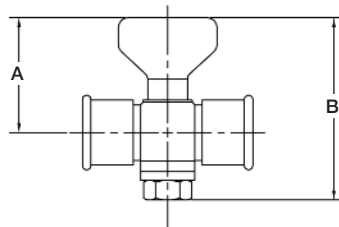
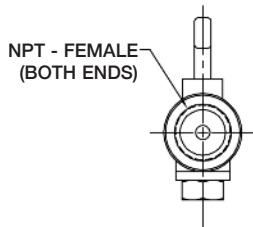
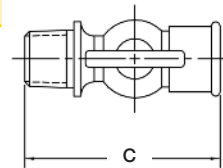
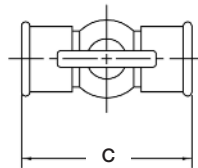

865 & 865-1

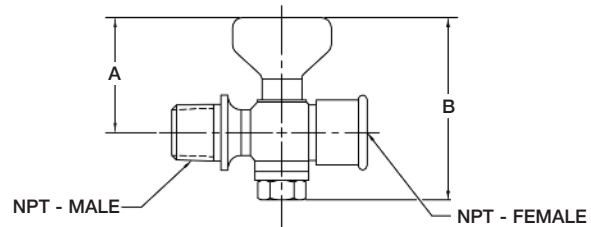

865MFG & 880

872 Series

Pressure Snubbers

2.2-c- snubbers



872 Series Pressure Snubbers are designed to improve readability and prevent wear on delicate gauge mechanisms by slowing rapid pressure changes and reducing shock and chattering. A pressure snubber should be installed on a gauge in any application where pressure spikes and/or pulsations may be present. If a single snubber does not correct the oscillation, it is recommended to place an additional snubber in line with the first. Trerice Pressure Snubbers reduce the pulsation by forcing the pressure medium through a porous metal core and are constructed from brass or 303 stainless steel for use on a variety of pressure media.

872 Series Pressure Snubbers

Item No.	Body & Insert Material	Connection Size (NPT)	Maximum Pressure (psig)	Service	Approximate Shipping Weight
872-1	Brass*	1/4	1000	Air and gases	0.1 lbs [0.05 kg]
872-2	Brass*	1/4	1000	Water, steam, gasoline and light oils	0.1 lbs [0.05 kg]
872-3	Brass*	1/4	1000	Lubricating and heavy oils	0.1 lbs [0.05 kg]
872-4	303SS	1/4	2000	Air and gases	0.3 lbs [0.14 kg]
872-5	303SS	1/4	2000	Water, steam, gasoline and light oils	0.3 lbs [0.14 kg]
872-6	303SS	1/4	2000	Lubricating and heavy oils	0.3 lbs [0.14 kg]
872-7	Brass*	1/2	5000	Air and gases	0.1 lbs [0.05 kg]
872-8	Brass*	1/2	5000	Water, steam, gasoline and light oils	0.1 lbs [0.05 kg]
872-9	Brass*	1/2	5000	Lubricating and heavy oils	0.1 lbs [0.05 kg]
872-10	303SS	1/2	10,000	Air and gases	0.3 lbs [0.14 kg]
872-11	303SS	1/2	10,000	Water, steam, gasoline and light oils	0.3 lbs [0.14 kg]
872-12	303SS	1/2	10,000	Lubricating and heavy oils	0.3 lbs [0.14 kg]

* Add (PBF) to the end of part number to specify Lead-Free brass.

All dimensions are nominal. Dimensions in [] are in millimeters.

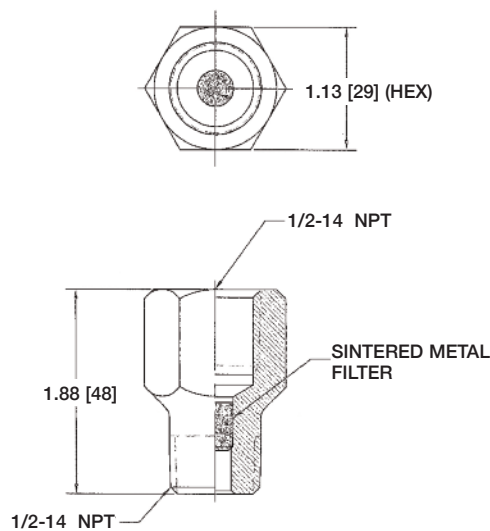

872-7 THRU 12

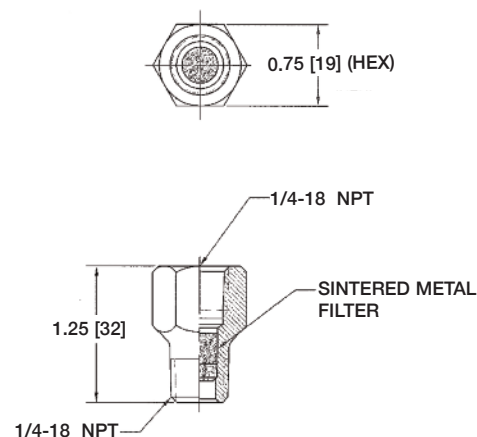

872-1 THRU 6

Adjustable Angle

2.3 stem type thermometers

7" • 9" • 12" Scale Sizes

INDUSTRIAL THERMOMETERS

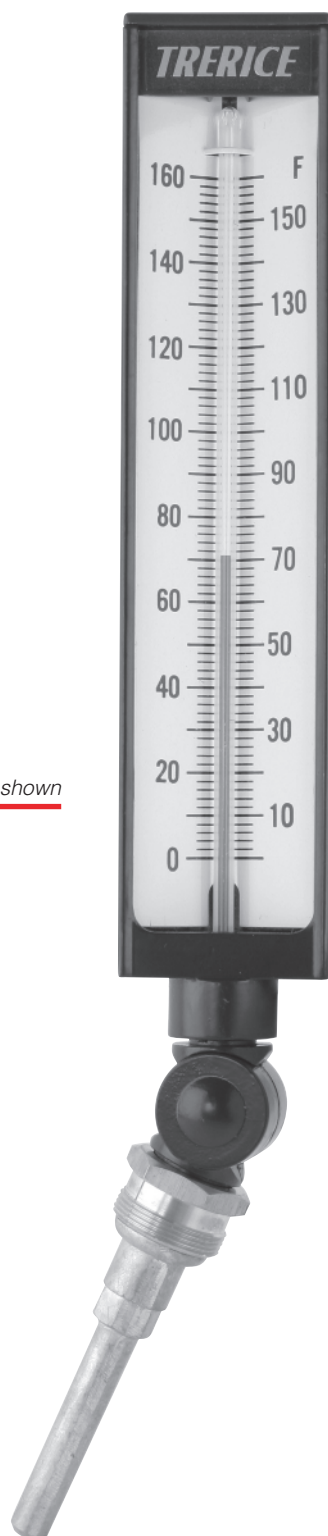

BX91403 shown

- ▶ 7", 9", 12" Scale
- ▶ ± 1 Scale Division Accuracy
- ▶ Cast Aluminum Case
- ▶ Adjustable Angle Stem

Recognized globally as the Trerice "BX" Industrial Thermometer, this is an instrument of extreme accuracy and rugged dependability. Available in scale sizes of 7" (AX9), 9" (BX9), & 12" (CX9), with a durable cast aluminum case, this universally adjustable, liquid-in-glass thermometer is the most widely specified instrument of its kind.

- Optional features available: Please consult the Options & Accessories Section for details.

Thermowell

- For applications where the process media may be corrosive or contained under pressure, the use of a thermowell is required to prevent damage to the thermometer and facilitate its removal from the process. (Refer to page 158)

Specifications

Models	Scale Sizes
AX9	7"
BX9	9"
CX9	12"
Adjustable Angle	
Fill Type	Spirit: Blue colored, organic
Case	Cast Aluminum, blue epoxy finish
Stem	Aluminum, brass, 304 stainless steel or air-duct style available
Connection	Standard: 1 1/4 - 18 UNEF-2A coupling nut Air-Duct: Reversible mounting flange with 3 bolt holes
Window	Ultraviolet protective acrylic on ranges to 300° F Glass on ranges over 300° F
Tube	Lens front, magnifying type
Scale	Aluminum, white background with black graduations and markings
Top Plate	ABS
Accuracy	± 1 scale division
Approximate Shipping Weight	AX9: 1.5 lbs [0.68 kg] BX9: 1.6 lbs [0.73 kg] CX9: 2.0 lbs [0.91 kg]

HOW TO ORDER

Sample Order Number: **BX9 1 403 07**

Model	Stem (Material)	Stem (Length)	Specific Range
AX9 7" Adjustable	1 Aluminum (standard)	403 31 1/2"	See Standard Ranges
BX9 9" Adjustable	2 Brass	406 6"	
CX9 12" Adjustable	3 304 SS	408 8"	
		512 12"	
		006 6" Air-Duct	
		012 12" Air-Duct	
	9 Air-Duct (Aluminum)*		

* Not for use with Thermowells

Adjustable Angle

All dimensions are nominal.
Dimensions in [] are in millimeters.

INDUSTRIAL THERMOMETERS

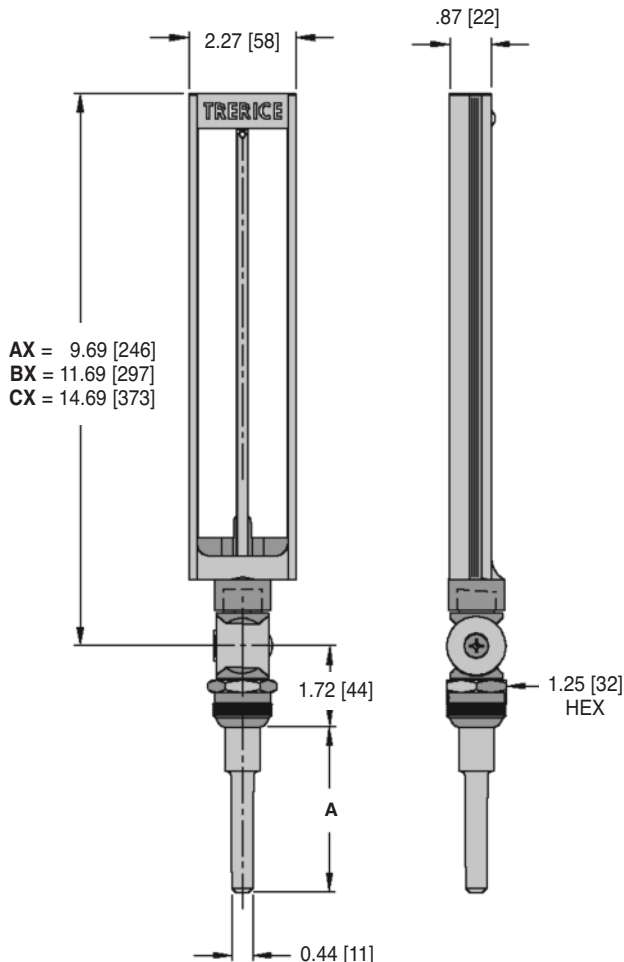

(A) Stem Length	Dimension
3 1/2"	3.50 [88.9]
6"	6.00 [152.4]
8"	8.00 [203.2]
12"	12.00 [304.8]

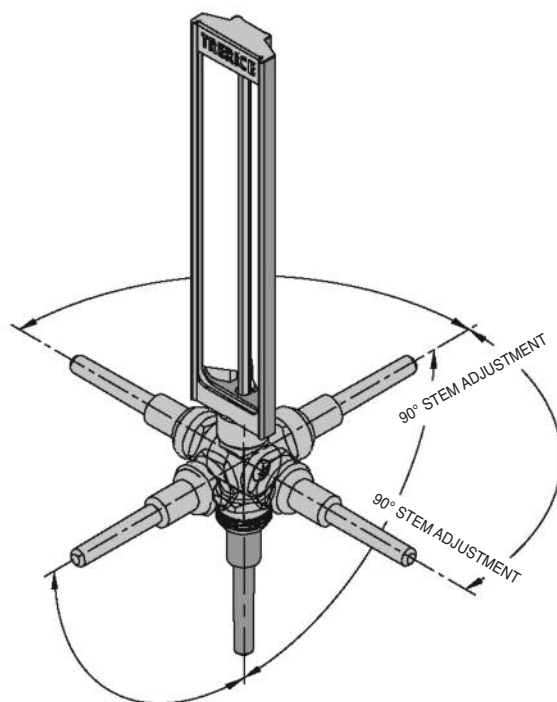
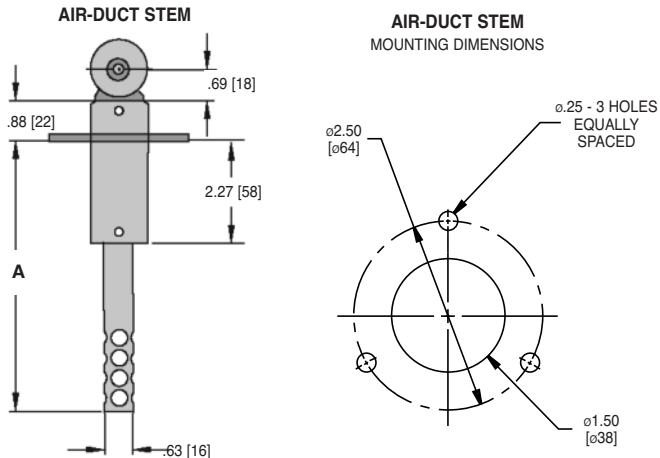

Standard Ranges

Fahrenheit Scale		Celsius Scale		Dual Scale		Fahrenheit		Celsius	
Range Code	Range	Range Code	Range	Range Code	Range	Figure Intervals	Minor Divisions	Figure Intervals	Minor Divisions
01	-40° to 110°F	17	-40° to 40°C	41	-40° to 110°F & -40° to 40°C	10°	2°	5°	1°
02	0° to 100°F	24	-18° to 38°C	42	0° to 100°F & -18° to 38°C	5°	1°	5°	0.5°
03	30° to 130°F	25	0° to 55°C	43	30° to 130°F & 0° to 55°C	5°	1°	5°	1°
04	0° to 160°F	26	-18° to 70°C	44	0° to 160°F & -18° to 70°C	10°	2°	5°	1°
06	30° to 180°F	27	0° to 83°C	46	30° to 180°F & 0° to 83°C	10°	2°	5°	1°
07	30° to 240°F	19	0° to 115°C	47	30° to 240°F & 0° to 115°C	10°	2°	5°	1°
08	30° to 300°F	20	0° to 150°C	48	30° to 300°F & 0° to 150°C	10°	2°	10°	2°
09	50° to 400°F	28	10° to 205°C	49	50° to 400°F & 10° to 205°C	25°	5°	10°	2°
15	50° to 500°F	31	10° to 260°C	55	50° to 500°F & 10° to 260°C	25°	5°	10°	2°

Dual scale figure intervals may differ

Thermowells

for Industrial Thermometers

All dimensions are nominal. Dimensions in [] are in millimeters.

THERMOWELLS

- SX9 Solar
- AX9, BX9, CX9 Adjustable Angle
- AX, BX, CX Rigid Stem
- BX Plus

Lengths

	Standard	with Lagging Extension	
(A) Stem Length	U Length	(T)	U Length
3 1/2"	2.50 [64]	1.00 [25]	1.75 [44]
6"	5.00 [127]	3.00 [76]	2.50 [64]
8"	7.00 [178]	3.00 [76]	4.50 [114]
12"	11.00 [279]	3.00 [76]	8.50 [216]

Pressure Rating (psi)

Material	Operating Temperature			
	70°F	200°F	400°F	600°F
304 Stainless Steel	630	570	460	380
316 Stainless Steel	650	600	570	500
Monel	540	480	440	400
Brass/PBF Brass	300 psi @ 150°F		250 psi @ 350°F	

Standard

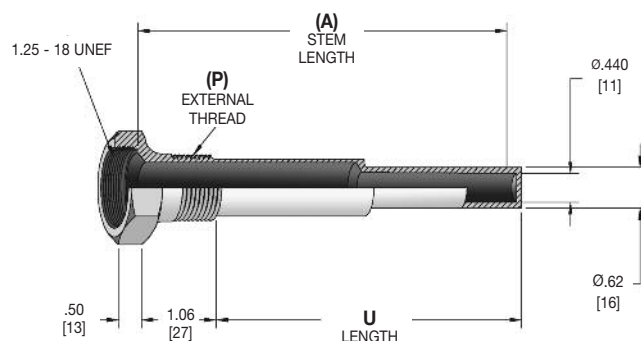

with Lagging Extension

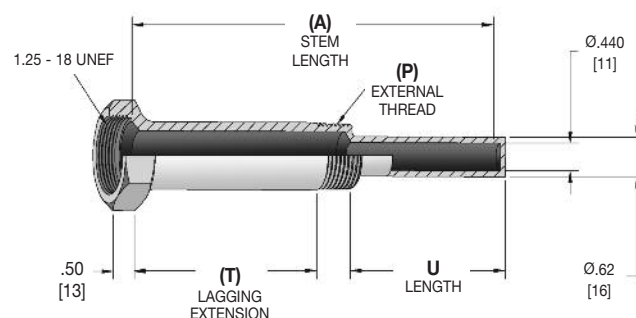

Alternative materials and accessories are also available. Please consult the Options and Accessories Section for details.

Selection of the proper thermowell is the sole responsibility of the user. Temperature and pressure limitations must be considered. Improper application may cause failure of the thermowell, resulting in possible personal injury or property damage.

HOW TO ORDER

Sample Order Number: **3-4 F 2**

Thermowell Style	(P) External Thread	(A) Stem Length	(T) Lagging Extension	Material
3 - Industrial	3 1/2 NPT*	F 3 1/2" Stem**	A 1" Extension (3 1/2" Stem only)	2 Brass††
	4 3/4 NPT	J 6" Stem	D 2 1/2" Extension (6" and longer Stem only)	4 Monel
	5 1 NPT	L 8" Stem	Omit if None	5 304SS
		R 12" Stem†		6 316SS

* Only available with 3 1/2" stem and 1" extension.

** 3 1/2" stem Straight Shank.

† 12" stem requires 1 NPT external thread.

†† Add (PBF) to end of part number to specify Lead-Free brass

Test Plugs & Accessories

The **Trerice Test Plug** provides a convenient access port for determining the pressure and/or temperature of process media contained in a pipe line or vessel. The test plug is designed for use in chilled or hot water systems and is permanently installed in the system at the desired test location. A test thermometer or pressure gauge with test adapter can be inserted through the plug to determine the conditions within the system. When the probe is withdrawn, the inner valve plug closes to seal the system. The test plug includes a removable cap to protect the inner valve plug and provide a secondary seal.

Nordel, otherwise known as EPDM, provides excellent service in hot or cold water. **Nordel should not be used with hydrocarbon solvents, hydrocarbon oils, chlorinated hydrocarbons or turpentine.**

Neoprene, a synthetic rubber, provides excellent service in ammonia, high aniline point petroleum oils and silicate ester lubricants. **Neoprene should not be used with silicone greases, silicone oils or di-ester based lubricants.**



D3742
shown

Test plugs are designed for initial startup and testing, not continuous or frequent use. If continuous or frequent use is desired or expected, a test well should be installed for temperature applications and a needle valve installed for pressure applications.

Tests should be made as quickly as possible because the inner plug resealing time is dependent upon the length of time the probe remains inserted, as well as the temperature and pressure of the system. The test plug may take longer to reseal at lower temperatures or pressures. The probe used for testing should never exceed a diameter of 0.156" (4 mm). The pressure gauge used for testing should always have a range of twice the system pressure.

Test Plugs

Test Plug Item No.	Test Plug with Retainer Item No.	Connection Size (NPT)	Body Length	Body & Cap	Core	Max Pres. (psig)	Max Temp.	Approximate Shipping Weight
D3741	D3764	1/4	1 1/2"	Brass*	Nordel	1000	350°F	0.1 lbs [0.05 kg]
D3743	D3763	1/4	1 1/2"	Brass*	Neoprene	1000	200°F	0.1 lbs [0.05 kg]
D3758	D3766	1/4	1 1/2"	316SS	Nordel	1000	350°F	0.1 lbs [0.05 kg]
D3757	D3765	1/4	1 1/2"	316SS	Neoprene	1000	200°F	0.1 lbs [0.05 kg]
D3742	D3770	1/2	1 1/2"	Brass*	Nordel	1000	350°F	0.2 lbs [0.09 kg]
D3744	D3769	1/2	1 1/2"	Brass*	Neoprene	1000	200°F	0.2 lbs [0.09 kg]
D3762	D3772	1/2	1 1/2"	316SS	Nordel	1000	350°F	0.2 lbs [0.09 kg]
D3761	D3771	1/2	1 1/2"	316SS	Neoprene	1000	200°F	0.2 lbs [0.09 kg]
D3767	D3773	1/4	3"	Brass	Nordel	1000	350°F	0.4 lbs [0.18 kg]
D3768	D3774	1/4	3"	Brass	Neoprene	1000	200°F	0.4 lbs [0.18 kg]

* Add (PBF) to the end of part number to specify Lead-Free brass.

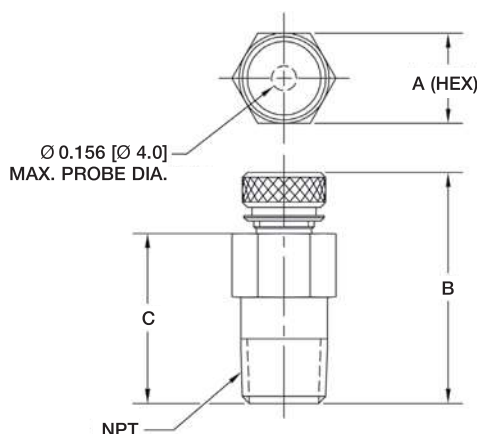

All dimensions are nominal. Dimensions in [] are in millimeters.

Part No.	A	B	C	NPT
D3741	0.56 [14]	1.50 [38]	1.06 [27]	1/4 - 18
D3743				
D3758				
D3757				
D3742	0.88 [22]	1.50 [38]	1.06 [27]	1/2 - 14
D3744				
D3762				
D3761				
D3767	0.56 [14]	3.00 [76]	2.56 [65]	1/4 - 18
D3768				

Test Plugs & Accessories

Test Kits

Item No.	Pressure Range (psi)	Approximate Shipping Weight
D3750	0 to 100	1.4 lbs [0.64 kg]
D3751	0 to 200	1.4 lbs [0.64 kg]
D3752	0 to 300	1.4 lbs [0.64 kg]
D3748	0 to 600	1.4 lbs [0.64 kg]

Each test kit contains:

- (1) 700B Pressure Gauge,
- (1) B82105P03F&C Thermometer,
- (1) B82105P05F&C Thermometer,
- (1) D3747 Gauge Adapter,
- (1) Carrying Case



Test Kit Replacement Items

Item No.	Description	Approximate Shipping Weight
700B2502LA100	700B Pressure Gauge, 2 1/2", 1/4 NPT, lower connection, 0 to 100 psi	0.4 lbs [0.18 kg]
700B2502LA200	700B Pressure Gauge, 2 1/2", 1/4 NPT, lower connection, 0 to 200 psi	0.4 lbs [0.18 kg]
700B2502LA300	700B Pressure Gauge, 2 1/2", 1/4 NPT, lower connection, 0 to 300 psi	0.4 lbs [0.18 kg]
700B2502LA600	700B Pressure Gauge, 2 1/2", 1/4 NPT, lower connection, 0 to 600 psi	0.4 lbs [0.18 kg]
B82105P03	B82105 Bimetal Thermometer, 1 3/4" dial size, 5" stem, 25° to 125°F & C	0.4 lbs [0.18 kg]
B82105P05	B82105 Bimetal Thermometer, 1 3/4" dial size, 5" stem, 20° to 240°F & C	0.4 lbs [0.18 kg]

Accessories

Item No.	Description	Approx. Shipping Weight
D3747	Gauge Adapter, 1/8" diameter	0.1 lbs [0.05 kg]
D3749*	2" Brass Extension, 1/4 NPT	0.1 lbs [0.05 kg]
D3753*	2" Brass Extension, 1/2 NPT	0.2 lbs [0.09 kg]

* Add (PBF) to the end of part number to specify Lead-Free brass.