

SUBMITTAL REVIEW



CLIENT NAME: _____
PROJECT TITLE: _____
SUBMITTAL No.: _____ H2M PROJECT No.: _____
SUBMITTAL NAME: _____

SUBMITTAL REVIEW	
REVIEW IS FOR GENERAL COMPLIANCE WITH CONTRACT DOCUMENTS. NO RESPONSIBILITY IS ASSUMED FOR CORRECTNESS OF DIMENSIONS OR DETAILS	
<input type="checkbox"/> NO EXCEPTIONS TAKEN	<input type="checkbox"/> SUBMIT SPECIFIED ITEM
<input type="checkbox"/> MAKE CORRECTIONS NOTED <small>(RESUBMISSION NOT REQUIRED)</small>	<input type="checkbox"/> NO ACTION TAKEN <small>(REVIEW IS THE RESPONSIBILITY OF ANOTHER PARTY)</small>
<input type="checkbox"/> REVISE & RESUBMIT	<input type="checkbox"/> NO ACTION TAKEN <small>(THIS SUBMITTAL IS NOT REQUIRED BY THE CONTRACT)</small>
<input type="checkbox"/> REJECTED - SEE REMARKS	<input type="checkbox"/> RECEIVED FOR RECORD
<p>Corrections or comments made on the shop drawings during this review do not relieve contractor from compliance with requirements of the drawings and specifications. This check is only for review of general conformance with the design concept of the project and general compliance with the information given in the contract documents. The contractor is responsible for: confirming and correlating all quantities and dimensions; selecting fabrication processes and techniques of construction; coordinating their work with that of all other trades; and performing the work in a safe and satisfactory manner.</p>	
Date: _____	By: _____

Rev.: 2020-05-20

Comments:

--

CONTRACTOR'S COMPANY NAME
ADDRESS

SUBMISSION TRANSMITTAL FORM
CLIENT NAME: Vails Gate Fire District
PROJECT TITLE: VGFD2001-New Firehouse

H2M PROJECT NO.: VGFD2001

Product, Item, or System Submitted:			
Submission Date:		Submission Log No.:	
Specification Section:		Paragraph Reference:	
Contract Drawing Reference(s):			
Manufacturer's Name:			
Manufacturer's Mailing Address:			
Manufacturer's Contact Information:	<i>Name</i>	() <i>Tel. no.</i>	<i>Email</i>
Supplier's Name:			
Supplier's Mailing Address:			
Supplier's Contact Information:	<i>Name</i>	() <i>Tel. no.</i>	<i>Email</i>
This item is a substitution for the specified item:	___ No		___ Yes
<p>KEY CONSTRUCTION SERVICES, LLC</p> <p>Project No: VGFD2001</p> <p><small>Reviewed for General Acceptance Only. This review does not relieve the Subcontractors or Suppliers of responsibility for making the work conform to the requirements of the contract. The Subcontractor and Suppliers are responsible for all dimensions, correct fabrication and accurate fit with the work of other trades.</small></p> <p><u>SUBJECT TO ARCHITECT AND OR ENGINEER APPROVAL</u></p> <p>Signed <i>Joseph Manfredi</i>(PM) Date: 11/13/2023</p> <p>Contractor's Approval Stamp with Signature & Date</p>		<p><u>Contractor's Brief Comments or Remarks</u> (attach separate letter as needed):</p> <p>By making this submission, we represent that we have determined and verified all field measurements and dimensions, field construction criteria, site and building constraints in terms of limitations in moving the item into the enclosed space, materials, catalog and model numbers and similar data and that we have checked and coordinated this submission with other work at or adjacent to the installed location in accordance with the requirements contained in the Contract Documents.</p>	

END OF SECTION 013300

Joe Lombardo
Plumbing & Heating of Rockland, Inc.

321 Spook Rock Road
Suffern, NY 10901
Ph. 845-357-6537 Fx 845-357-8529
E: info@josephlombardo.com
Website: www.josephlombardo.com

Rockland Cty. Plumbing #1000 Rockland Cty. Cooling # 1468
Westchester Cty. Plumbing #460 New Jersey State Plumbing #12702

TO: Key Construction
4246 Albany Post Rd. Suite 1
Hyde Park, NY 12538

LETTER OF TRANSMITTAL

Form with fields: DATE: 11-6-23, JOB NO., ATTENTION: Joe Manfredi, RE: Vails Gate Firehouse

WE ARE SENDING YOU [] Attached [] Under separate cover via the following items:
[] Shop Drawings [] Prints [] Plans [] Samples [] Specifications
[] Copy of letter [] Change order

Table with 4 columns: EMAIL, DATE, No., DESCRIPTION. Row 1: 1, 11-6-23, 220523, General duty valves

THESE ARE TRANSMITTED as checked below:
[] For approval [] No Exceptions Taken [] Resubmit copies for review
[] For your use [] Make Corrections Noted [] Submit copies for distribution
[] As requested [] Rejected [] Return corrected prints
[] For review and comment
[] FOR BIDS DUE 20 PRINTS RETURNED AFTER LOAN TO US

COPY TO: Joe Manfredi SIGNED: Ronald J. Lombardo

77V-LF Series

Press End Forged Ball Valve | Small Diameter 1/2" - 2"

LEAD FREE

2.01 - F - DOMESTIC WATER BALL VALVES



"Apollo" PRESS



Job Name:	
Job Location:	
Engineer:	
Contractor:	
Tag:	
PO#:	
Rep:	
Wholesale Dist.:	

DESCRIPTION

The APOLLOPRESS® 77VLF Series lead free* two-piece press ball valve is ideal for installation in most plumbing and heating systems, including potable water. Now with Leak Before Press® feature and 300 psig maximum working pressure. Proudly Made in the USA.

FEATURES

- Lead Free*, ANSI 3rd Party Certified and Listed
- Full-Port Flow
- Superior RPTFE Seats and Packing
- Adjustable Stem Packing
- Ridgid® XL Press Tool Compatible
- Leak Before Press® Technology
- Blowout-Proof Stem
- Corrosion Resistant Materials
- Silicone Free Assembly
- 100% Factory Tested
- **Made in USA, ARRA Compliant**

PERFORMANCE RATING⁺

- Maximum Operating Pressure: 300 psi
- Temperature Range: 0°F - 250°F

**APOLLOPRESS® connectors are designed for direct mechanical connection to ASTM B88-Type K, L, and M copper tubing in the hard drawn condition. Press connectors are not suitable for steam or flammable gas service.*

APPROVALS

- MSS SP-110 Ball Valves
- NSF/ANSI 61 Water Quality
- NSF/ANSI 372 Lead Free
- IAPMO/ANSI Z1157 Ball Valves
- Directive 2011/65/CE (RoHS)

APPROVED APPLICATIONS

- Water Including Potable Water
- Hydronic Heating (90% glycol max)
- Low Pressure Steam, 15 psi max
- Not Suitable for Flammable Gas Service
- Designed for Direct Mechanical Connection to ASTM B88-Type K, L, and M Copper Tubing in the Hard Drawn Condition
- Not Compatible with Soft Annealed Copper Tubing

OPTIONS

- (-01) Standard Lever Handle
- (-04) 2-1/4" Stem Extension 1/2" - 2-1/2"
- (-07) Tee Handle 1/2" - 2"
- (-11) Thermo-Seal™
- Insulating Tee Handle 1/2" - 2"
- (-27) Locking Handle SS 1/2" - 2-1/2"
- 77V140 Series - SS Ball & Stem
- 77V-LF Large Diameter 2-1/2" - 4"

STANDARD MATERIALS LIST

BODY	Lead Free Brass, C27451
SEAT	RPTFE
BALL	Lead Free Brass, C27451, Chrome Plated
STEM PACKING	RPTFE
NUT	Corrosion Resistant Plated Steel
STEM	Lead Free Brass, C27451
RETAINER	Lead Free Brass, C27451
HANDLE	Plated Steel / Insulated Polyvinyl
GLAND	Brass, ASTM B16, C36000
O-RING SEALS	EPDM

DIMENSIONS

MODEL NUMBER	SIZE (IN.)	DIMENSIONS (IN.)					WT. (LB.)
		A	B	C	D	E	
77VLF10301	1/2"	0.50	1.57	2.89	1.66	2.85	0.4
77VLF10401	3/4"	0.75	1.90	3.63	1.91	3.86	0.9
77VLF10501	1"	1.00	2.20	3.88	2.11	3.86	1.2
77VLF10601	1-1/4"	1.25	2.23	4.22	2.44	4.75	2.3
77VLF10701	1-1/2"	1.50	2.84	5.45	2.91	5.42	3.4
77VLF10801	2"	2.00	3.40	6.57	3.69	7.77	6.0

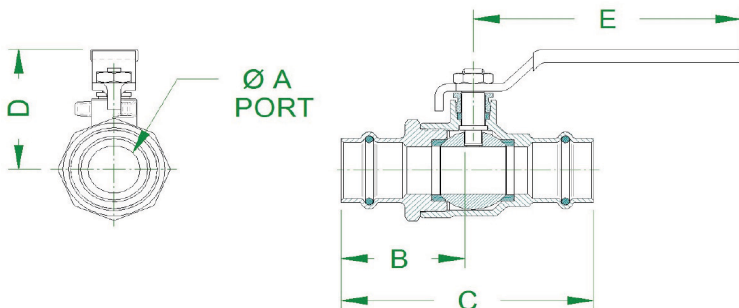

**LEAD FREE: The wetted surfaces of this product shall contain no more than 0.25% lead by weighted average. Complies with Federal Public Law 111-380. ANSI 3rd party approved and listed.*

2.01- F -DOMESTIC - GLOBE VALVE



"Apollo" PRESS



Job Name:	
Job Location:	
Engineer:	
Contractor:	
Tag:	
PO#:	
Rep:	
Wholesale Dist.:	

DESCRIPTION

The lead free* APOLLOPRESS® Model 101T-PRLF (30LF Series) Gate Valve with press connectors is a proven combination that provides economical installation and reliable service for potable water applications. These valves are cast, machined, assembled, and tested in South Carolina using proven ASTM quality materials.

FEATURES

- ANSI 3rd Party Certified Lead Free*
- Fast, Reliable, Economical Press Installation
- Ridgid® XL Press Tool Compatible
- Leak Before Press® Technology
- Full Port Flow
- Guided Solid Lead Free* Bronze Disc
- Adjustable Graphite Stem Packing
- Rising Stem
- Screw-in Bonnet
- Rugged Malleable Iron Hand Wheel
- Back seat protection
- Made in USA, ARRA Compliant

PERFORMANCE RATING

- Cold Working Pressure:
200 psi (13.8 Bar) at 100°F
- Temperature Range: -0°F to °F

APOLLOPRESS® connectors are designed for direct mechanical connection to ASTM B88-Type K, L, and M copper tubing in the hard drawn condition. Press connectors are not suitable for steam or flammable gas service.

STANDARD MATERIALS LIST

BODY	ASTM B584-C89836 Bronze
BONNET	ASTM B584-C89836 Bronze
CONNECTOR HOUSING	UNS C27451 Brass C27451
CONNECTOR O-RING	NSF grade EPDM
STEM	ASTM B371 C69400 Bronze
DISC	ASTM B584-C89836 Bronze
PACKING NUT	ASTM B16 Brass
PACKING	Grafoil
HAND WHEEL	Malleable Iron
NAMEPLATE	Aluminum

APPROVALS

- MSS SP-80 Design and Testing
- MSS SP-139 Copper Alloy Gate, Globe, & Check Valves
- NSF/ANSI 61 Water Quality
- NSF/ANSI 372 Lead Free
- CRN OC14667.5

DIMENSIONS

MODEL NO.	PART NO.	SIZE (IN.)	HEIGHT OPEN (IN.)	LENGTH (IN.)	WEIGHT (LB.)	CV (GPM)
101T12-PRLF	30LF-003-01PR	1/2"	4.85	3.9	1.3	12.5
101T34-PRLF	30LF-004-01PR	3/4"	5.71	4.3	1.8	24.0
101T1-PRLF	30LF-005-01PR	1"	6.71	4.7	2.6	72.3
101T14-PRLF	30LF-006-01PR	1-1/4"	8.1	5.13	3.8	80.0
101T12-PRLF	30LF-007-01PR	1-1/2"	9.08	6.12	5.4	119.0
101T2-PRLF	30LF-008-01PR	2"	11.28	6.70	8.5	338.0

**Cv = flowrate at 1.0 psid

*LEAD FREE: The wetted surfaces of this product shall contain no more than 0.25% lead by weighted average. Complies with Federal Public Law 111-380. ANSI 3rd party approved and listed.

2.01 - F - DOMESTIC WATER SWING CHECK



"Apollo" PRESS



Job Name:	
Job Location:	
Engineer:	
Contractor:	
Tag:	
PO#:	
Rep:	
Wholesale Dist.:	

DESCRIPTION

The lead free* **APOLLOPRESS® Model 163T-PRLF (Series 61YLF) Swing Check** with press connections is a proven combination that provides economical installation and reliable service for potable water applications. These valves are cast, machined, assembled, and tested in South Carolina using proven ASTM quality materials.

FEATURES

- Fast, Reliable, Economical Press Installation
- Ridgid® XL Press Tool Compatible
- Leak Before Press® Technology
- Quick Press End Connection
- Renewable PTFE Seat Disc
- Dezincification Resistant
- **Made in USA, ARRA Compliant**

APPROVALS

- MSS SP-80 Design and Testing
- MSS SP-139 Copper Alloy Gate, Globe, & Check Valves
- NSF/ANSI 61 Water Quality
- NSF/ANSI 372 Lead Free
- CRN OC14667.5

PERFORMANCE RATING

- Maximum Pressure: 200 psi (13.8 bar) non-shock
- Temperature Range: 0°F - 250°F (-18°C - 121°C)

APOLLOPRESS® connectors are designed for direct mechanical connection to ASTM B88-Type K, L, and M copper tubing in the hard drawn condition. Press connectors are not suitable for steam or flammable gas service.

Not recommended for applications which may induce pulsation or repetitive vibration. See Installation Manual for details.

STANDARD MATERIALS LIST

BODY	ASTM B584 C89836 Bronze
CAP	ASTM B584 C89836 Bronze
CONNECTOR HOUSING	UNS C27450 Brass
CONNECTOR O-RING	NSF grade EPDM
HANGER	304 Stainless Steel or ASTM B584 C89836 Bronze
PIN	Stainless Steel
SEAT	PTFE
PLUG	UNS C27450 Brass

DIMENSIONS

MODEL NO.	PART NO.	SIZE (IN.)	HEIGHT (IN.)	LENGTH (IN.)	CV (GPM)	WEIGHT (LB.)
163T12-PRLF	61YLF-203-TIPR	1/2"	1.65	4.3	7.0	.78
163T34-PRLF	61YLF-204-TIPR	3/4"	1.9	5.1	12.0	1.8
163T1-PRLF	61YLF-205-TIPR	1"	2.26	5.9	28.6	2.5
163T114-PRLF	61YLF-206-TIPR	1-1/4"	2.99	7.0	39.0	4.4
163T112-PRLF	61YLF-207-TIPR	1-1/2"	2.99	7.75	56.0	4.5
163T2-PRLF	61YLF-208-TIPR	2"	3.74	8.9	152.0	7.0

For liquids the flow coefficient - Cv - expresses the flow capacity in gallons per minute (GPM) of 60°F water with a pressure drop of 1 psi (lb/in²).

*LEAD FREE: The wetted surfaces of this product shall contain no more than 0.25% lead by weighted average. Complies with Federal Public Law 111-380. ANSI 3rd party approved and listed.

2.01- D & E - COMPRESSED AIR VALVES - BRONZE BALL VALVES



70LF-100 Series Bronze Ball Valve - NPT

Job Name:	Contractor:
Job Location:	P.O. Number:
Engineer:	Representative:
Tag:	Wholesale Distributor:

DESCRIPTION

The Apollo® 70LF Series has the same rugged features as the industry standard 70 Series valves with the added advantage of **Lead Free*** materials. The 70LF is ideal for plumbing and heating systems, including potable water. Trusted Apollo® performance with a wide range of popular options.

FEATURES

- **Lead Free*** Brass & Bronze Materials
- ANSI/NSF 61 Section 8 2008 180°F
- Easily Identifiable Blue **"Lead Free"** Hang Tag
- RPTFE Seats and Stuffing Box Ring
- Designed, Manufactured, and 100% Factory Tested in the USA

PERFORMANCE RATING

- Maximum Pressure: 600 psig CWP 150 psig SWP
- Maximum Temperature: 450°F
- Vacuum Service to 29 in. Hg

MODELS

- ☒ 70LF-100 Series Standard
☐ 70LF-140 Series 316 SS Ball & Stem

STANDARD MATERIALS LIST

Part Name	Material
Lever and Grip	Steel, Zinc Plated w/ Vinyl Grip
Stem Packing	RPTFE
Stem Bearing	RPTFE
Ball	C27450 Lead Free* Brass, Cr Plated
Seat (2)	RPTFE
Retainer	C27450 Lead Free* Brass (1/4" to 1") C89836 Lead Free* Bronze (1-1/4" to 4")
Gland Nut	B16 Brass
Stem	C27450 Lead Free* Brass
Lever Nut	Steel, Zinc Plated
Body	C89836 Lead Free* Bronze

APPROVALS

- MSS SP-110; Ball Valves Threaded, Socket-Welding, Solder Joint, Grooved and Flared Ends
- ANSI/NSF 61-8 2008 180°F (Mechanical Devices)
- ANSI 3rd Party Approval to AB 1953 0.25% Lead Max.
- CRN: OC10908.5C

* **LEAD FREE:** The wetted surfaces of this product shall contain no more than 0.25% lead by weighted average. Complies with CA AB1953, VT Act 193, MD HB372, LA HB471 and Federal Public Law 111-380. ANSI 3rd party approved and listed



DIMENSIONS

Part #	Size (in.)	Dimensions					Wt. (lb.)
		A	B	C	D	E	
70LF10101	1/4"	0.37	1.03	2.06	1.75	3.87	0.60
70LF10201	3/8"	0.37	1.03	2.06	1.75	3.87	0.56
70LF10301	1/2"	0.50	1.12	2.25	1.75	3.87	0.63
70LF10401	3/4"	0.68	1.50	3.00	2.12	4.87	1.39
70LF10501	1"	0.87	1.68	3.37	2.25	4.87	1.72
70LF10601	1-1/4"	1.00	2.00	4.00	2.62	5.50	3.26
70LF10701	1-1/2"	1.25	2.18	4.37	3.06	8.00	4.61
70LF10801	2"	1.50	2.34	4.68	3.25	8.00	6.06
70LF10901	2-1/2"	2.00	3.12	6.25	3.72	8.00	13.96
70LF10001	3"	2.50	3.37	6.75	4.12	8.00	18.60
70LF10A01	4"	3.12	3.68	7.37	5.25	10.00	25.50

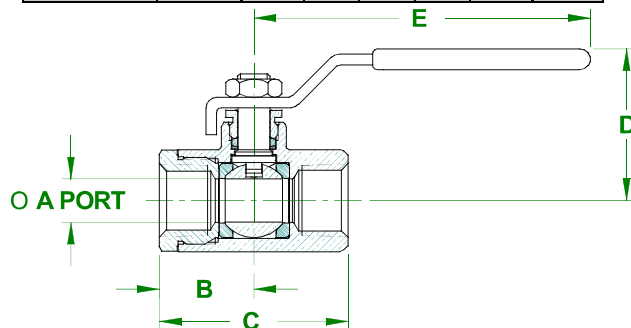

OPTIONS

- | | |
|---|-----------|
| <input type="checkbox"/> (-04) 2 1/4" CS Stem Extension | 1/4" - 3" |
| <input type="checkbox"/> (-07) Steel Tee Handle | 1/4" - 2" |
| <input type="checkbox"/> (-10) SS Lever & Nut | 1/4" - 3" |
| <input type="checkbox"/> (-11) Thermo-Seal™ Insulating Tee Handle | 1/4" - 2" |
| <input type="checkbox"/> (-27) SS Latch-Lock Lever & Nut | 1/2" - 4" |
| <input type="checkbox"/> (-32) SS Tee Handle & Nut | 1/2" - 2" |
| <input type="checkbox"/> (-47) SS Oval Latch-Lock Handle & Nut | 1/2" - 1" |
| <input type="checkbox"/> (-92) Balancing Stop | 1/4" - 3" |
| <input type="checkbox"/> (-94) -04 option & Balancing Stop | 3/8" - 3" |

Conbraco Industries, Inc. 701 Matthews Mint Hill Rd. Matthews NC 28106 USA; www.apollovalves.com ; 704-841-6000

This specification is provided for reference only. Conbraco reserves the right to change any portion of this specification without notice and without incurring obligation to make such changes to Conbraco products previously or subsequently sold.